

1295

1296

INSTRUCTION MANUAL

This instruction manual applies to machines from the following serial numbers onwards:

2 730 099 →



This Instruction Manual is valid for all models and subclasses listed in the chapter "**Specifications**".



The adjustment manual for the machines can be downloaded free of charge from the internet address

www.pfaff-industrial.com/pfaff/de/service/downloads

As an alternative to the internet download the adjustment manual can also be ordered in book form under part no. **296-12-18 640/002**.

The reprinting, copying or translation of PFAFF Instruction Manuals, whether in whole or in part, is only permitted with our previous authorization and with written reference to the source.

**PFAFF Industriesysteme
und Maschinen AG**

Hans-Geiger-Str. 12 - IG Nord
D-67661 Kaiserslautern

Contents		Chapter - Page
1	Safety	1 - 1
1.01	Regulations	1 - 1
1.02	General notes on safety	1 - 1
1.03	Safety symbols	1 - 2
1.04	Important notes for the user	1 - 2
1.05	Notes for operating and technical staff	1 - 3
1.05.01	Operating staff	1 - 3
1.05.02	Technical staff	1 - 3
1.06	Danger warnings	1 - 4
2	Proper use	2 - 1
3	Specifications	3 - 1
3.01	PFAFF 1295, PFAFF 1296	3 - 1
3.02	Possible versions and subclasses	3 - 2
3.03	Maximum speeds of the PFAFF 1295	3 - 2
3.04	Maximum speeds of the PFAFF 1296	3 - 2
4	Disposal of the machine	4 - 1
5	Transportation, packing and storage	5 - 1
5.01	Transportation to the customer's premises	5 - 1
5.02	Transportation inside the customer's premises	5 - 1
5.03	Disposal of packing materials	5 - 1
5.04	Storage	5 - 1
6	Explanation of symbols	6 - 1
7	Controls	7 - 1
7.01	On/off switch	7 - 1
7.02	Pedal (on machines without subclass -917/97)	7 - 1
7.03	Pedal (on machines with subclass -917/97)	7 - 2
7.04	Knee lever (on machines without subclass -911/97)	7 - 2
7.05	Key on machine head (on machines with subclass -911/97)	7 - 3
7.06	Presser bar lifter	7 - 3
7.07	Feed regulator/reverse sewing	7 - 4
7.08	Feed regulator (on machines with subclass -911/97)	7 - 4
7.09	Adjusting nut for the top feed stroke	7 - 5
7.10	Control panel	7 - 5
8	Installation and commissioning	8 - 1
8.01	Installation	8 - 1
8.01.01	Adjusting the table-top height	8 - 1
8.01.02	Assembling the motor (only on machines with Quick-motor)	8 - 2
8.01.03	Tightening the V-belt	8 - 2
8.01.04	Mounting the bottom V-belt guard	8 - 3

Contents

	Contents	Chapter - Page
8.01.05	Fitting the upper belt guard	8 - 4
8.01.06	Fitting the synchronizer	8 - 4
8.01.08	Fitting the reel stand	8 - 5
8.01.07	Fitting the tilt lock	8 - 5
8.02	Connecting the plug-in connections and earth cables	8 - 6
8.03	Commissioning	8 - 7
8.04	Switching the machine on/off	8 - 7
8.05	Basic position of the machine drive unit	8 - 7
9	Setting up	9 - 1
9.01	Inserting the needle on the PFAFF 1295	9 - 1
9.02	Inserting the needle on the PFAFF 1296	9 - 2
9.03	Winding the bobbin thread, regulating the winder tension	9 - 3
9.04	Changing the bobbin	9 - 4
9.05	Threading the bobbin thread and regulating the bobbin thread tension	9 - 4
9.06	Threading needle thread/adjusting needle thread tension on the PFAFF 1295	9 - 5
9.07	Threading needle thread/adjusting needle thread tension on the PFAFF 1296	9 - 6
9.08	Adjusting the stitch counter for the bobbin thread control	9 - 7
10	Care and maintenance	10 - 1
10.01	Cleaning	10 - 1
10.02	General oiling	10 - 2
10.03	Oiling the sewing hook	10 - 3
10.04	Oiling the needle-head parts	10 - 4
10.05	Lubricating the top-feed drive eccentric	10 - 4
10.06	Checking/regulating the air pressure	10 - 5
10.07	Emptying/cleaning the water bowl of the air filter/regulator	10 - 5
10.08	Parameter settings	10 - 6
10.08.01	Parameter list	10 - 6
11	Mounting the table top and Circuit diagrams	11 - 1
11.01	Table top cutout	11 - 1
11.02	Mounting the table top	11 - 2
11.03	Circuit diagrams	11 - 3
12	Wearing parts	12 - 1

1 Safety

1.01 Regulations

This machine has been made according to the European regulations indicated in the conformity and manufacturer's declarations.

In addition to this instruction manual, please also observe all generally accepted statutory and other legal requirements, including those of the user's country, and the valid pollution control regulations!

The locally valid regulations of the social insurance institution responsible for occupational accidents, or other supervisory authorities, must be strictly adhered to!

1.02 General notes on safety

- The machine must only be operated when the instruction manual has been fully read and understood, and only by operators who have had the necessary training!
- All notes on safety and the instruction manual of the motor manufacturer must be read before the machine is put into operation!
- All notices on the machine referring to danger and safety must be observed!
- The machine must be used for the purpose it is intended for and must not be operated without its safety devices; all regulations relevant to safety must be adhered to.
- When part sets are changed (e.g. needle, presser foot and needle plate), during threading, when the workplace is left unattended and during maintenance work, the machine must be isolated from the power supply by pressing the on/off switch or removing the plug from the mains!
- Daily maintenance work must only be carried out by appropriately trained persons!
- Repairs and special maintenance work must only be carried out by qualified technical staff or persons with the appropriate training! Exceptions to this are only allowed for adjustment and function checks by appropriately trained personnel!
- Repair work and special maintenance work must only be carried out by technical personnel or by persons with the appropriate training!
- Work on the electrical equipment must only be carried out by technical staff who are qualified to do so!
- Work on parts or equipment connected to the power supply is not permitted! The only exceptions to this are specified in regulations EN 50110.
- Conversion or modification of the machine must only be carried out under observation of all relevant safety regulations!
- Only spare parts which have been approved by us are to be used for repairs! We draw special attention to the fact that spare parts and accessories not supplied by us have not been subjected to testing nor approval by us. Fitting and/or use of any such parts may cause negative changes to the design properties of the machine. We shall not accept any liability for damage caused by the use of non-original parts.

1.03

Safety symbols



Danger!
Special points to observe.



Danger of injury to operating or technical staff!



Caution

Do not operate without finger guard and safety devices.
Before threading, changing bobbin and needle, cleaning
etc. **switch off main switch.**

1.04

Important notes for the user

- This instruction manual is part of the equipment of the machine and must be available to the operating staff at all times.
- The instruction manual must be read before the machine is operated for the first time.
- Both operating and technical staff must be instructed on the safety devices of the machine and on safe working methods.
- It is the duty of the user to operate the machine in perfect running order only.
- The user must ensure that none of the safety devices are removed nor put out of working order.
- The user must ensure that only authorized persons operate and work on the machine.

For further information please refer to your PFAFF agency.

1.05 Notes for operating and technical staff

1.05.01 Operating staff

Operating staff are the persons responsible for setting up, operating and cleaning the machine and for removing any disturbances in the sewing area.

The operating staff are obliged to observe the following points, and must:

- always observe the notes on safety in this instruction manual!
- avoid using any working methods which adversely effect the safety of the machine!
- avoid wearing loose-fitting clothing or jewelry such as necklaces or rings!
- also ensure that only authorized persons are allowed near the danger area of the machine!
- immediately report to the user any changes to the machine that may affect its safety!

1.05.02 Technical staff

Technical staff are persons who have been trained in electrical engineering, electronics, pneumatics and mechanical engineering. They are responsible for lubricating, servicing, repairing and adjusting the machine.

The technical staff are obliged to observe the following points, and must:

- always observe the notes on safety in this instruction manual!
- switch off the on/off switch before carrying out adjustment and repair work and ensure it cannot be switched on again unintentionally!
- never work on parts or equipment still connected to the power supply! Exceptions to this are only permissible according to regulations EN 50110;
- isolate the machine from the compressed air supply when carrying out maintenance or repair work on pneumatic equipment!
Exceptions to this are only permissible for function checks;
- replace all safety covers after carrying out maintenance or repair work!

1.06

Danger warnings



A working area of 1 m must be kept free both in front of and behind the machine, so that easy access is possible at all times.



Never put your hands or fingers in the sewing area during sewing!
Danger of injury by the needle!



While setting or adjusting the machine do not leave any objects on the table nor in the needle plate area! Objects may be trapped or flung out of the machine!



When a mechanically operated clutch motor without actuation lock is switched off, always wait until the motor has stopped! Danger of injury!

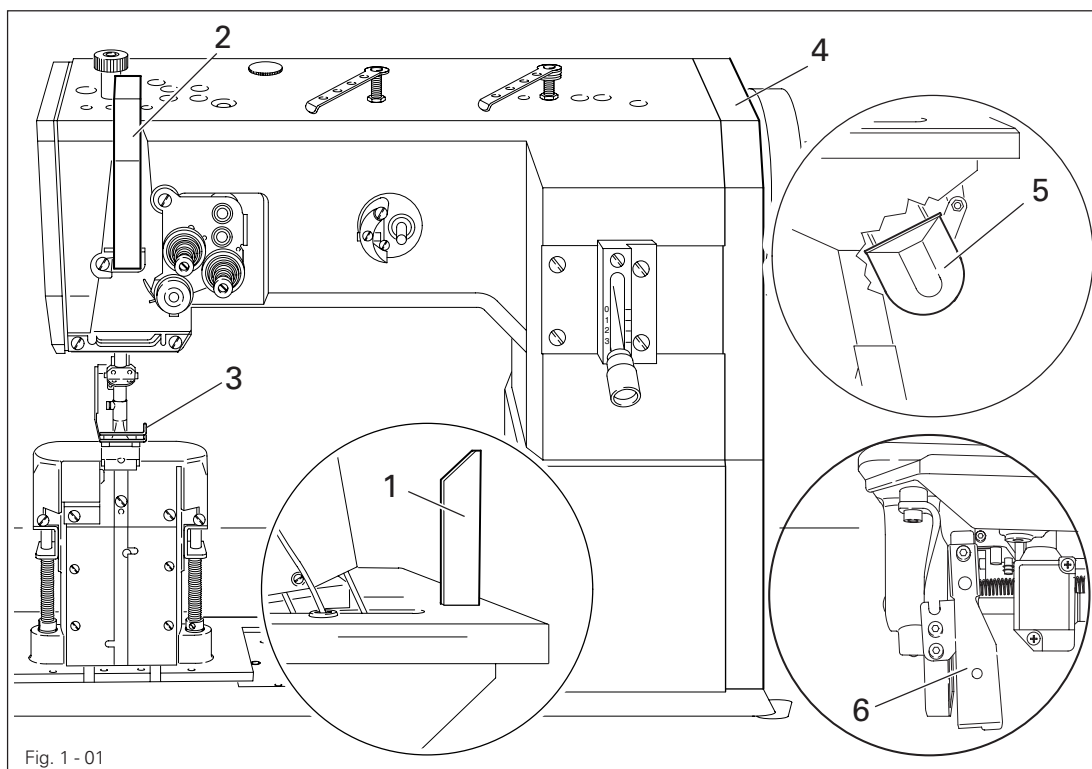

Fig. 1 - 01



Do not run the machine without support 1.
Danger due to top-heavy sewing head!
Machine may tip over backwards when tilted!



Do not run the machine without take-up lever guard 2!
Danger of injury by moving take-up lever!



Do not run the machine without finger guard 3!
Danger of injury by up and down movement of needle!



Do not run the machine without belt guards 4 and 5!
Danger of injury by rotating v-belt!



Do not operate the machine without tilt lock 6!
Danger of crushing between sewing head and table!

2

Proper use

The **PFAFF 1295** is a single-needle lockstitch postbed sewing machine with unison feed and large vertical sewing hook.

The **PFAFF 1296** is a two-needle lockstitch postbed sewing machine with unison feed and large vertical sewing hooks.

These machines are for sewing lockstitch seams in the textile industry.



Any use of this machine which is not approved by the manufacturer shall be considered as improper use! The manufacturer shall not be held liable for any damage arising out of improper use! Proper use shall also be considered to include compliance with the operation, adjustment, service and repair measures specified by the manufacturer!

Specifications

3 Specifications

3.01 PFAFF 1295, PFAFF 1296 ♦

Stitch type: 301 (lockstitch)
Needle system 134 - 35
Needle size in 1/100 mm: 110 - 140

Max. thread size (synthetic▲): 20/3

Max. stitch length:
Version CN : 6,0 mm
Version CN 11 : 11,0 mm

Effective dia. of balance wheel: 90 mm

Dimensions of the machine:
Length: approx. 530 mm
Breadth: approx. 177 mm
Height (above table): approx. 440 mm

Clear workspace length: 265 mm
Clear workspace height: 115 mm
Fabric clearance (with presser foot raised): 14 mm
Postbed height: 165 mm

Net weight (sewing head): 55 kg

Motor data: see motor specification plate
Working pressure: 6 bar
Air consumption: ~0,8 l litres/work cycle

Noise data:
Emission sound level at the workplace at appropriate speed
(Noise measurement in accordance with DIN 45 635-48-A-1, ISO 11204, ISO 3744, ISO 4871)
PFAFF 1295, model C at a speed of 1600 spm.: $L_{pA} = 77 \text{ dB(A)}$ ■
PFAFF 1296, model C at a speed of 1500 spm.: $L_{pA} = 76 \text{ dB(A)}$ ■

- ♦ Subject to technical alterations
- ▲ Or comparable sizes of other thread types
- $K_{pA} = 2,5 \text{ dB}$

3.02 Possible versions and subclasses

Version CN; CN 11 : For sewing medium-heavy materials

Work aids:

Subclass -900/56 Thread trimmer

Subclass -911/97 Automatic presser foot lift with backtacking system

3.03 Maximum speeds of the PFAFF 1295

Top feed stroke	Version	Max. speed (s.p.m.)
Up 5,5 mm	CN	1900
over 5,5 mm to 7 mm	CN	1800
up 5,5 mm	CN 11	1000
over 5,5 mm bto 7 mm	CN 11	800

3.04 Maximum speeds of the PFAFF 1296

Top feed stroke	Needle gauge	Version	Max. speed (s.p.m.)
Up 5,5 mm	up 10 mm	CN	1800
	from 10,4 mm	CN	1600
over 5,5 mm	up 10 mm	CN	1600
	from 10,4 mm	CN	1400

4 Disposal of Machine

- Proper disposal of the machine is the responsibility of the customer.
- The materials used for the machine are steel, aluminium, brass and various plastic materials.
The electrical equipment comprises plastic materials and copper.
- The machine is to be disposed of according to the locally valid pollution control regulations; if necessary, a specialist is to be commissioned.



Care must be taken that parts soiled with lubricants are disposed of separately according to the locally valid pollution control regulations!

5 Transportation, packing and storage

5.01 Transportation to customer's premises

The machines are delivered completely packed.

5.02 Transportation inside the customer's premises

The manufacturer cannot be made liable for transportation inside the customer's premises nor to other operating locations. It must be ensured that the machines are only transported in an upright position.

5.03 Disposal of packing materials

The packing materials of this machine comprise paper, cardboard and VCE fibre. Proper disposal of the packing material is the responsibility of the customer.

5.04 Storage

If the machine is not in use, it can be stored as it is for a period of up to six months, but it should be protected against dust and moisture.

If the machine is stored for longer periods, the individual parts, especially the surfaces of moving parts, must be protected against corrosion, e.g. by a film of oil.

Explanation of symbols

6 Explanation of symbols

In this instruction manual, work to be carried out or important information is accentuated by symbols. These symbols have the following meanings:



Note, information



Cleaning, care



Lubrication

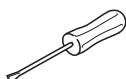

Maintenance, repairs, adjustment, service work
(only to be carried out by technical staff)

7 Controls

7.01 On/off switch

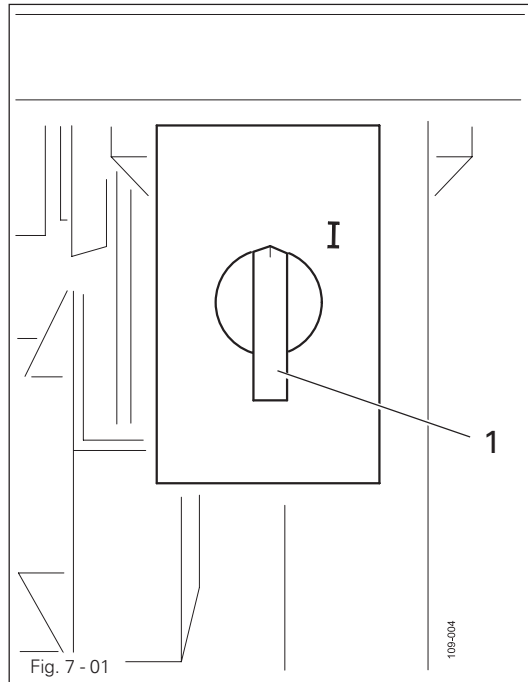

- The power supply to the machine is switched on or off by turning switch 1.



The illustrated on/off switch is fitted to machines with Quick motors. If other motors are used, a different switch may be fitted.

7.02 Pedal (on machines without subclass -911/97)

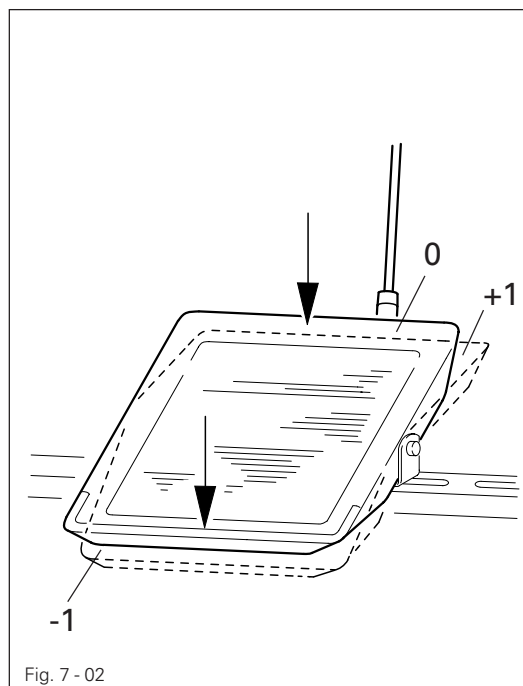

- 0 = Neutral position
- +1 = Sewing
- 1 = Thread trimming (on machines with thread trimmer)

7.03 Pedal (on machines with subclass -911/97)

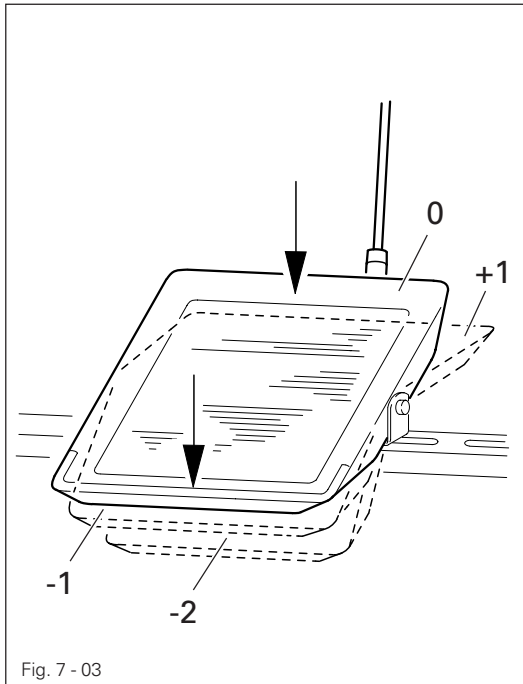

- 0 = Neutral position
- +1 = Sewing
- 1 = Raise presser foot
- 2 = Thread trimming (on machines with thread trimmer)

7.04 Knee lever (on machines without subclass -911/97)

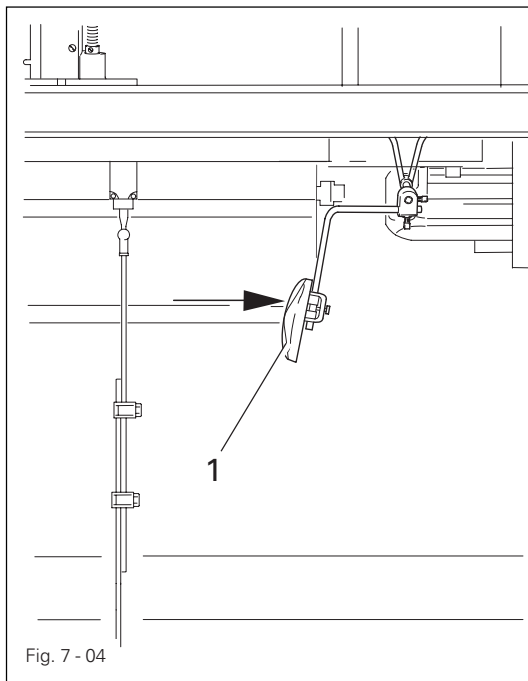

- The presser foot is raised by pressing knee lever 1.

7.05 Key on machine head (on machines with subclass -911/97)

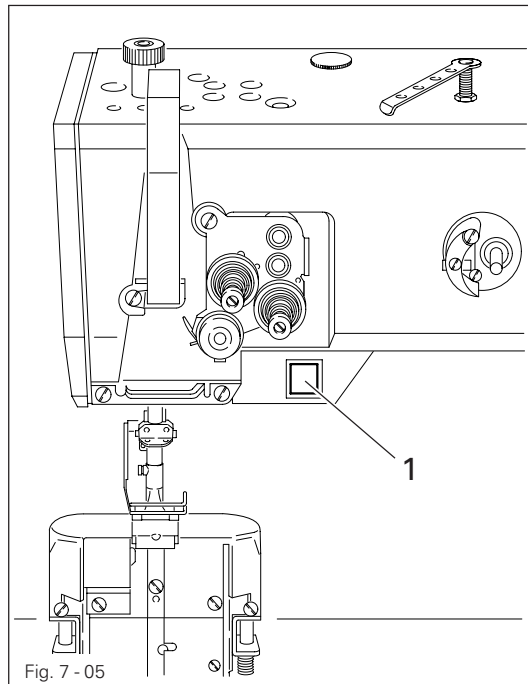

- If key 1 is pressed during sewing, the machine will switch to reverse sewing.

7.06 Presser bar lifter

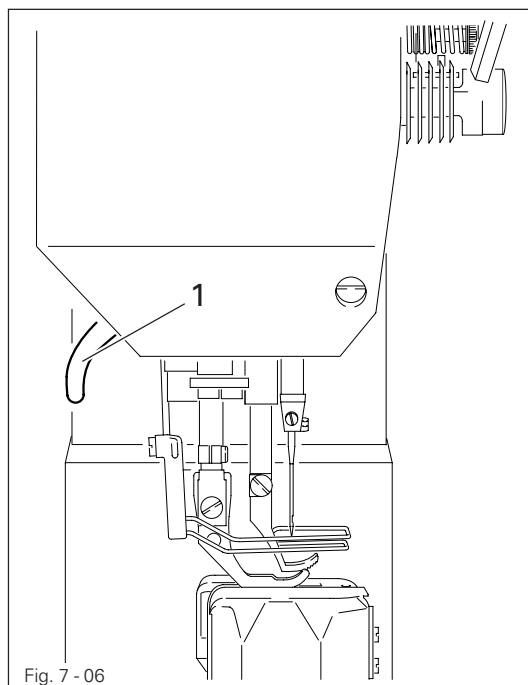

- The presser foot is lifted by raising presser bar lifter 1.

7.07 Feed regulator/reverse sewing

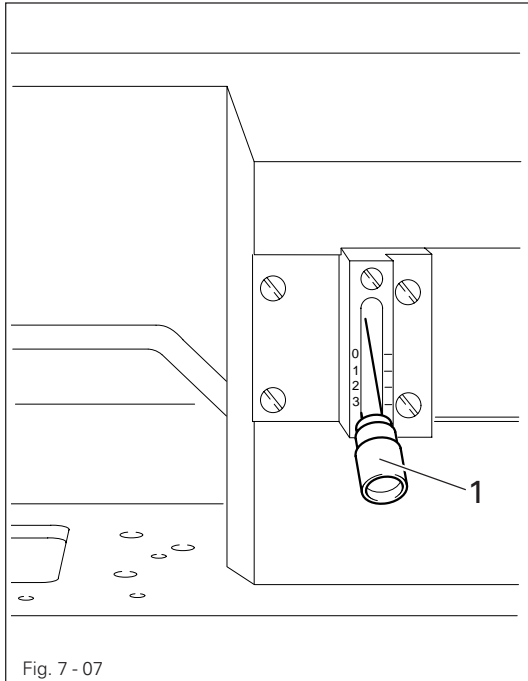

- The stitch length is adjusted by turning the knurled nut on lever 1.
- To reverse the sewing direction press lever 1 fully upwards.

7.08 Feed regulator (on machines with subclass -911/97)

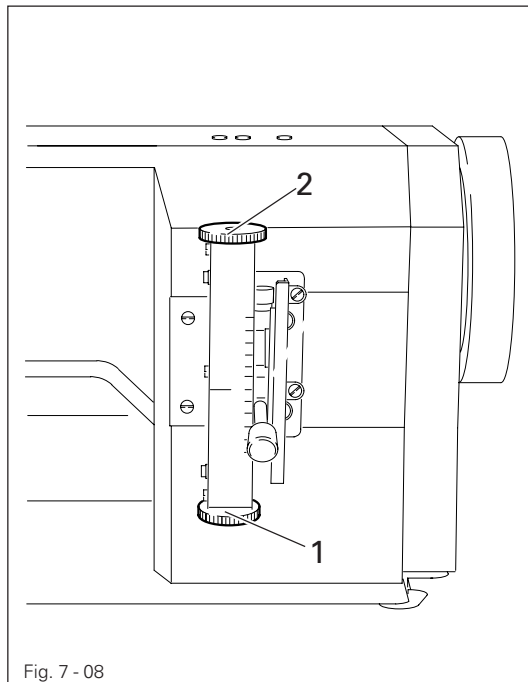

- Turn knurled screw 1 to adjust the stitch length for sewing forwards.
- Turn knurled screw 2 to adjust the stitch length for sewing backwards.

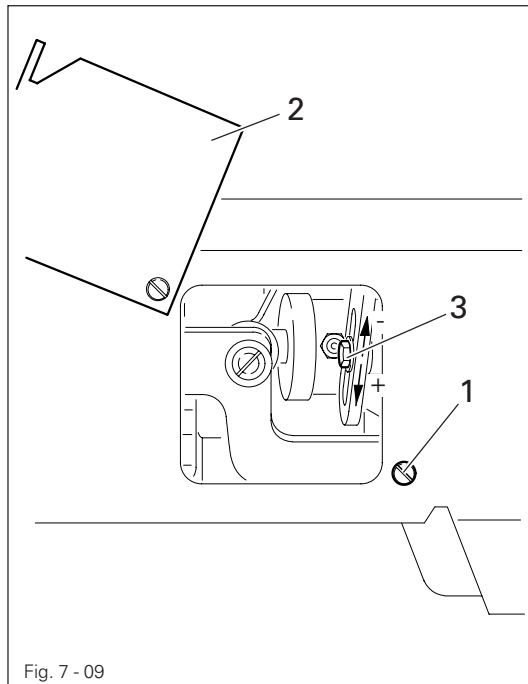

Reverse stitches can be set as long as required, independently of forward stitches.

7.09 **Adjusting nut for the top feed stroke**

Switch the machine off!
Danger due to unintentional starting of the machine!

- Loosen screw 1 at the back of the machine.
- Open cover 2.
- Loosen screw 3 and adjust lever accordingly.
- Close cover 2 and tighten screw 1.

7.10 **Control panel** (only on machines with Quick-Eco drive)

The description can be found in the separate instruction manual for the control panel.

8 Installation and commissioning



The machine must only be mounted and commissioned by qualified personnel!
All relevant safety regulations are to be observed!



If the machine is delivered without a table, it must be ensured that the frame and the table top which you intend to use can hold the weight of the machine and the motor. It must be ensured that the supporting structure is sufficiently sturdy, including during all sewing operations.

8.01 Installation

The site where the machine is installed must be provided with suitable connections for the electric current, see **Chapter 3 Specifications**.

It must also be ensured that the standing surface of the machine site is firm and horizontal, and that sufficient lighting is provided.



The method of packaging used requires that the table top be lowered for transport. The following is a description of how to adjust the height of the table top.

8.01.01 Adjusting the table-top height

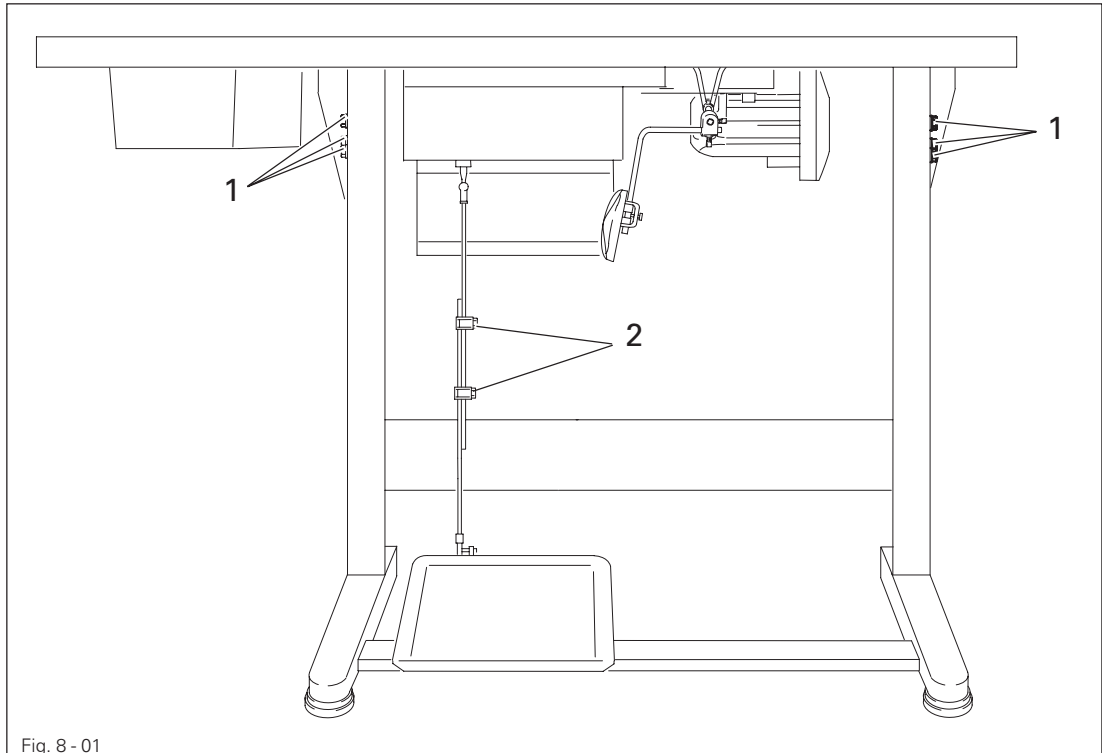

Fig. 8 - 01

- Loosen screws 1 and 2 and set the desired table-top height
- Tighten screws 1 well.
- Adjust the position of the pedal so that you can operate it comfortably and tighten screw 2.

8.01.02 Assembling the motor (only on machines with Quick-motor)

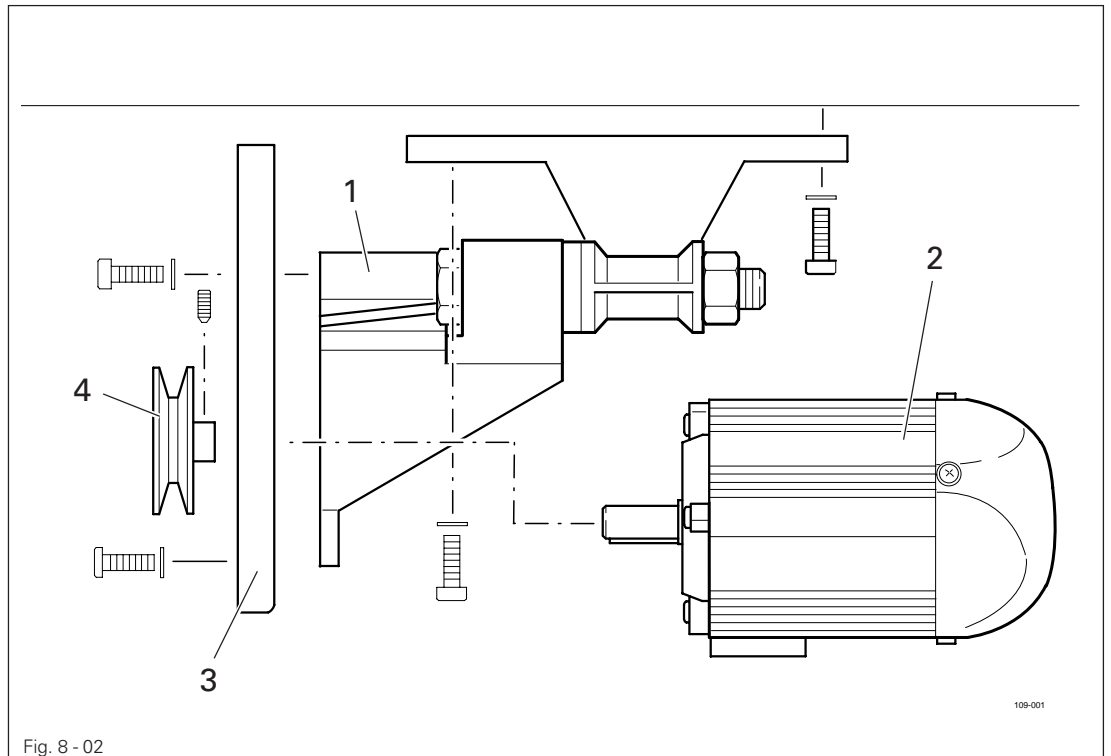

Fig. 8 - 02

- Assemble motor mounting 1, motor 2, belt guard support 3 and belt pulley 4 as shown in Fig. 8-02.

8.01.03 Tightening the V-belt

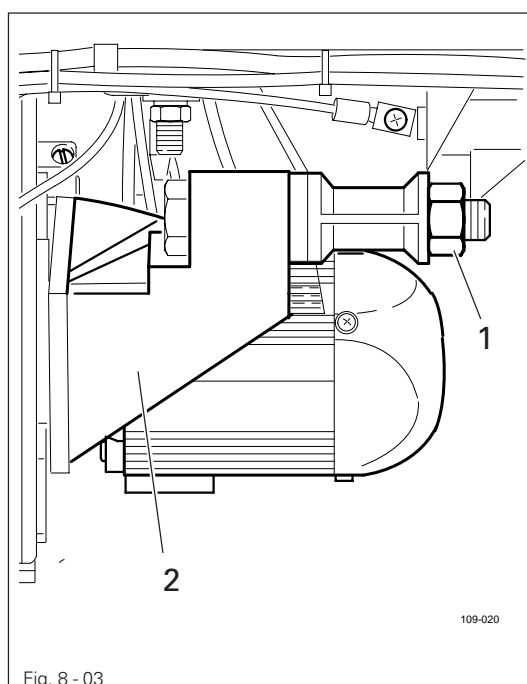
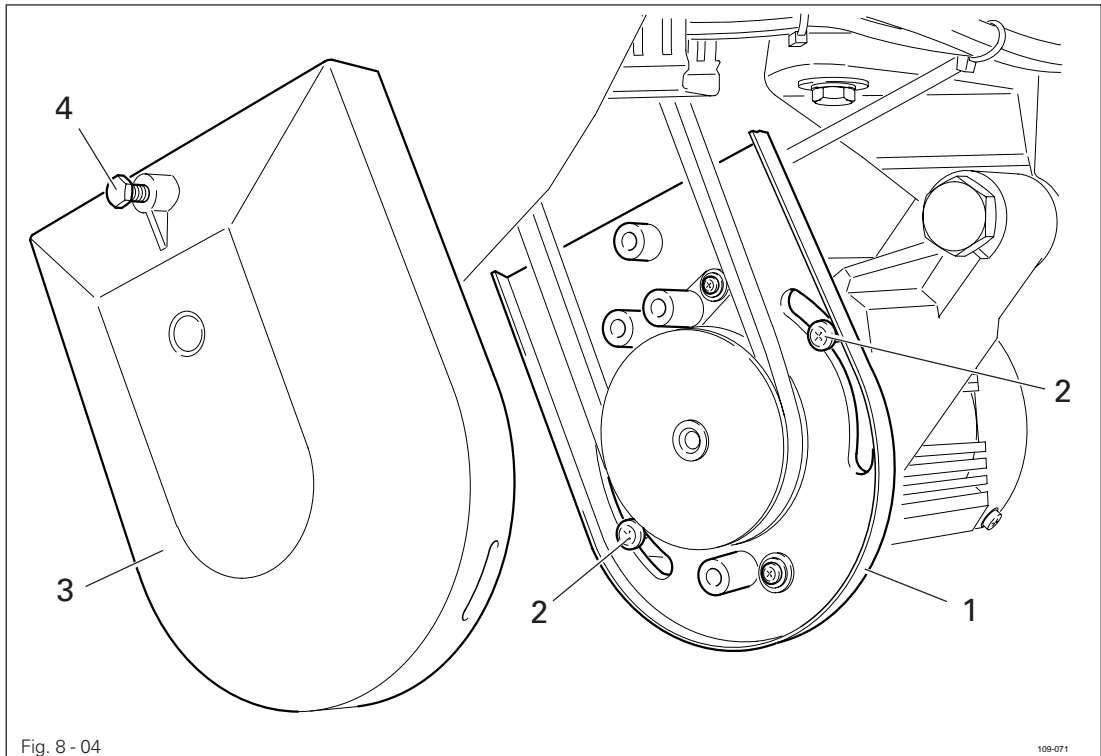

Fig. 8 - 03

- Fit the V-belt.
- Loosen nut 1 and tighten the V-belt by turning motor mounting 2.
- Tighten nut 1.

8.01.04 Mounting the bottom V-belt guard



- Loosen screws 2 and adjust belt guard support 1 so that the motor pulley and V-belt run freely.
- Tighten screws 2.
- Fasten belt guard 3 with screw 4.



Fig. 8-04 shows a Quick-motor. If a different motor is used, follow the instructions of the Motor Instruction Manual.

8.01.05 Fitting the upper belt guard

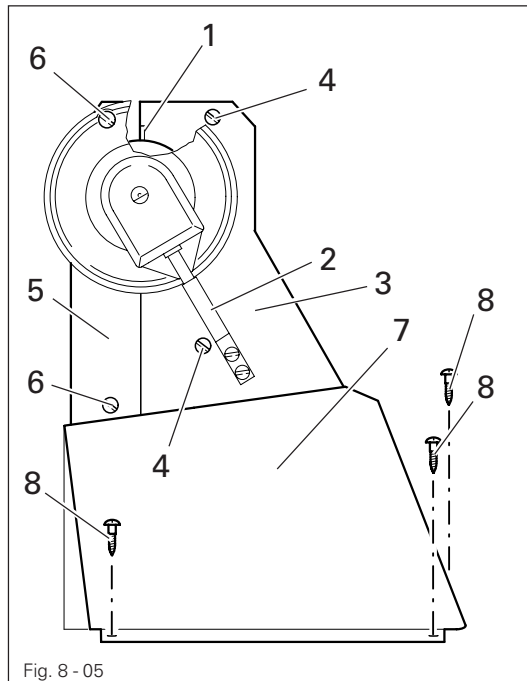

If a large balance wheel is in use, break off corner 1 of belt guard part 3.

- Screw stop piece 2 onto belt guard part 3.
- Screw on belt guard part 3 with screws 4.
- Screw on belt guard part 5 with screws 6.
- Secure belt guard part 7 to the table top using woodscrews 8.

8.01.06 Fitting the synchronizer

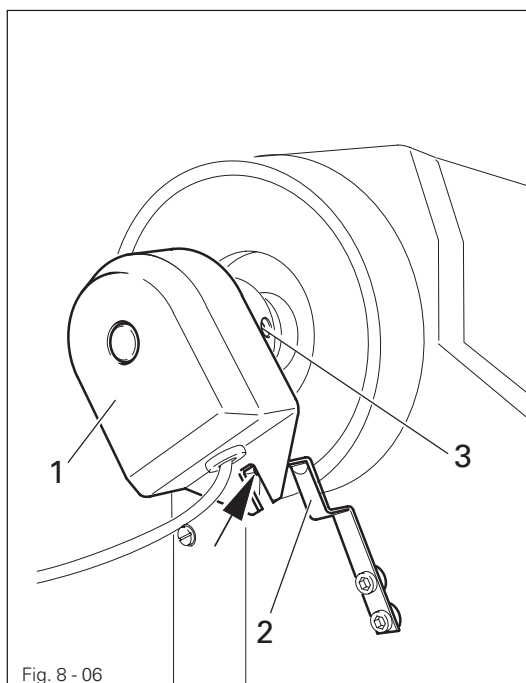

- Push synchronizer 1 onto the shaft so that stop 2 is standing in the slot on the synchronizer (see arrow)
- Tighten screws 3.
- Connect the synchronizer plug to the control box.
- Connect the synchronizer plug to the adapter (see Chapter 8.02 Connecting the plug connections and earth cables).
- Adjust the synchronizer 1, see Chapter 8.05 Basic position of the machine.

Installation and commissioning

8.01.07 Fitting the tilt lock

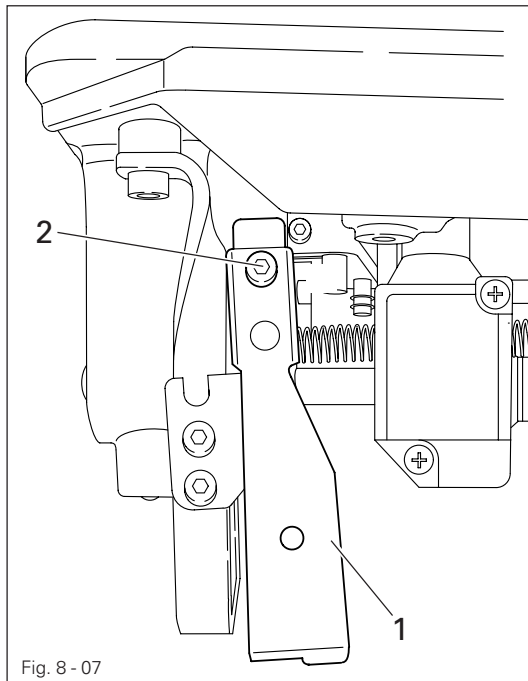

Fig. 8 - 07



Switch off the machine!
Danger of injury due to
unintentional starting of the
machine!

- Screw on tilt lock 1, provided in the accessories, using screw 2.



Do not operate the machine
without tilt lock 1!
Danger of crushing between
sewing head and table top!

8.01.08 Fitting the reel stand

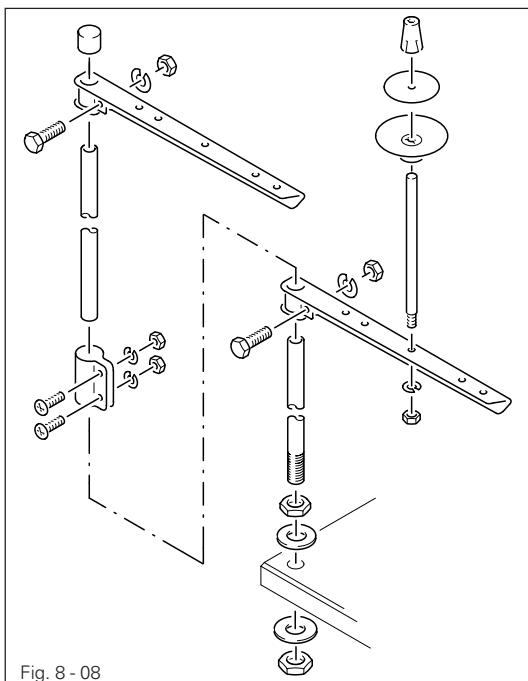

Fig. 8 - 08

- Fit the reel stand as shown in Fig. 8 - 08.
- Afterwards insert the stand in the hole in the table top and secure it with nuts provided.



Table top mounting and circuit diagrams
(see Chapter 11)

8.02 Connecting the plug-in connections and earth cables

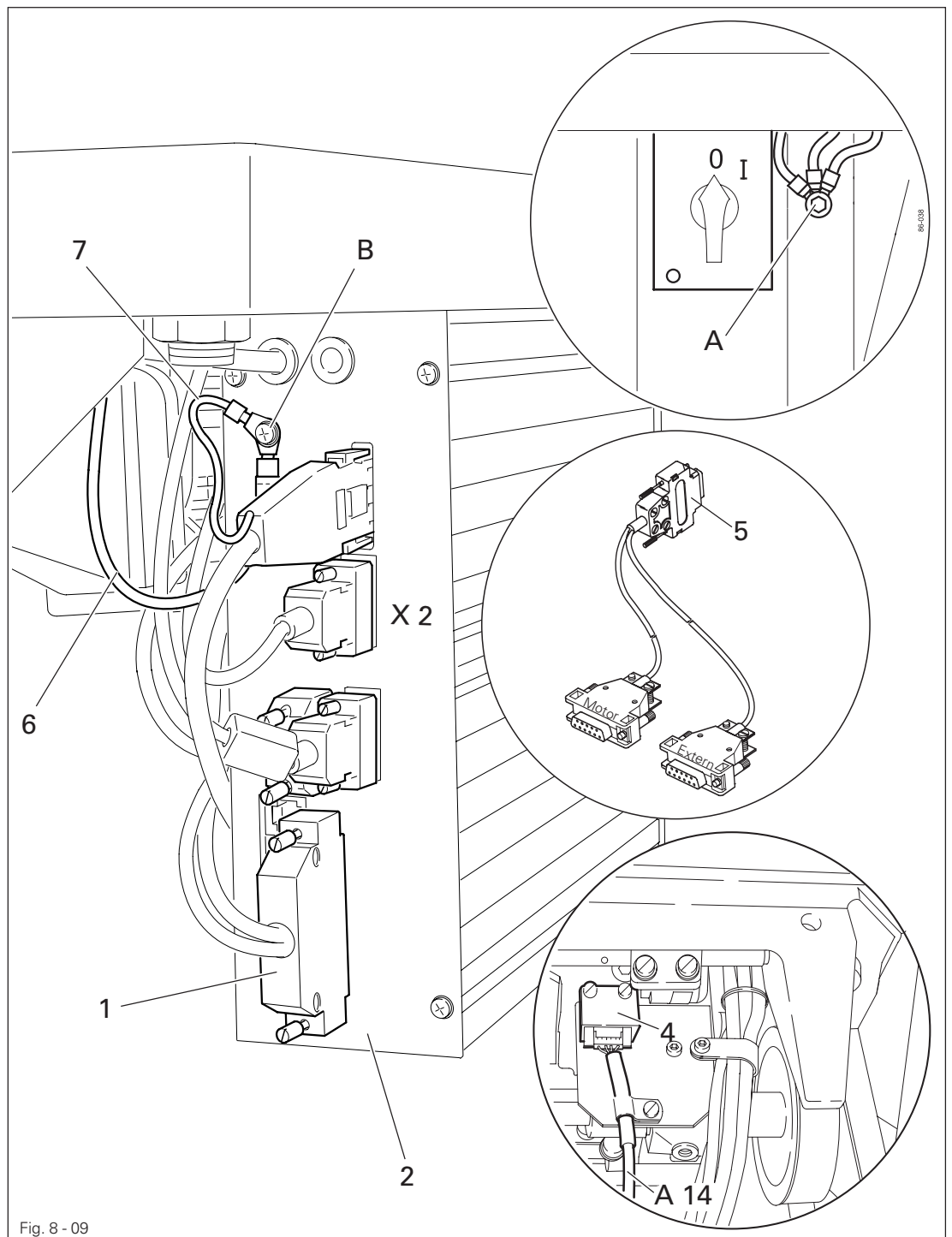

Fig. 8 - 09

- Plug adapter cable 1 into control box 2.
- Plug the cable coming from the machine to adapter cable 1 as marked.
- Plug the cable **A14** coming from adapter 1 to the sewing head recognition unit 4.
- Insert plug 5 from the adapter cable to bush X 2.
- Connect the motor to the "motor" plug and the synchronizer to the "external" plug.
- Screw the earth cable from the sewing head and the main switch to earth point A.
- Connect earth point A to earth point B with earth cable 6.
- Screw the earth cable 7 from the motor to earth point B.

8.03 Commissioning

- Clean the machine thoroughly and afterwards fill it with oil and oil the machine (see **Chapter 10, Care and maintenance**).
- Check the machine, particularly its electrical wiring and pneumatic tube connections, for any damage.
- Have skilled personnel check if the machine can be operated with the available mains voltage.



Do not operate the machine if there is any discrepancy.



Before commissioning the machine, have specialized personnel check whether the parameter **799** (machine class) is set at "2" and the parameter **800** (sewing direction) is set at "1". If necessary, have the adjustment carried out (see **Chapter 8.05 Basic position of the machine drive unit**).



The machine may only be connected to an earthed socket!

- Connect the machine to the compressed air supply. When it is connected, the gauge should show a pressure of approx. **6 bar**. If necessary, have this reading correctly set (see **Chapter 10.06, Checking/adjusting the air pressure**).

8.04 Switching the machine on/off

- Switch the machine on (see **Chapter 7.01, On/off switch**).

8.05 Basic position of the machine drive unit

(only on machines with Quick-EcoDrive and control unit P40ED)

- Switch on the machine.
- Press the TE/speed key twice to select the input mode.
- Select parameter "798" by pressing the corresponding +/- key, and select service level C, see Chapter Selecting the user level in the instruction manual for the control panel.
- By pressing the corresponding +/- key select the parameter "799" (Selecting the machine class).
- Check whether value "2" is set, and correct it if necessary.



If the parameter has to be altered, operate the **TE/Speed key** and then switch off the machine and switch it on again. Then select service level C again as described above.

- By pressing the corresponding +/- key, select parameter "800" (selecting the sewing direction).
- By pressing the corresponding +/- key, select the value for the parameter at "1".
- By pressing the corresponding +/- key, select parameter "700".
- Sew a stitch by operating the pedal.
- Turn the balance wheel in the sewing direction until the descending needle is level with the top edge of the needle plate.
- Then check the parameter values listed in the parameter list (see Chapter 10.08 Parameter Settings) and adjust them if necessary.
- Conclude the adjustment of the sewing motor by pressing the **TE/Speed key**.

9

Setting up



All instructions and regulations in this instruction manual must be observed. Special attention must be given to all safety regulations!



All setting-up work must only be done by personnel with the necessary training. For all setting-up work the machine must be isolated from its power supply by turning off the on/off switch or removing the machine plug from the electric power socket!

9.01

Inserting the needle on the bei der PFAFF 1295

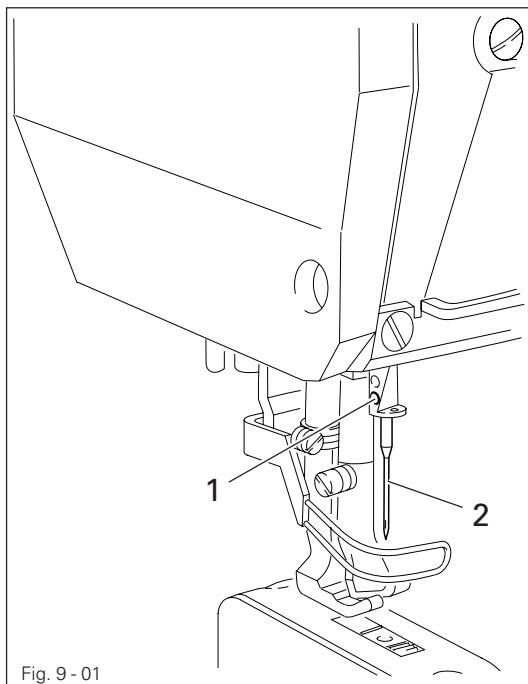

Switch the machine off!
Danger due to unintentional starting of the machine!



Only use needles from the system intended for the machine, see Chapter 3 Specifications.

- Set needle bar at top position and loosen screw 1.
- Push needle 2 fully in (the long needle groove must face to the left).
- Tighten screw 1 again.



The choice of needle depends on the version of the machine and the sewing thread and material in use (see Chapter 3, Specifications).

9.02

Inserting the needles on the PFAFF 1296

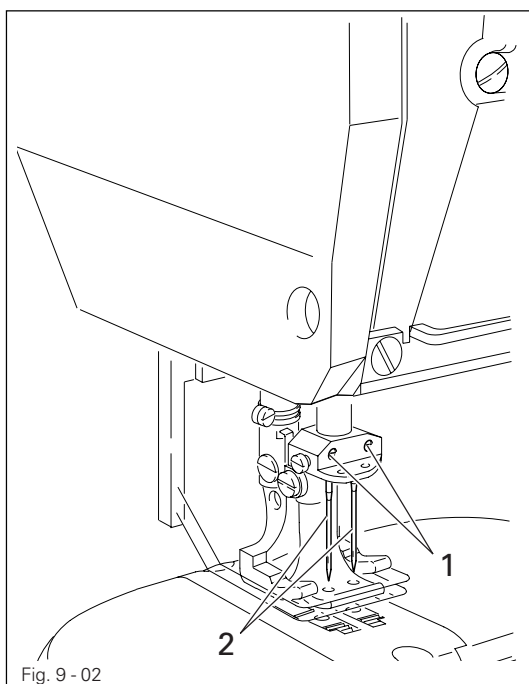

Switch the machine off!
Danger due to unintentional starting of the machine!



Only use needles from the system intended for the machine, see Chapter 3 Specifications.

- Set needle bar at top position and loosen screws 1.
- Push needles 2 fully in (the long groove of the left needle must face to the right and that of the right needle to the left).
- Tighten screws 1 again.



The choice of needle depends on the version of the machine and the sewing thread and material in use (see Chapter 3, Specifications).

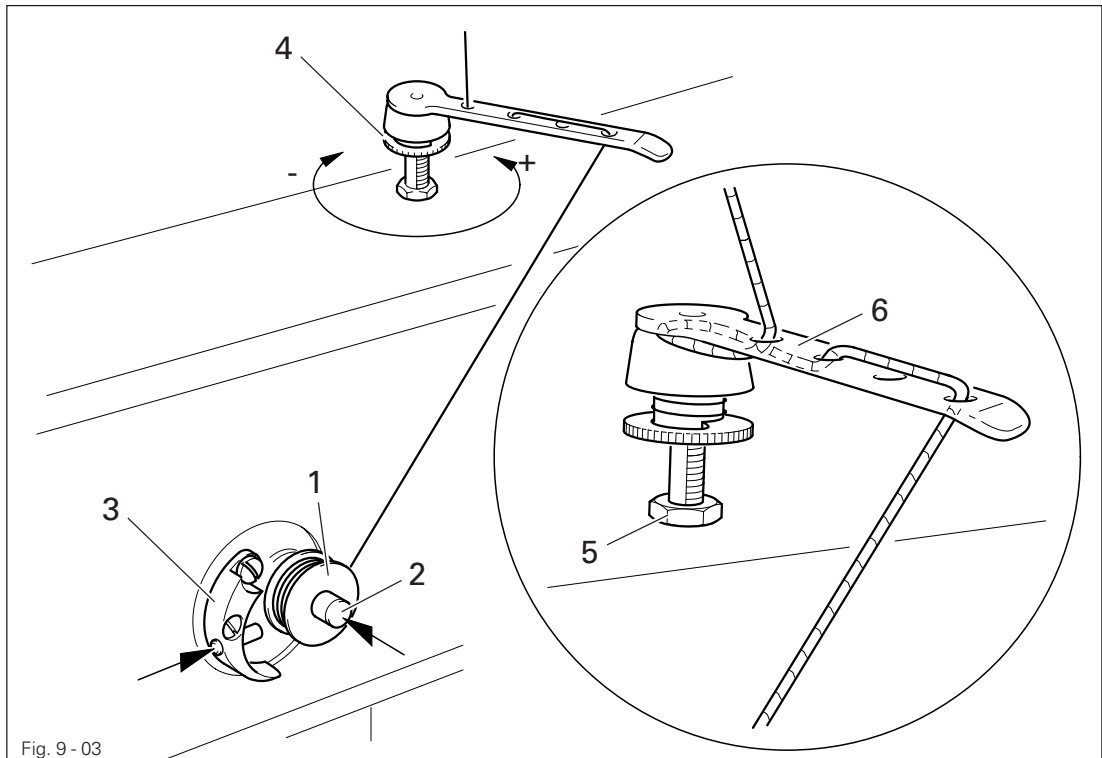

Fig. 9 - 03

- Place an empty bobbin 1 on winder spindle 1.
- Thread up as shown in Fig. 9-03 and wind the thread a few times clockwise around bobbin 1.
- Engage the bobbin winder by pressing spindle 2 and lever 3 simultaneously



The bobbin is wound during sewing.

- The bobbin winder will stop when sufficient thread is wound onto bobbin 1.

If the thread is wound on unevenly:

- Loosen nut 5.
- Turn thread guide 6 as required.
- Tighten nut 5 again.

9.04 Changing the bobbin

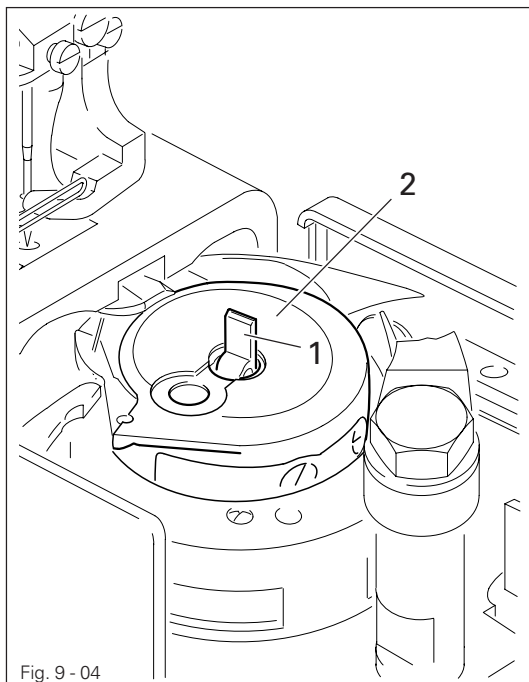

Switch the machine off!
 Danger due to unintentional starting of the machine!

Removing the bobbin case:

- Set the take-up lever at its highest point.
- Remove the post cover, lift latch 1 and take out bobbin case 2.

Inserting the bobbin case:

- Insert bobbin case 2 so that you feel it snap in place.
- Push latch 1 down and close the post cover.



Do not run the machine with the post cover open!
 Danger of injury by moving parts!

9.05 Threading the bobbin thread and regulating the bobbin thread tension

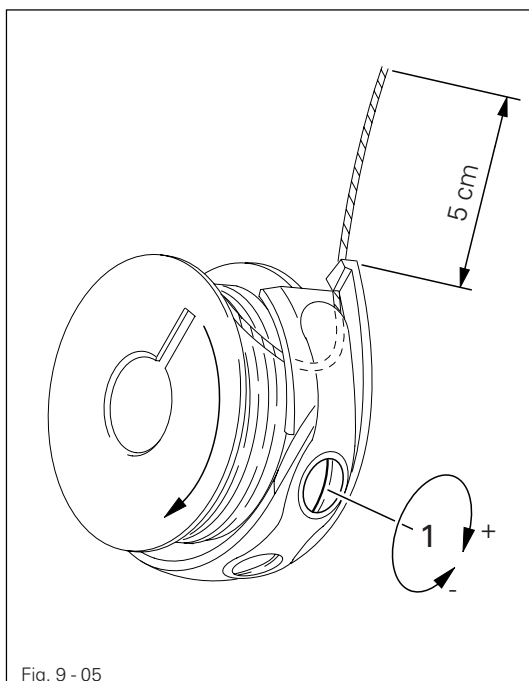

Switch off the machine!
 Danger of injury due to unintentional starting of the machine!

- Thread the bobbin as shown in Fig. 9-05.
- When the thread is pulled, the bobbin must rotate as shown by the arrow.
- Regulate the bobbin thread tension on screw 1.

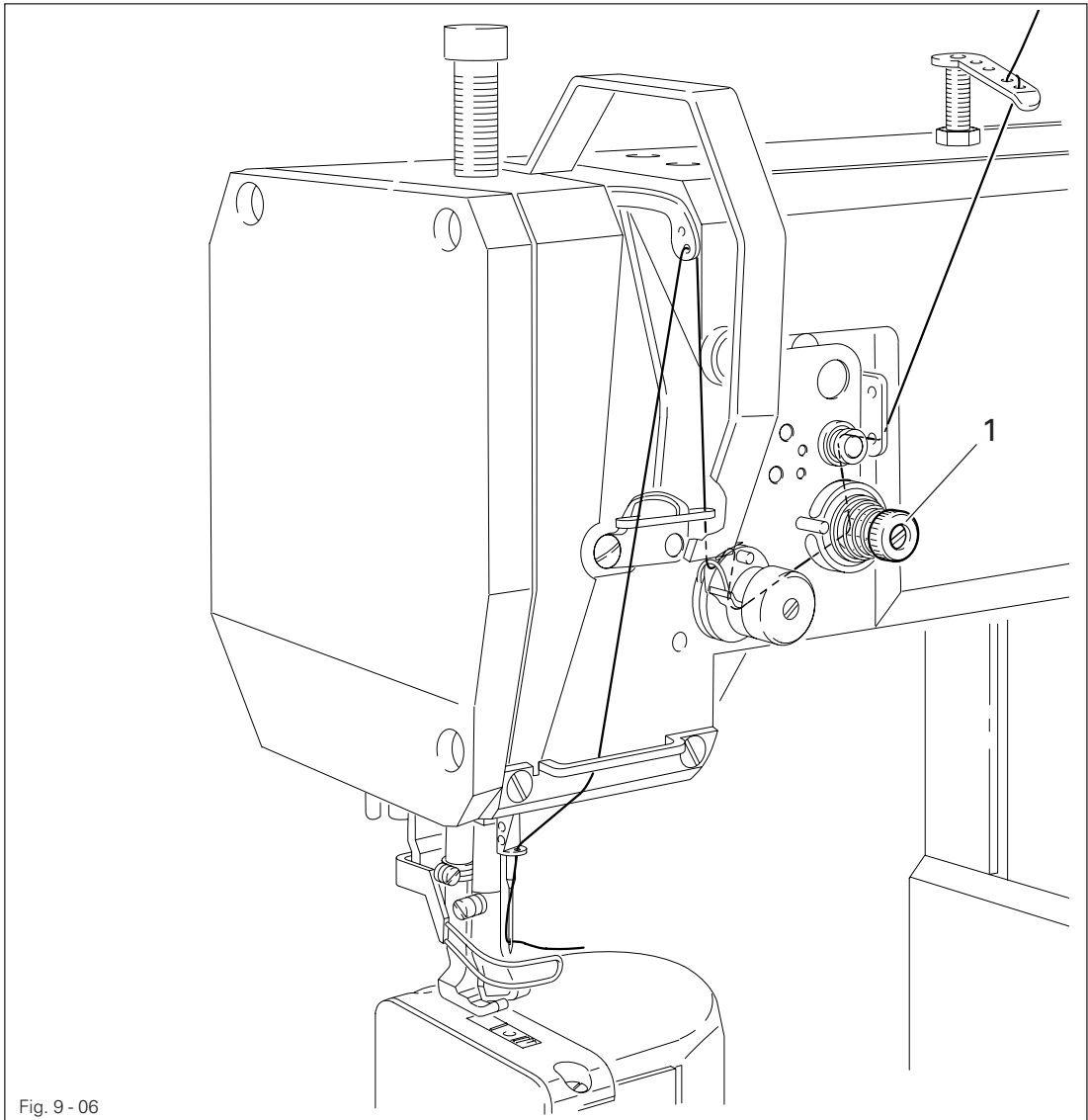

Fig. 9 - 06



Switch off the machine!

Danger of injury due to unintentional starting of the machine!

- Thread needle thread as shown in Fig. 9-06. Be sure to thread the needle from the left.
- Regulate the needle thread tension by turning knurled screw 1.

9.07

Threading needle thread/adjusting needle thread tension on the PFAFF 1296

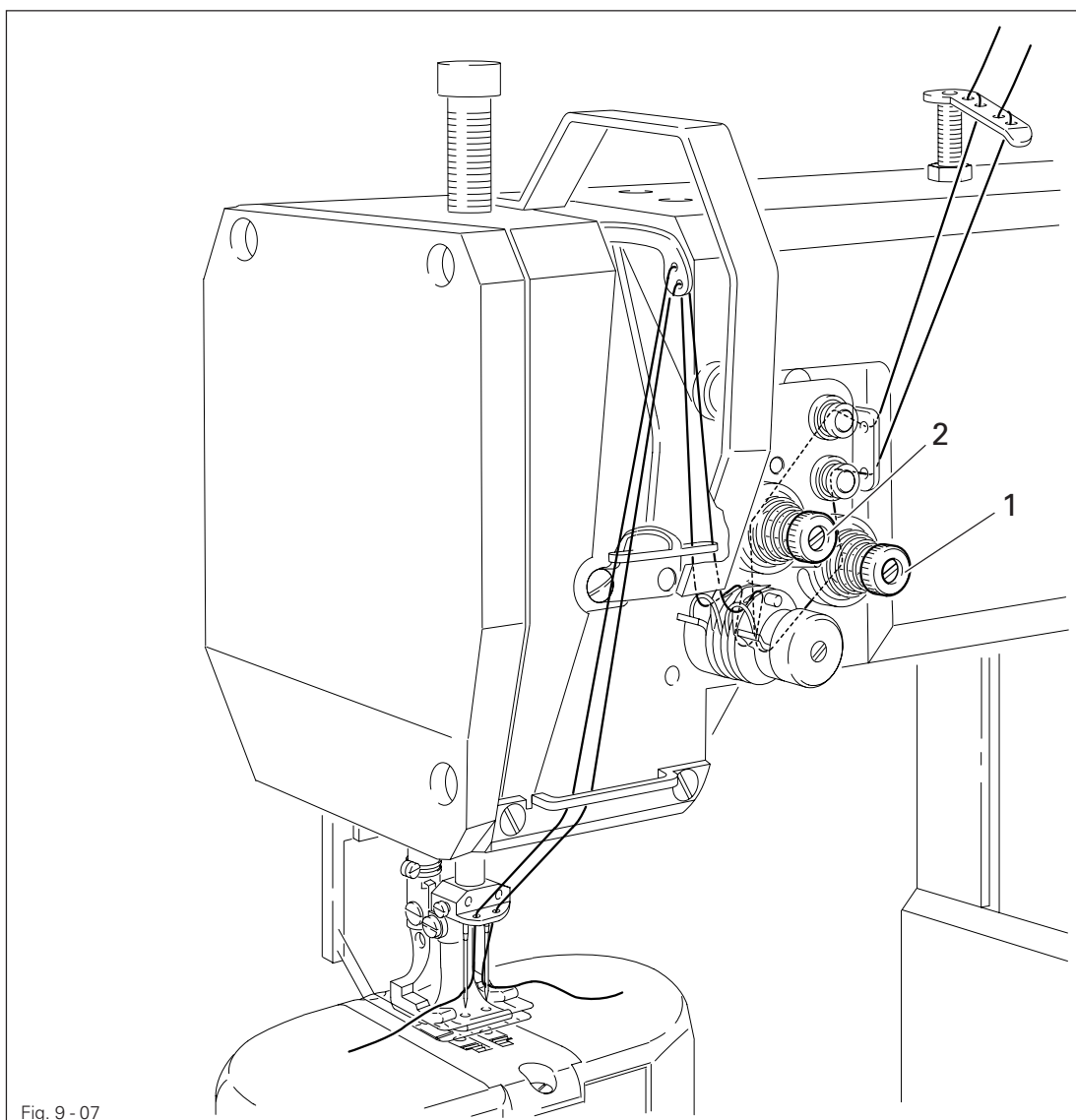

Switch off the machine!

Danger of injury due to unintentional starting of the machine!

- Thread needle threads as shown in Fig. 9-07. Be sure to thread the right needle from the left and the left needle from the right.
- Regulate the needle thread tensions by turning knurled screw 1 (right needle) or 2 (left needle).

9.08 **Adjusting the stitch counter for the bobbin thread control**
(only on machines with Quick Motor and P40 (ED) control unit)

Please see the description in the separate control panel instruction manual.

10 Care and maintenance

Check air pressure	daily, each time before operation
Clean hook area	daily, in continuous operation several times
Check water bowl of air filter/regulator	daily, before operation
Oil hook	daily
General oiling	twice a week
Oil needle-head parts	twice a week
Clean hook	once a week
Lubricate top-feed drive eccentric	once a week



The maintenance intervals in the table refer to the average machine running time in single-shift operation. If the machine running time is longer than this, it is advisable to shorten these intervals.

10.01 Cleaning

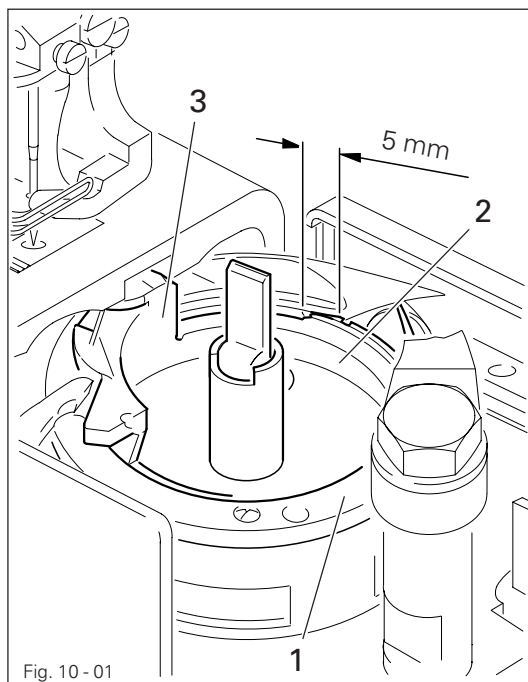

Fig. 10 - 01



Switch off the machine!
Danger of injury due to unintentional starting of the machine!

- Clean hook area with a brush daily, in continuous operation several times daily.
 - Clean the hook thoroughly once a week.
 - Open post cover.
 - Set needle bar at its highest position.
 - Remove top of bobbin case together with bobbin
 - Unscrew and remove hook gib 1.
 - Turn balance wheel until point of bobbin case 2 has entered into the groove of the hook race by about 5 mm.
 - In this position remove bobbin case 2.
 - Clean hook race with petroleum spirit.
-
- When inserting the bobbin case, make sure that bobbin case position finger 3 enters the slot in the needle plate.
 - Screw on hook gib 1.
 - Insert bobbin case and close post cover.

10.02 Ölen allgemein

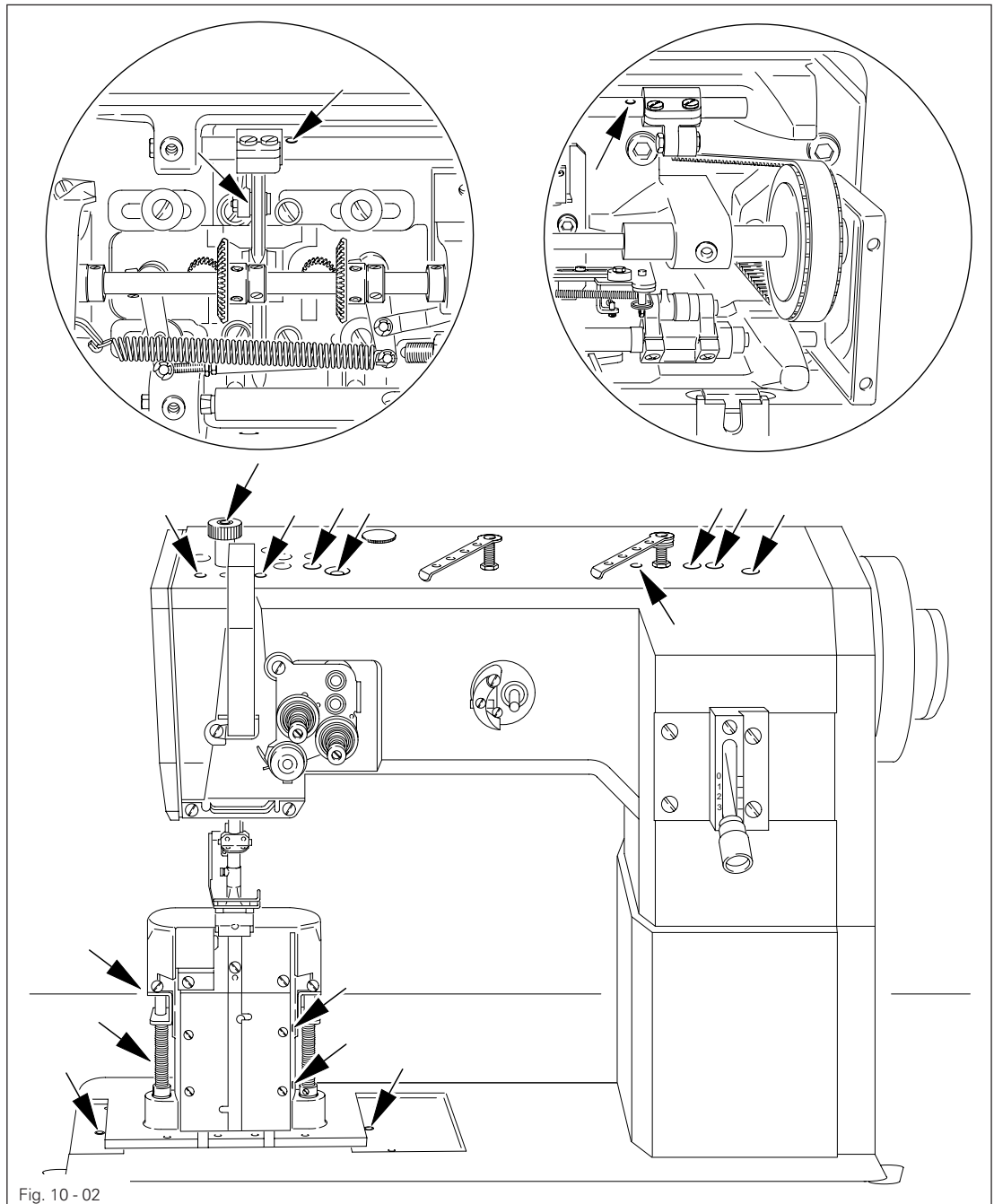

- Apply oil at all bearing points above the table (see arrows) twice a week.



Switch off the machine!
Danger of injury due to unintentional starting of the machine!

- Pull knee lever out to the front and tilt machine backwards.
- Apply oil at all bearing points beneath the table (see arrows) twice a week.



Set the machine upright with both hands! Danger of crushing between sewing head and table!



Only use oil with a medium viscosity of 22.0 mm²/s at 40° C and a density of 0.865 g/cm³ at 15°C!

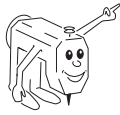

We recommend PFAFF sewing-machine oil, part No. 280-1-120 144.

10.03 Oiling the sewing hook

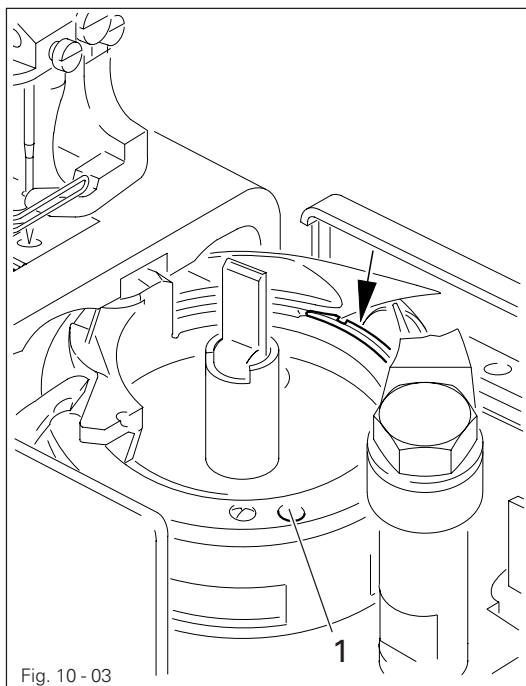

Switch off the machine!
Danger of injury due to unintentional starting of the machine!

- Open the post cover.
- Set the needle bar at its highest position.
- Apply **1 or 2 drops** of oil in hole **1** of the hook gib.
- Apply a few drops of oil to the hook race (see arrow)



Only use oil with a medium viscosity of 22.0 mm²/s at 40° C and a density of 0.865 g/cm³ at 15°C!



We recommend PFAFF sewing-machine oil, part No. 280-1-120144.

10.04 Oiling the needle-head parts

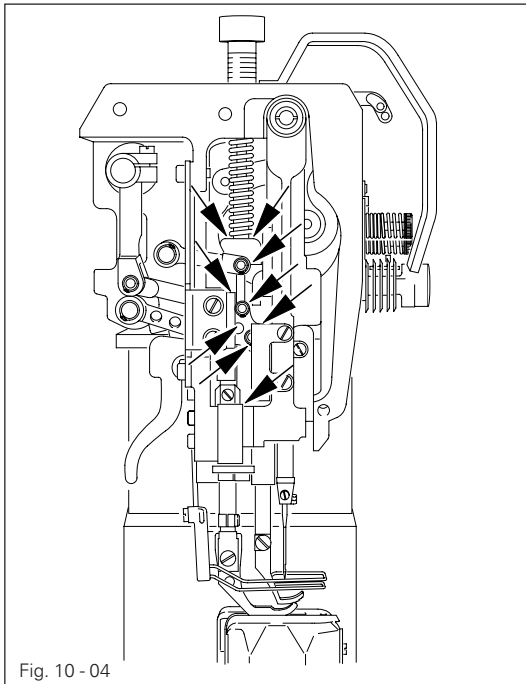

Switch off the machine!
Danger of injury due to unintentional starting of the machine!

- Remove the faceplate.
- Oil all moving parts and bearing points (see arrows) twice a week.
- Refit the faceplate.



Only use oil with a medium viscosity of 22.0 mm²/s at 40° C and a density of 0.865 g/cm³ at 15°C!

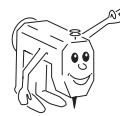

We recommend PFAFF sewing-machine oil, part No. 280-1-120144.

10.05 Lubricating the top-feed drive eccentric

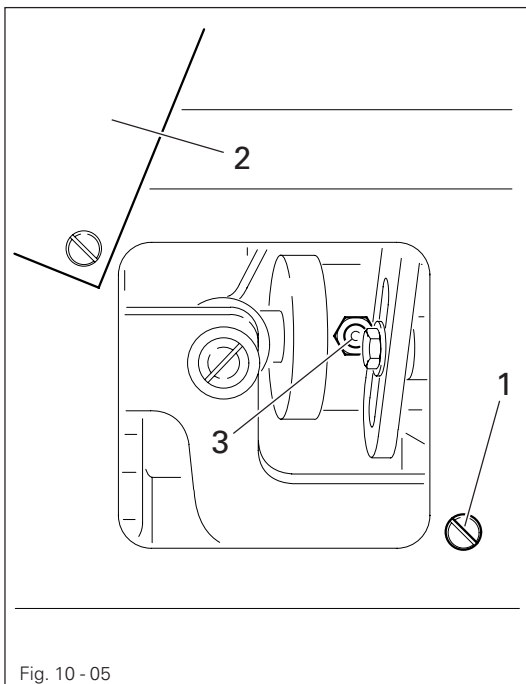

Switch off the machine!
Danger of injury due to unintentional starting of the machine!

- Loosen screw 1 and open cover 2 on the rear side of the machine.
- Apply a little grease at nipple 3 at least once a year.
- Close cover 2 and tighten screw 1.



Only use lithium grease with a dripping point of 185°C and a roll-penetration of 22 to 25 mm at 25°C.

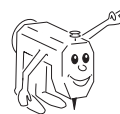

We recommend PFAFF sewing machine grease, part No. 280-1-120247.

10.06 Checking/regulating the air pressure

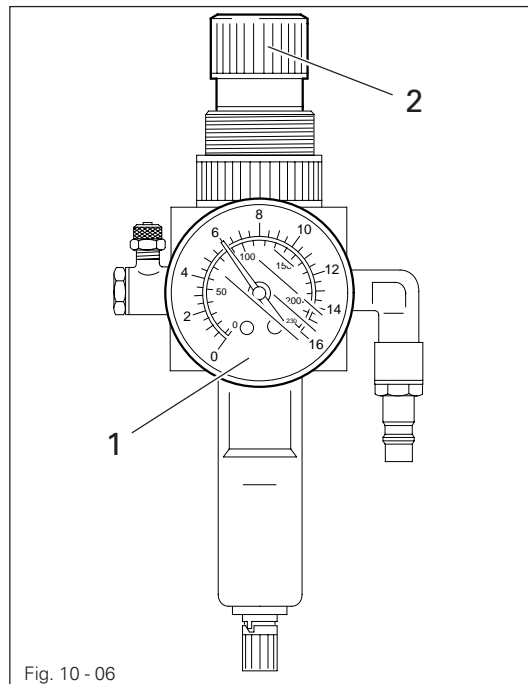

Fig. 10 - 06

- Check the air pressure on gauge 1 every time before operation.
- Gauge 1 must show a pressure of **6 bar**.
- Regulate this pressure if required. To do so, pull knob 2 up and turn it accordingly.

10.07 Emptying/cleaning the water bowl of the air filter/regulator

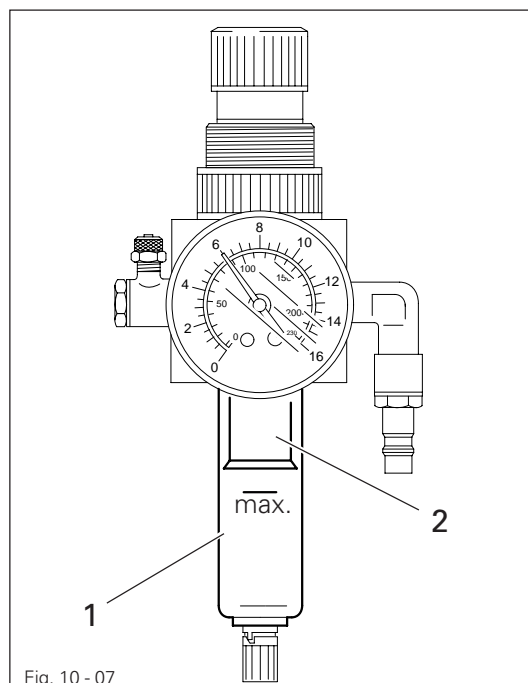

Fig. 10 - 07



Switch off the machine.
Disconnect the air hose at the air filter/regulating unit.

Emptying the water bowl

- Water bowl 1 empties itself automatically when the air hose is disconnected from the air filter/regulator.

Cleaning the filter

- Unscrew water bowl 1 and take out filter 2.
- Clean the filter with compressed air or with isopropyl-alcohol, part number 95-665735-91.
- Screw in filter 2 and screw on water bowl 1.

10.08 Parameter settings

(only on machines with Quick-EcoDrive and control unit P40ED)

- The selection of the user level and the alteration of parameters is described in the separate instruction manual for the drive unit.

10.08.01 Parameter list

Group	Parameter	Description	User level	Setting range	Set value
1	105	Speed for start backtack	B, C	300 - 2000	600
	110	Speed for end backtack	B, C	300 - 2000	800
6	607	Speed max.	B, C	300 - 6000	▲
	609	Cutting speed 1	B, C	60 - 300	180
7	700	Needle position 0 (needle reference position)	B, C	0 - 255	*
	702	Needle position 1 (needle lowered)	B, C	0 - 255	80
	703	Needle position 2 (take-up lever raised)	B, C	0 - 255	225
	705	Needle position 5 (end cutting signal 1)	B, C	0 - 255	100
	706	Needle position 5 (start cutting signal 2)	B, C	0 - 255	80
	707	Needle position 9 (start thread tension release/start thread catcher)	B, C	0 - 255	195
	722	Acceleration ramp	B,C	1 - 60	45
	723	Brake ramp	B,C	1 - 60	40
	734	Tact output A2 (thread trimming)	B,C	001 - 009	0
	760	Multiplier for the fixed value (200) for stitch count	A, B, C	0 - 250	5
799	Selected machine class	C	1 - 4	2	

▲ See Chapter 3 Specifications

* Adjustment see Chapter 8.05 Basic position of the machine drive unit .

Group	Parameter	Description	User lever	Setting range	Set value	
8	800	Rotating direction of the motor	C	0 - 1	1	
	884	Proportional sensitivity of the speed control unit	B,C	03 - 24	12	
		1295		B,C	03 - 24	12
		1296		B,C	03 - 24	16
897	Variant mini-motor, 1 = long, 2 = short	C	0 - 1	1		
9	900	Additional P- sensitivity of the speed control unit	B,C	1 - 24	10	



Further parameters and the description for an internet update of the machine software and reset /cold start of the machine can be found in the instruction manual for the control panel.

11.02 Mounting the table top

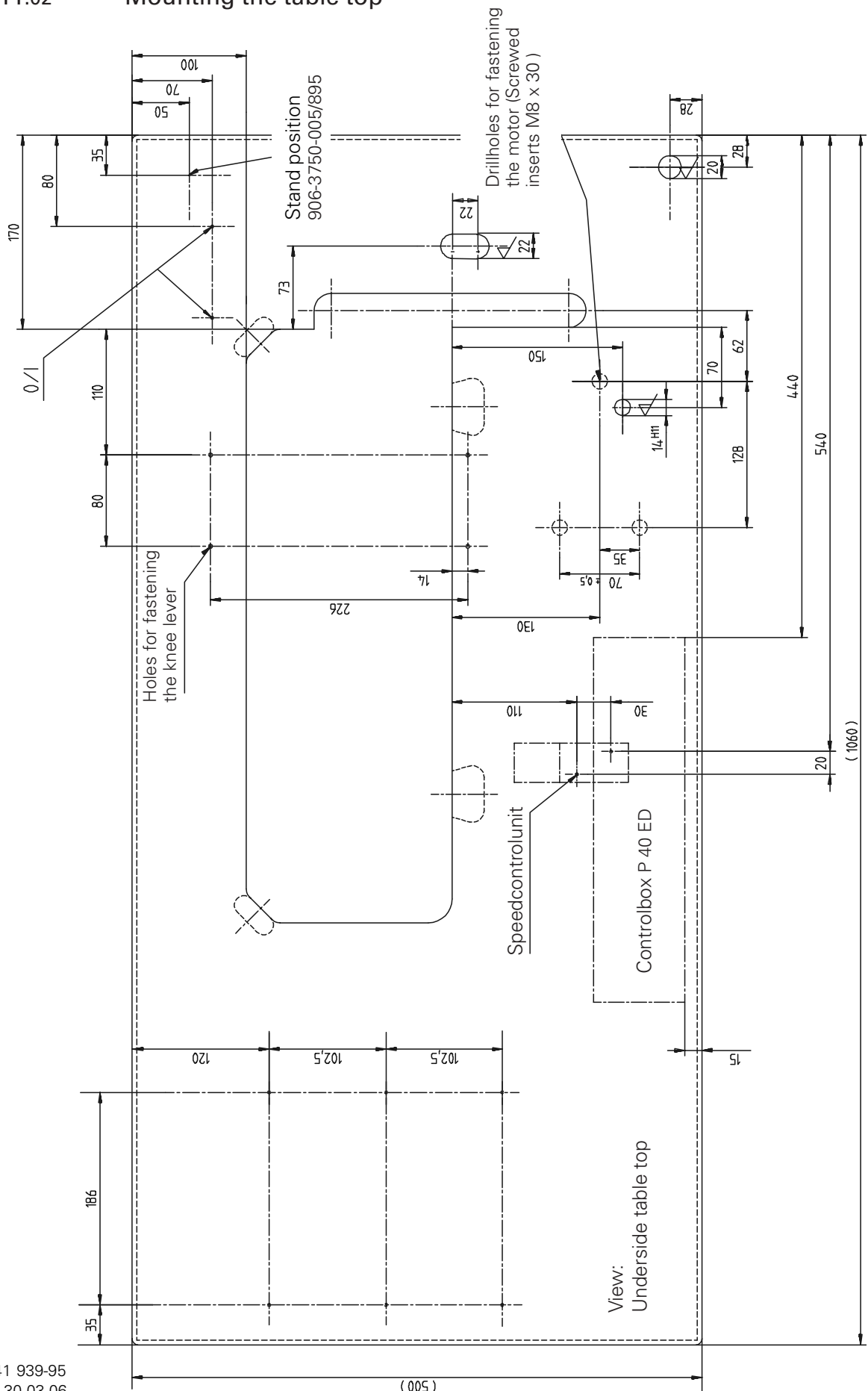

11.03 Circuit diagrams

Reference list for the Circuit diagrams

A1	Control unit Quick P40 ED
A2	Control panel BDF S2
A14	Sewing head recognition system (OTE)
H1	Sewing lamp (optional)
H10	LED stitch counter
M1	Sewing motor
Q1	Main switch
S1	Manual backtacking key
S1.1	Pedal speed control unit
S2	Needle position change key
S3	Single stitch key
S6	Start inhibitor (E6 stop)
X0	PC-interface (RS 232)
X1	Motor
X2	Incremental transducer
X2.1	Incremental transmitter adapter
X2.2	Synchronizer adapter
X2.3	Y5-911/.. backtacking device
X3	Speed control unit
X3.1	Y2-900/.. thread trimmer (FS)
X4	A2 control panel plug BDF S2
X4.1	Y4 -910/.. automatic foot lift
X5	Out-/input
X6	Bobbin thread monitor (optional)
X6.1	Y8 Thread tension release
X7	Photoelectric barrier (optional)
X22	Y2 -900/.. thread trimmer (FS)
X24	Y4 -910/.. automatic foot lift
X25	Y5 -911/.. backtacking device
X28	Y8 Thread tension release
X40	S1-3 Control panel
X50	A14 Sewing head recognition system (OTE)
Y2	-900/.. thread trimmer
Y4	-910/.. automatic foot lift
Y5	-911/.. backtacking device
Y8	Thread tension release

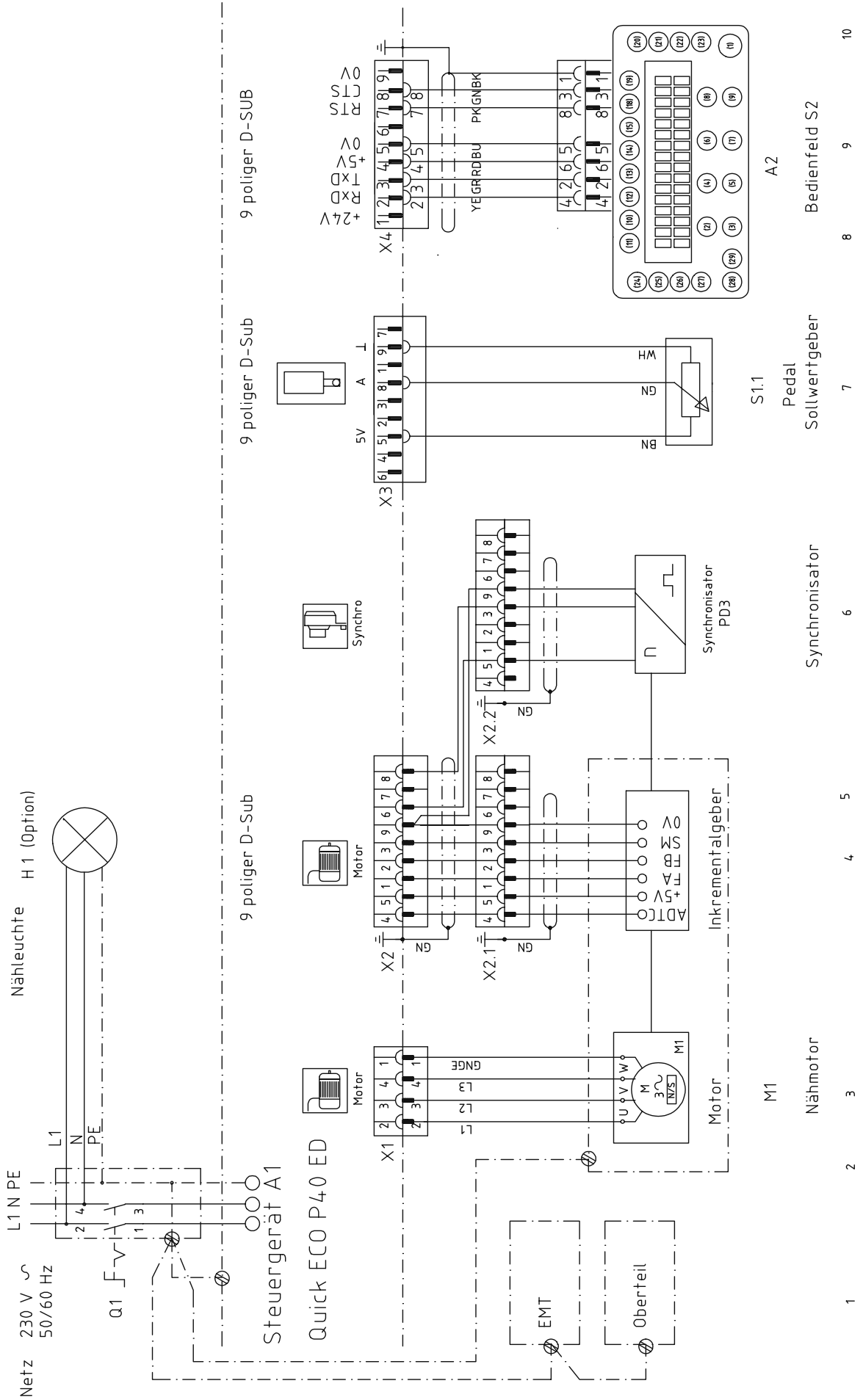

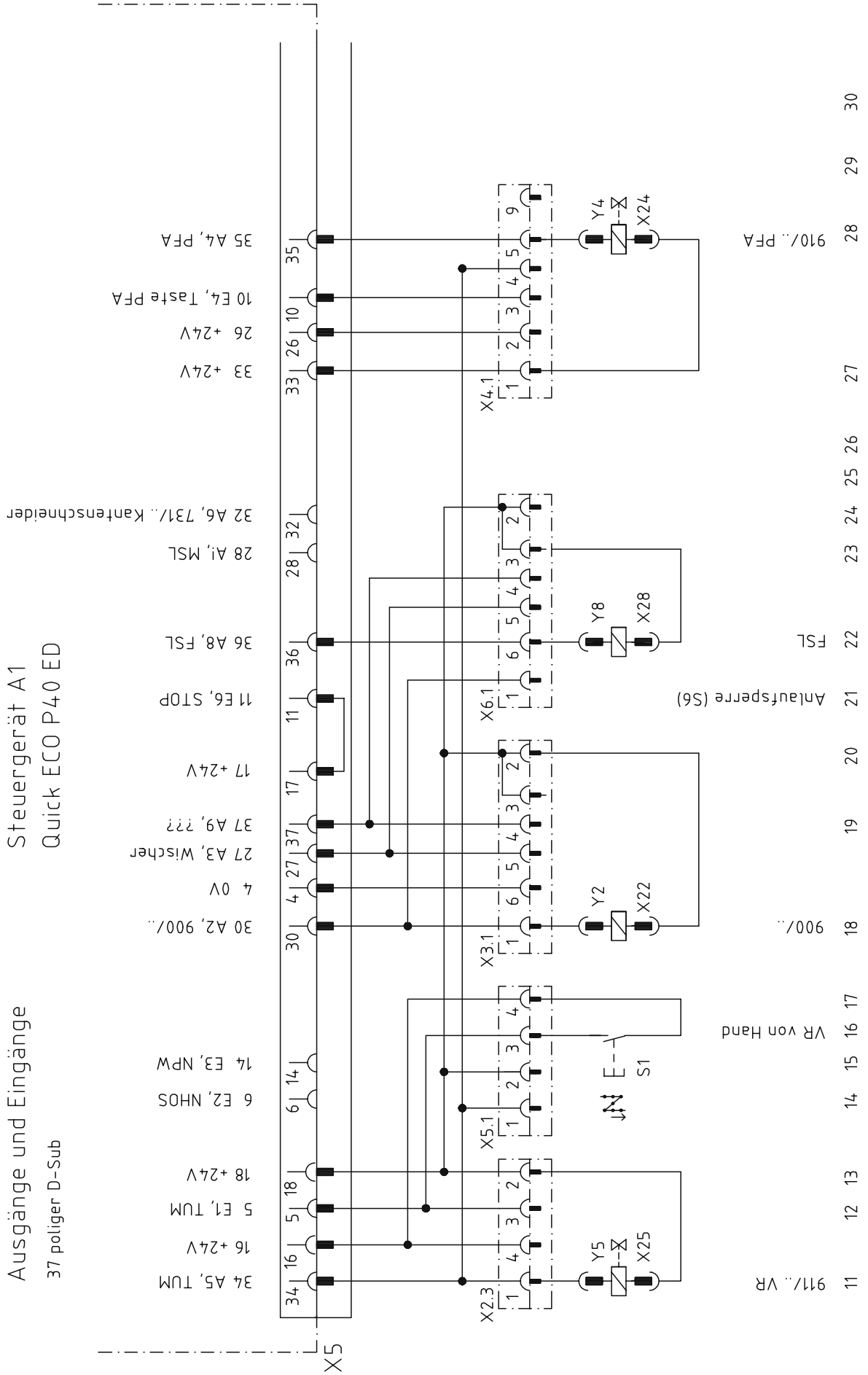

Steuergerät A1 Quick P40 ED

Sonderfunktionen

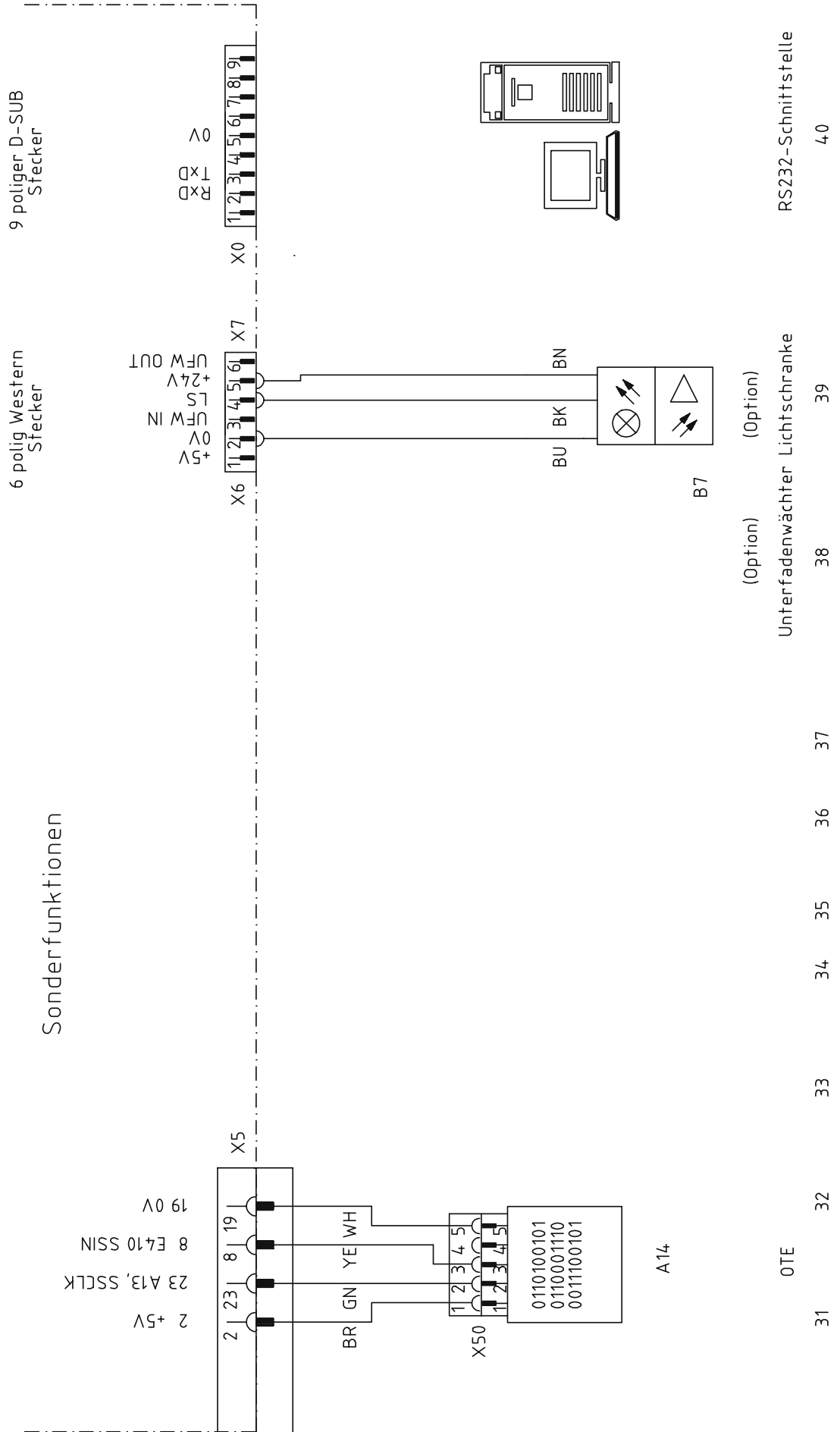

This is a list of the most important wearing parts.

A detailed parts list for the complete machine is included with the accessories.

In case of loss, the parts list can be downloaded from the internet address www.pfaff-industrial.com/pfaff/de/service/downloads As an alternative to the internet download the parts lists can also be ordered in book form under part no. 296-12-18 639.

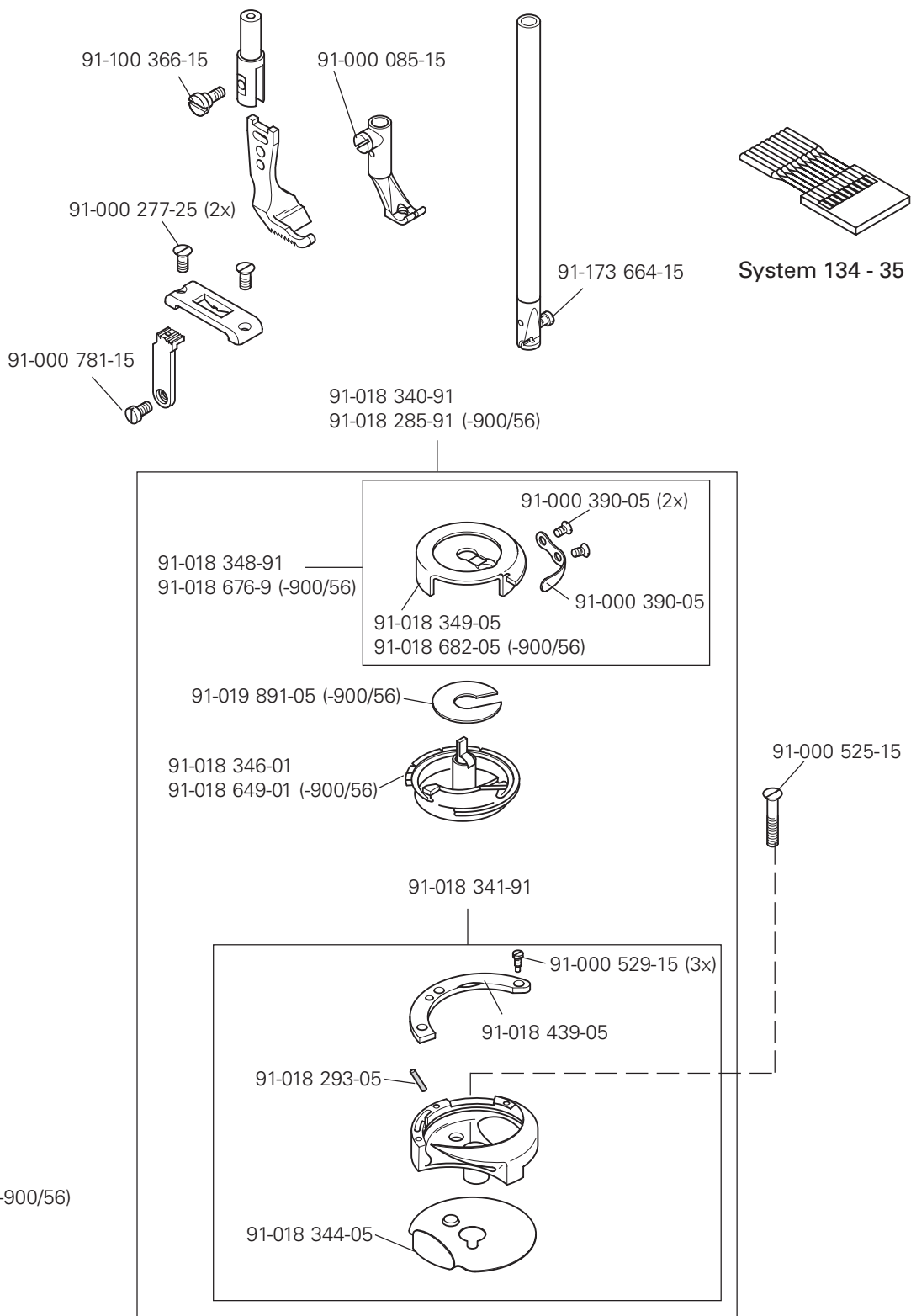

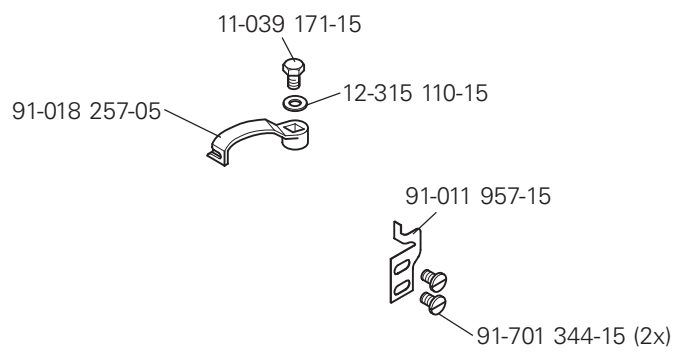
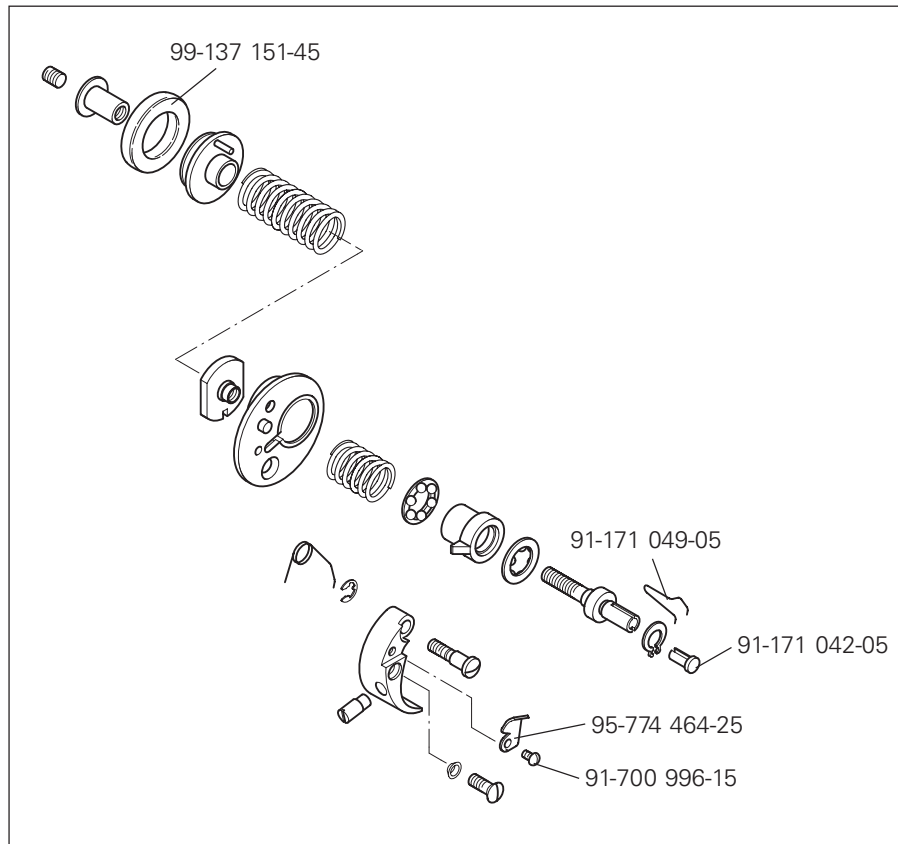



Europäische Union
Wachstum durch Innovation – EFRE

PFAFF Industriesysteme und Maschinen AG

Hans-Geiger-Str. 12 - IG Nord
D-67661 Kaiserslautern

Phone: +49-631 200-0
Fax: +49-631 17202
E-mail: info@pfaff-industrial.com

Hotlines:

Technical service: +49-175/2243-101
Application consultancy: +49-175/2243-102
Spare-parts hotline: +49-175/2243-103