

DL1-B812

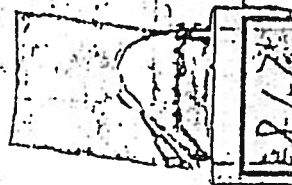

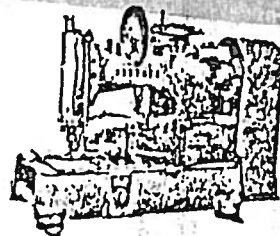
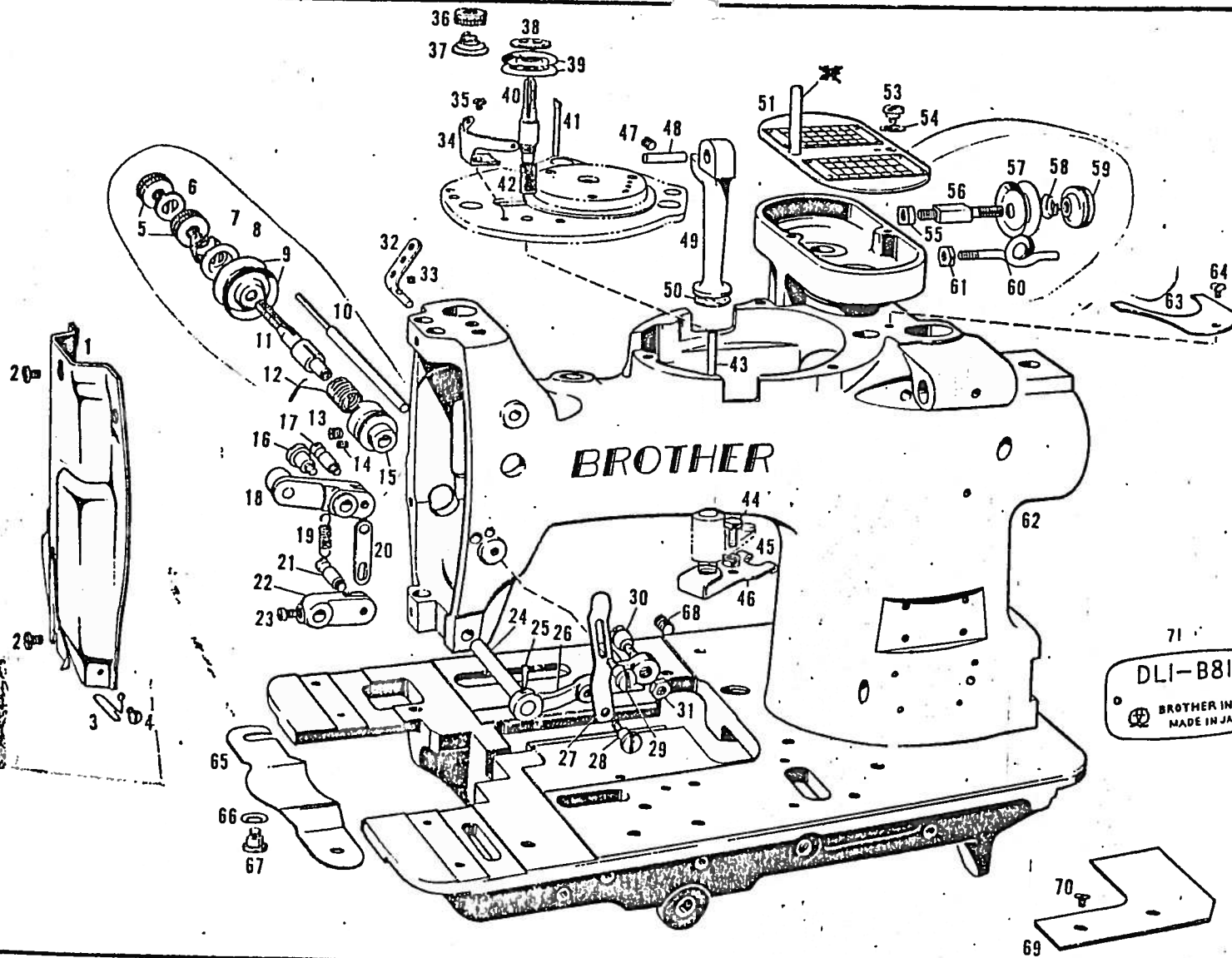

71
DLI-B812
BROTHER IN-LTD
MADE IN JAPAN

PARTS LIST for DLI-B812

B812-3

| Ref. No. | Name of Parts | Q'ty | Parts No. | Assy No. | Ref. No. | Name of Parts | Q'ty | Parts No. | Assy No. |
|----------|------------------------------------|--------|-------------|-------------|----------|-------------------------------------|--------|-------------|----------|
| A-1 | Face Plate | 1 pce. | 107659-0-01 | | A-46 | Tension Thread Release Plate | 1 pce. | 107609-0-01 | |
| A-2 | Set Screw for A-1 | 2 pcs. | 107491-0-02 | | A-47 | Set Screw for A-48 | 1 " | 104649-0-01 | |
| A-3 | Thread Guide on A-1 | 1 pce. | 107660-0-01 | | A-48 | Head Supporter Pin | 1 " | 107314-0-01 | |
| A-4 | Set Screw for A-3 | 1 " | 107661-0-01 | | A-49 | Head Supporter | 1 " | 107312-0-01 | |
| A-5 | Tension Control Nut | 2 pcs. | 107607-0-01 | | A-50 | Head Supporter Leather | 1 " | 107313-0-01 | |
| A-6 | Washer for A-5 | 1 pce. | 107625-0-01 | | A-51 | Gear Case Cover Ass | 1 Set. | 107010-0-01 | |
| A-7 | Tension Spring (B) | 1 " | 107624-0-01 | | A-53 | Stud Screw for A-51 | 1 pce. | 107321-0-01 | |
| A-8 | Tension Disc Washer | 1 " | 100134-0-01 | | A-54 | Washer for A-53 | 1 pce. | 107017-0-01 | |
| A-9 | Tension Disc | 2 pcs. | 108721-0-01 | | A-55 | Locking Nut for A-56 | 1 " | 107197-0-01 | |
| A-10 | Tension Thread Release Pin (B) | 1 pce. | 107627-0-01 | | A-56 | Bobbin Winder Tension Stud | 1 " | 107678-0-01 | 架壳轴子杆 |
| A-11 | Tension Stud Screw (B) 1/2" x 1/4" | 1 " | 107619-0-01 | 176922 | A-57 | Bobbin Winder Tension Disc | 2 pcs. | 107680-0-02 | |
| A-12 | Check Spring | 1 " | 107621-0-01 | | A-58 | Bobbin Winder Tension Spring | 1 pce. | 107681-0-01 | |
| A-13 | Set Screw for A-15 | 1 " | 107086-0-01 | | A-59 | Bobbin Winder Tension Control Screw | 1 " | 107682-0-01 | |
| A-14 | Set Screw for A-11 | 1 " | 100402-0-02 | | A-60 | Thread Guide | 1 " | 107676-0-01 | |
| A-15 | Upper Tread Tension Bracket | 1 " | 100397-0-01 | | A-61 | Nut for A-60 | 1 " | 107733-0-01 | |
| A-16 | Stud Screw for A-22 | 1 " | 107658-0-01 | | A-62 | Armbed | 1 set. | 108820-0-01 | |
| A-17 | Sustainer for A-22 | 1 " | 107657-0-01 | | A-63 | Top Cover for Arm | 1 pce. | 107011-0-01 | |
| A-18 | Upper Thread Pulling Lever | 1 " | 107655-0-01 | | A-64 | Fastening Screw for A-63 | 1 " | 100257-0-07 | |
| A-19 | Spring for A-18 | 1 " | 107656-0-01 | | A-65 | Bed Hinge Plate | 1 " | 107015-0-01 | |
| A-20 | Pulling Plate for A-18 | 1 " | 107654-0-01 | 107353-0-01 | A-66 | Washer for A-67 | 2 pcs. | 107017-0-01 | |
| A-21 | Sustainer for A-22 | 1 " | 107657-0-01 | | A-67 | Stud Screw for A-65 | 2 " | 107016-0-01 | |
| A-22 | Upper Thread Pulling Link | 1 " | 107652-0-01 | | A-68 | Cap Screw for Oil Hole of F-28 | 1 pce. | 100218-0-02 | |
| A-23 | Set Screw for A-22 | 1 " | 107459-0-01 | | A-69 | Base Cover | 1 " | 107013-0-01 | |
| A-24 | Upper Thread Pulling Arm Shaft | 1 " | 107646-0-01 | | A-70 | Set Screw for Base Cover | 2 pcs. | 107014-0-02 | |
| A-25 | Taper Pin for A-26 | 1 " | 107645-0-02 | | A-71 | Model Plate | 1 pce. | 110921-0-01 | |
| A-26 | Upper Thread Pulling Arm | 1 " | 107644-0-01 | | A-72 | Model Plate Pin | 2 pcs. | 116231-0-01 | |
| A-27 | Upper Thread Release Plate | 1 " | 107649-0-01 | 107347-0-01 | | | | | |
| A-28 | Stud Screw for A-27 | 1 " | 107650-0-01 | | | | | | |
| A-29 | Stud Screw for A-27 | 1 " | 107650-0-01 | | | | | | |
| A-30 | Ball Stud Screw for A-26 | 1 " | 107647-0-01 | | | | | | |
| A-31 | Nut for A-30 | 1 " | 107114-0-01 | | | | | | |
| A-32 | Thread Retainer | 1 " | 114931-0-01 | | | | | | |
| A-33 | Set Screw for A-32 | 1 " | 104649-0-01 | | | | | | |
| A-34 | Tension Thread Guide | 1 " | 107613-0-01 | | | | | | |
| A-35 | Set Screw for A-34 | 1 " | 105160-0-01 | | | | | | |
| A-36 | Tension Control Nut | 1 " | 107607-0-01 | | | | | | |
| A-37 | Tension Spring (A) | 1 " | 107606-0-01 | | | | | | |
| A-38 | Tension Disc Washer | 1 " | 100134-0-01 | | | | | | |
| A-39 | Tension Disc | 2 pcs. | 108721-0-01 | | | | | | |
| A-40 | Tension Stud Screw (A) | 1 pce. | 107602-0-01 | | | | | | |
| A-41 | Tension Thread Release Pin (A) | 1 " | 107612-0-01 | | | | | | |
| A-42 | Spring for A-39 | 1 " | 107603-0-01 | | | | | | |
| A-43 | Tension Thread Release Rod | 1 " | 107608-0-01 | | | | | | |
| A-44 | Bolt for A-46 | 1 " | 107610-0-01 | | | | | | |
| A-45 | Nut for A-44 | 1 " | 105234-0-01 | | | | | | |

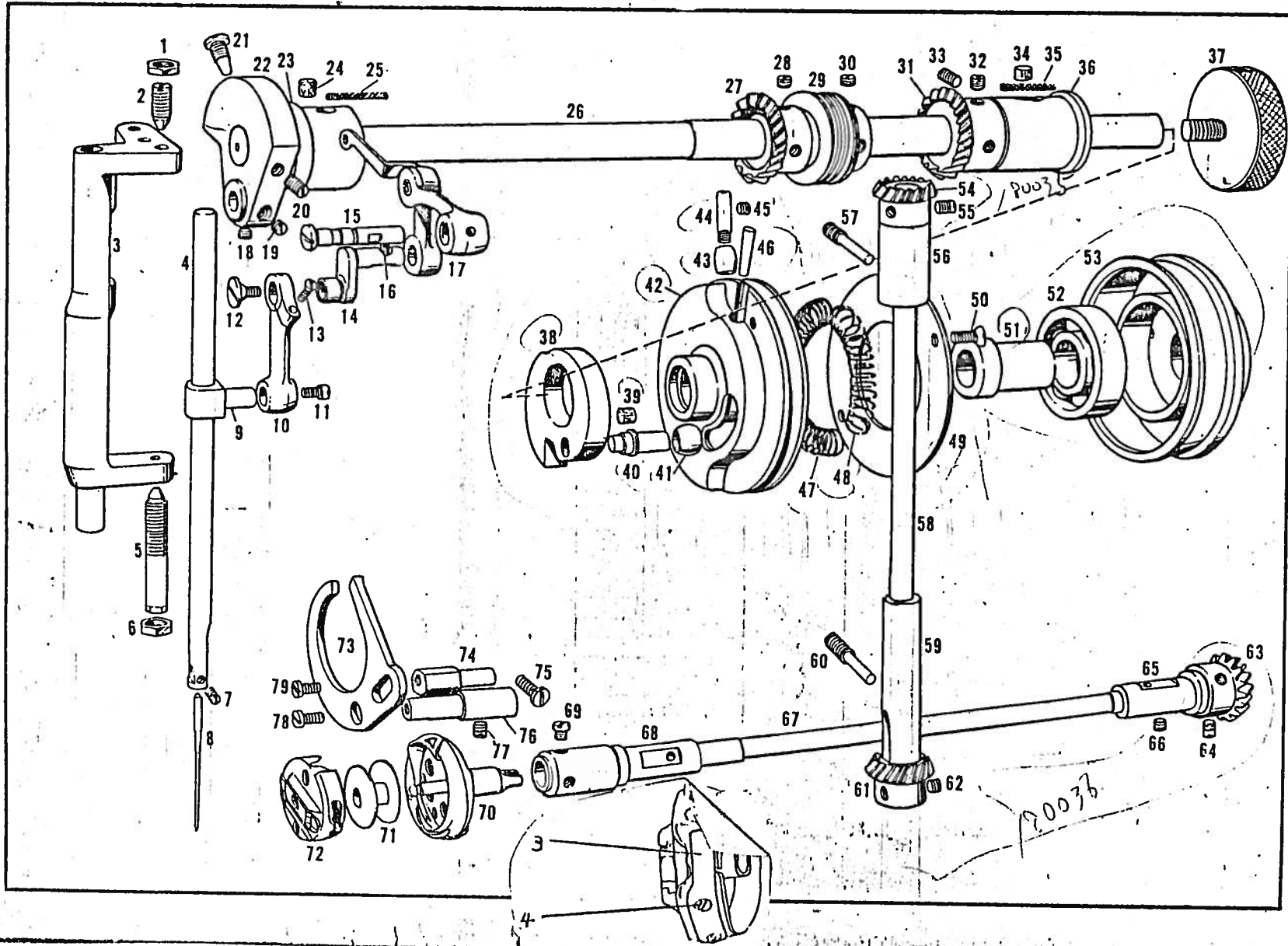

| Ref. No. | Name of Parts | Q'ty | Parts No. | Assembly No. | Ref. No. | Name of Parts | Q'ty | Parts No. | Assembly No. |
|----------|--------------------------------------|--------|-------------|--------------|----------|-------------------------------------|--------|-------------|--------------|
| B-1 | Nut for B-2 | 1 pce. | 107059-0-01 | | B-44 | Roller Shaft for Arm Pulley | 1 pce. | 107031-0-01 | |
| B-2 | Upper Centre Screw for B-3 | 1 " | 107058-0-01 | | B-45 | Set Screw for B-44 | 1 " | 100218-0-02 | 182083-0-01 |
| B-3 | Needle Bar Support | 1 " | 107057-0-01 | | B-49 | Pulley Cover | 1 " | 107037-0-01 | |
| B-4 | Needle Bar | 1 " | 107054-0-01 | 180034-0-01 | B-50 | Fastening Screw for B-49 | 2 pcs. | 107038-0-01 | |
| B-5 | Lower Centre Screw for B-3 | 1 " | 107060-0-01 | | B-46 | Taper Pin for B-42 | 1 pce. | 107030-0-01 | |
| B-6 | Nut for B-5 | 1 " | 107061-0-01 | | B-47 | Plunge Spring (long) 鉄釘入り | 1 " | 107034-0-01 | |
| B-7 | Set Screw for Needle | 1 " | 107055-0-01 | | B-48 | Plunge Spring (short) | 1 " | 107035-0-01 | |
| B-8 | Industrial Needle (DPx5) | 1 " | 107415-0-14 | | B-51 | Bushing for D-52 | 1 " | 107041-0-00 | |
| B-9 | Needle Bar Connecting Stud | 1 " | 107052-0-01 | | B-52 | Ball Bearing 62032 for B-53 | 1 " | 107040-0-00 | 107020-0-01 |
| B-10 | Needle Bar Crank Rod | 1 " | 107050-0-01 | | B-53 | Idle Pulley | 1 " | 107039-0-01 | |
| B-11 | Clamp Screw for B-9 | 1 " | 100025-0-01 | | B-54 | Upper Spiral Bevel Gear for B-58 | 1 " | 107070-0-01 | |
| B-12 | Cap Screw for B-14 | 1 " | 107049-0-01 | | B-55 | Set Screw for B-54 | 2 pcs. | 107071-0-03 | 180035-0-01 |
| B-13 | Adjusting Screw for B-10 | 1 " | 100255-0-02 | 107021-0-01 | B-31 | Upper Shaft Spiral Bevel Gear | 1 pce. | 107067-0-01 | |
| B-14 | Needle Bar Crank | 1 " | 107046-0-01 | | B-32 | Set Screw for B-31 | 1 " | 100251-0-01 | |
| B-15 | Thread Take up Lever Supporter Shaft | 1 " | 107065-0-01 | | B-56 | Upper Bushing for B-58 | 1 " | 107073-0-00 | |
| B-17 | Thread Take up Link | 1 " | 107062-0-01 | | B-57 | Set Screw for B-56 | 1 " | 107074-0-01 | |
| B-16 | Set Screw for B-15 | 1 " | 100016-0-03 | | B-58 | Vertical Shaft | 1 " | 107072-0-01 | |
| B-18 | Set Screw for B-14 & B-22 | 1 " | 100251-0-01 | | B-59 | Lower Bushing for B-58 | 1 " | 107075-0-00 | |
| B-19 | Set Screw for B-14 & B-22 | 1 " | 101706-0-01 | | B-60 | Set Screw for B-59 | 1 " | 107076-0-01 | |
| B-20 | Screw for B-22 | 1 " | 107045-0-01 | | B-61 | Lower Spiral Bevel Gear for B-58 | 1 " | 107077-0-01 | |
| B-21 | Position Screw for B-22 | 1 " | 100250-0-01 | | B-62 | Set Screw for B-61 | 2 pcs. | 100251-0-01 | |
| B-22 | Balance Crank | 1 " | 107019-0-00 | 181984001 | B-63 | Lower Shaft Spiral Bevel Gear | 1 pce. | 107079-0-01 | 180036-0-01 |
| B-23 | Upper Shaft Bushing (left) | 1 " | 107448-0-01 | | B-64 | Set Screw for B-63 | 2 pcs. | 115995-0-01 | |
| B-24 | Oil Felt for B-23 | 1 " | 107448-0-01 | | B-65 | Lower Shaft Bushing (right) | 1 pce. | 107085-0-01 | |
| B-25 | Wick 4x10 for B-23 | 1 " | 107479-0-01 | | B-66 | Set Screw for B-65 | 1 " | 107086-0-01 | |
| B-26 | Upper Shaft | 1 " | 107018-0-01 | | B-67 | Lower Shaft | 1 " | 107081-0-01 | 180929001 |
| B-27 | Zigzag Pinion Bevel Gear (B) | 1 " | 107234-0-01 | 181988-0-01 | B-68 | Lower Shaft Bushing (left) | 1 " | 107087-0-01 | |
| B-28 | Set Screw for B-27 | 1 " | 100058-0-03 | | B-69 | Set Screw for B-70 | 2 pcs. | 100366-0-03 | |
| B-29 | Worm | 1 " | 107489-0-01 | | B-70 | Rotary Hook Assembly | 1 set. | 107089-0-01 | |
| B-30 | Set Screw for B-29 | 1 " | 100058-0-03 | | B-72 | Bobbin Case | 1 pce. | 107097-0-01 | 180038-0-01 |
| B-31 | Upper Shaft Spiral Bevel Gear | 1 " | 107067-0-01 | | B-71 | Bobbin | 1 " | 107098-0-01 | |
| B-32 | Set Screw for B-31 | 1 " | 100251-0-01 | | B-73 | Rotary Hook Holder Position Bracket | 1 " | 107090-0-01 | |
| B-33 | Set Screw for B-36 | 1 " | 100016-0-01 | | B-74 | Upper Supporter for B-73 | 1 " | 107094-0-01 | |
| B-34 | Oil Felt for B-36 | 1 " | 107448-0-01 | | B-75 | Set Screw for B-74 | 1 " | 104908-0-01 | |
| B-35 | Wick 4x 10 for B-36 | 1 " | 107479-0-01 | | B-76 | Lower Supporter for B-73 | 1 " | 107091-0-01 | |
| B-36 | Upper Shaft Bushing (right) | 1 " | 107022-0-00 | | B-77 | Set Screw for B-76 | 1 " | 100539-0-02 | |
| B-37 | Cap Screw for B-53 | 1 " | 107042-0-01 | | B-78 | Set Screw for B73 & B-76 | 1 " | 107093-0-01 | |
| B-38 | Stopper Cam | 1 " | 107025-0-01 | 182216-0-01 | B-79 | Set Screw for B-73 & B-74 | 1 " | 103988-0-01 | |
| B-40 | Roller Shaft for Stopper Cam | 1 " | 107025-0-01 | | | | | | |
| B-39 | Wick 7x6 for B-38 | 2 pce. | 107452-0-01 | | | | | | |
| B-41 | Roller for Stopper Cam | 1 pce. | 107027-0-01 | 182083-0-01 | | | | | |
| B-42 | Arm Pulley | 1 " | 107029-0-01 | | | | | | |
| B-43 | Roller for Arm Pulley | 1 " | 107033-0-01 | | | | | | |

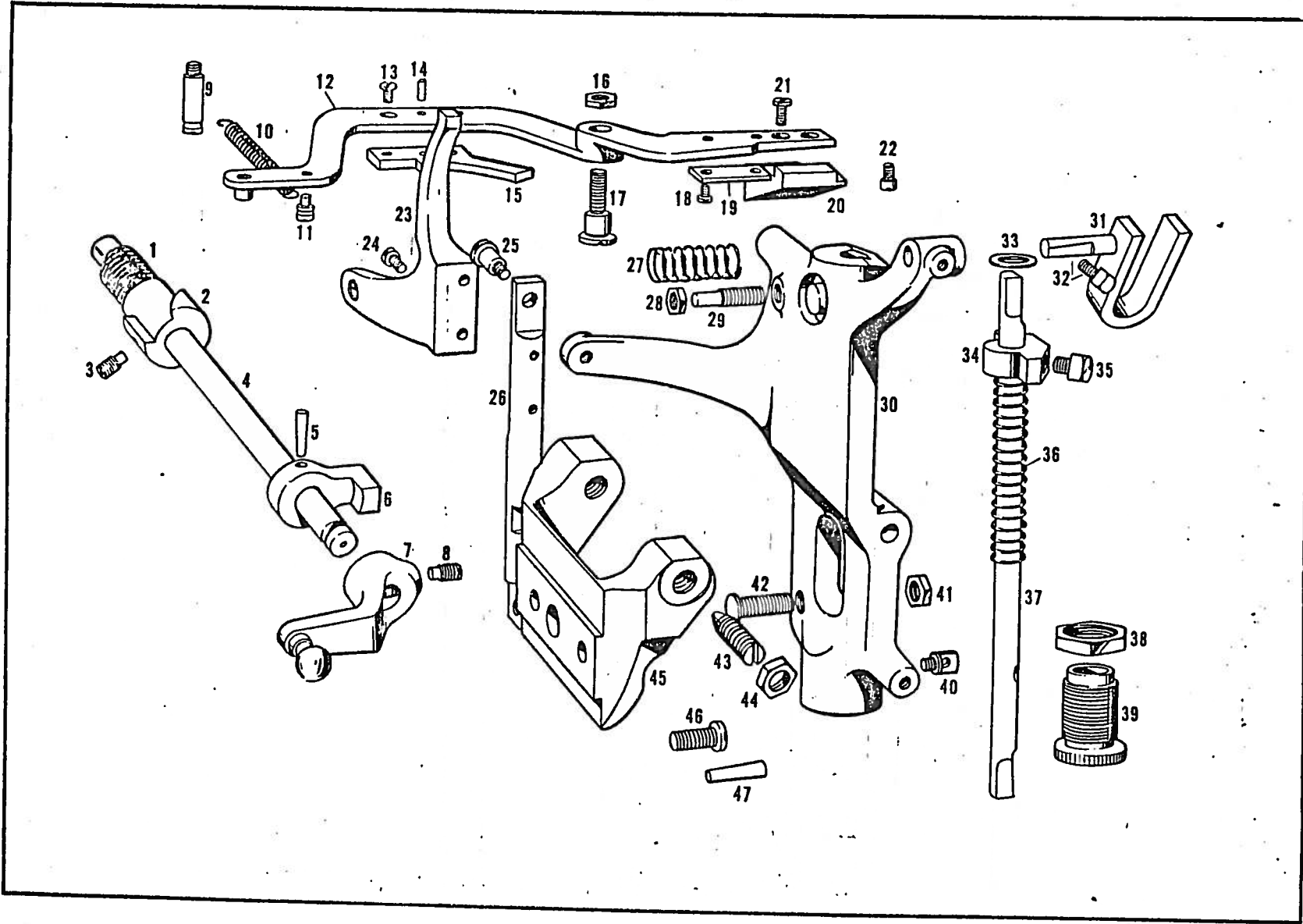

| Ref. No. | Name of Parts | Q'ty | Parts No. | Assem. No. | Ref. No. | Name of Parts | Q'ty | Parts No. | As. No. | y |
|----------|------------------------------------|--------|-------------|------------|----------|--------------------|--------|------------------------|-----------|---|
| C-1 | Emergency Stop Handle Spring | 1 pce. | 107147-0-01 | 107139 | C-46 | Set Screw for C-45 | 1 pce. | 107100-0-01 | | |
| C-2 | Emergency Stop Cam | 1 " | 107145-0-00 | | C-47 | Taper Pin for C-45 | 2 pcs. | 107005-0-00 | 100237007 | |
| C-3 | Set Screw for C-2 | 1 " | 107141-0-01 | | | | | | | |
| C-4 | Emergency Stop Handle Shaft | 1 " | 107142-0-00 | | | | | | | |
| C-5 | Taper Pin for C-6 | 1 " | 107749-0-00 | | | | | | | |
| C-6 | Emergency Stoppr | 1 " | 107143-0-01 | | | | | | | |
| C-7 | Emergency Stop Handle Assembly | 1 set. | 107092-0-01 | | | | | | | |
| C-8 | Set Screw for C-7 | 1 pce. | 107141-0-01 | | | | | | | |
| C-9 | Sustainer for C-12 | 1 " | 107138-0-01 | | | | | | | |
| C-10 | Stop Motion Lever Tension Spring | 1 " | 107137-0-01 | | | | | | | |
| C-11 | Sustainer for Stop Lever Spring | 1 " | 107126-0-01 | | | | | | | |
| C-12 | Stop Motion Lever | 1 " | 107123-0-01 | | | | | | | |
| C-13 | Set Screw for C-15 | 2 pcs. | 100257-0-06 | | | | | | | |
| C-14 | Knock Pin for C-15 | 1 pce. | 107131-0-00 | | | | | | | |
| C-15 | Stopper Claw <i>W & W</i> | 1 " | 108818-0-01 | | | | | | | |
| C-16 | Nut for C-17 | 1 " | 107059-0-01 | | | | | | | |
| C-17 | Stop Motion Lever Stud Screw | 1 " | 107127-0-01 | | | | | | | |
| C-18 | Set Screw for C-19 | 2 pcs. | 100257-0-06 | | | | | | | |
| C-19 | Claw Plate for C-26 | 1 pce. | 107132-0-01 | | | | | | | |
| C-20 | Belt Shifter Bracket | 1 " | 107134-0-01 | | | | | | | |
| C-21 | Set Screw for C-12 | 1 " | 100137-0-03 | | | | | | | |
| C-22 | Stop Screw for C-20 | 1 " | 100522-0-02 | | | | | | | |
| C-23 | Clutch Lever | 1 " | 107121-0-01 | | | | | | | |
| C-24 | Set Screw for C-23 | 2 pcs. | 107122-0-01 | | | | | | | |
| C-25 | Stud Screw for C-26 | 1 pce. | 107120-0-02 | | | | | | | |
| C-26 | Clutch Pulling Lever | 1 " | 107119-0-01 | | | | | | | |
| C-27 | Spring for C-30 | 1 " | 107112-0-01 | | | | | | | |
| C-28 | Nut for C-29 | 1 " | 107114-0-01 | | | | | | | |
| C-29 | Upper Clutch Stopper Screw | 1 " | 107113-0-01 | | | | | | | |
| C-30 | Clutch Body | 1 " | 107104-0-01 | | | | | | | |
| C-31 | Belt Shifter <i>W & W</i> | 1 " | 107117-0-01 | | | | | | | |
| C-32 | Set Screw for C-31 | 1 " | 107118-0-01 | | | | | | | |
| C-33 | Clutch Guide Buffer Leather | 1 " | 107108-0-01 | | | | | | | |
| C-34 | Clutch Guide <i>W & W</i> | 1 " | 107106-0-01 | | | | | | | |
| C-35 | Set Screw for Clutch Guide | 1 " | 107107-0-01 | | | | | | | |
| C-36 | Clutch Spring | 1 " | 107109-0-01 | | | | | | | |
| C-37 | Clutch | 1 " | 107105-0-01 | | | | | | | |
| C-38 | Nut for C-39 | 2 pcs. | 107111-0-01 | | | | | | | |
| C-39 | Adjustable Screw for Clutch Spring | 1 pce. | 107110-0-01 | | | | | | | |
| C-40 | Lower Sustainer for I-32 | 1 " | 107640-0-01 | | | | | | | |
| C-41 | Nut for C-42 | 1 " | 107116-0-01 | | | | | | | |
| C-42 | Lower Clutch Stopper Screw | 1 " | 107115-0-01 | | | | | | | |
| C-43 | Centre Screw for C-45 | 2 pcs. | 107102-0-01 | | | | | | | |
| C-44 | Nut for C-43 | 2 " | 107103-0-01 | | | | | | | |
| C-45 | Clutch Bracket | 1 pce. | 107099-0-01 | | | | | | | |

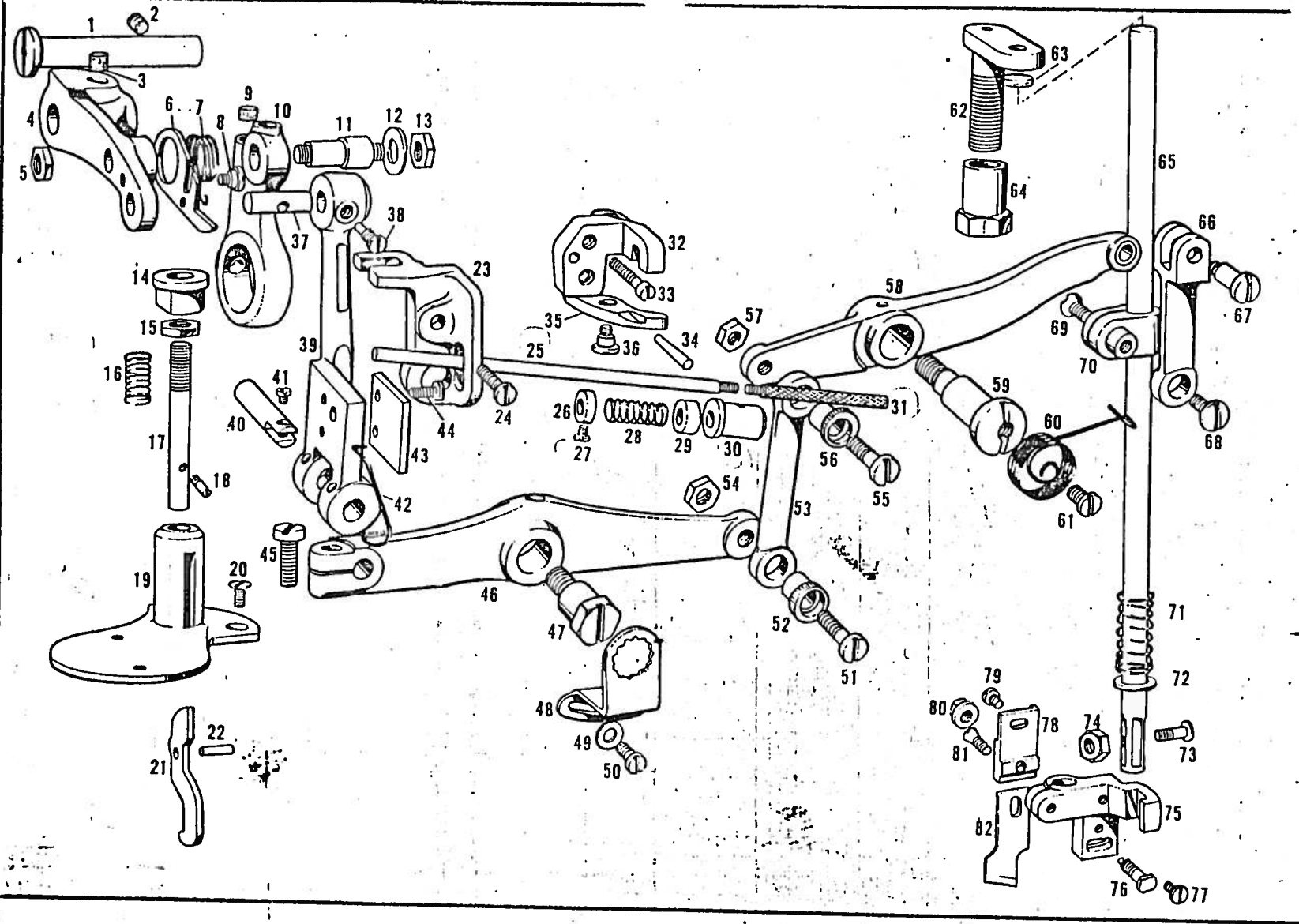

| Ref. No. | Name of Parts | Q'ty | Parts No. | At lly | Ref. No. | Name of Parts | Q'ty | Parts No. | nbly |
|----------|------------------------------------|--------|-------------|-------------|----------|------------------------------------|--------|---------------------|-------------|
| D-1 | Cutter Lever Shaft | 1 pce. | 107156-0-01 | | D-46 | Cutter Lever Lower | 1 pce. | 107170-0-01 | |
| D-3 | Oil Felt for Cutter Lever for D-4 | 2 pcs. | 107149-0-01 | 107036-0-01 | D-47 | Stud Screw for D-46 | 1 " | 107172-0-01 | |
| D-4 | Cutter Lever | 1 Pce. | 107154-0-01 | 80040-0-01 | D-48 | Bracket for D-47 | 1 " | 107173-0-01 | |
| D-6 | Cutter Clutch Stopper Plate Ass'y | 1 set. | 107044-0-01 | | D-49 | Washer for D-50 | 1 " | 107175-0-01 | |
| D-5 | Nut for D-11 | 1 pce. | 107059-0-01 | | D-50 | Set Screw for D-48 | 1 " | 107174-0-01 | |
| D-7 | Spring for D-6 | 1 " | 107160-0-01 | | D-51 | Set Screw for D-52 | 1 " | 107178-0-01 | |
| D-8 | Stud Screw for D-6 | 1 " | 107161-0-01 | 107036-0-01 | D-52 | Cuter Link Bushing | 1 " | 107177-0-01 | |
| D-9 | Oil Felt for D-10 | 2 pcs. | 107149-0-01 | | D-53 | Cutter Link 4.7-4.7 | 1 " | 107176-0-01 | 10705100 |
| D-10 | Cutter Crank Rod | 1 pce. | 107148-0-01 | | D-54 | Nut for D-51 | 1 " | 107435-0-01 | |
| D-11 | Cutter Crenk Rod Shaft | 1 " | 107151-0-01 | | D-55 | Set Screw for D-56 | 1 " | 107178-0-01 | |
| D-13 | Nut for D-11 | 1 " | 107059-0-01 | 180039-0-01 | D-56 | Cutter Link Bushing | 1 " | 107177-0-01 | |
| D-12 | Washer for D-11 | 1 " | 107153-0-01 | | D-57 | Nut for D-55 | 1 " | 107435-0-01 | |
| D-2 | Set Screw for D-1 | 1 " | 107157-0-01 | | D-58 | Cutter Lever Upper 4.9-7.1 | 1 " | 107188-0-01 | 18196400 |
| D-14 | Cutter Lever Holder | 1 " | 107223-0-01 | | D-59 | Stud Screw for D-58 | 1 " | 107181-0-01 | |
| D-15 | Nut for D-14 | 1 " | 107059-0-01 | | D-60 | Spring for D-58 | 1 " | 107182-0-01 | |
| D-16 | Spring for D-17 | 1 " | 107227-0-01 | | D-61 | Set Screw for D-60 | 1 " | 107183-0-01 | |
| D-17 | Cutter Lever Connecting Bar | 1 " | 107225-0-01 | | D-62 | Cutter Bar Stopper | 1 " | 107180-0-01 | 4.718(4) |
| D-18 | Guide Screw for D-17 | 1 " | 107226-0-01 | 107082-0-01 | D-63 | Fibre for D-62 | 1 " | 107193-0-01 | 107068-0-01 |
| D-19 | Cutter Lever Holding Bracket | 1 " | 107228-0-01 | | D-64 | Nut for D-62 | 1 " | 107194-0-01 | |
| D-20 | Set Screw for D-19 | 2 pcs. | 107231-0-01 | | D-66 | Cutter Bar Connecting Rod 10.7066 | 1 " | 107184-0-01 | |
| D-21 | Cutter Safety | 1 pce. | 107229-0-01 | | D-67 | Stud Screw for D-66 | 1 " | 107185-0-01 | |
| D-22 | Taper Pin for D-21 | 1 " | 107230-0-01 | | D-68 | Cap Screw for D-66 | 1 " | 107186-0-01 | 107066-0-01 |
| D-23 | Cutter Clutch Guide | 1 " | 107232-0-01 | | D-69 | Set Screw for D-70 | 1 " | 107188-0-01 | |
| D-24 | Set Screw for D-23 | 1 " | 100560-0-03 | | D-70 | Cutter Bar Connecting Stud | 1 " | 107187-0-01 | |
| D-25 | Cutter Clutch Pressure Bar (long) | 1 " | 107211-0-01 | | D-71 | Cutter Bar Spring | 1 " | 107191-0-01 | |
| D-26 | Set Collar for D-25 | 1 " | 107214-0-01 | | D-72 | Cutter Bar washer | 1 " | 107190-0-01 | |
| D-27 | Set Screw for D-26 | 1 " | 107215-0-01 | | D-65 | Cutter Bar | 1 " | 107189-0-01 | |
| D-28 | Spring for D-26 | 1 " | 107216-0-01 | | D-73 | Set Screw for D-75 | 1 " | 107196-0-01 | |
| D-29 | Washer for D-25 | 1 " | 107217-0-01 | | D-74 | Nut for D-73 | 1 " | 105254-0-01 | 112106 |
| D-30 | Cutter Clutch Bar Joint | 1 " | 107213-0-01 | | D-75 | Cutter Holder 4.7 7.7 11.7 | 1 " | 107195-0-01 | 107069-0-01 |
| D-31 | Cutter Clutch Pressure Bar (short) | 1 " | 107212-0-01 | | D-76 | Stud Screw for Cutter 4.7 7.7 11.7 | 1 " | 107202-0-01 | 107069-0-01 |
| D-32 | Cutter Cam Finger Bracket | 1 " | 107218-0-01 | | D-77 | Set Screw for D-76 | 1 " | 107203-0-01 | |
| D-35 | Cutter Cam Finger | 1 " | 107221-0-01 | | D-78 | Cutter Guide | 1 " | 107199-0-01 | |
| D-36 | Stud Screw for D-35 | 1 " | 107222-0-01 | 107080-0-01 | D-79 | Set Screw for D-78 | 1 " | 100257-0-06 | |
| D-33 | Set Screw for D-32 | 2 pcs. | 107219-0-01 | | D-80 | Nut for D-76 | 1 " | 115369-0-01 | 107201 |
| D-34 | Taper Pin for D-32 | 1 pce. | 107030-0-01 | | D-81 | Set Screw for D-75 | 1 " | 100255-0-02 | |
| D-37 | Cutter Clutch Pin | 1 " | 107162-0-01 | | D-82 | Cutter 1/8" | 1 " | 107204-0-01 | |
| D-38 | Set Screw for D-37 | 1 " | 107163-0-01 | | D-82 | Cutter 1/8" | 1 " | 107200-0-01 | |
| D-39 | Cutter Clutch Body | 1 " | 107164-0-01 | | D-82 | Cutter 3/8" | 1 " | 107205-0-01 | |
| D-40 | Cutter Clutch Shaft | 1 " | 107167-0-01 | | D-82 | Cutter 3/8" | 1 " | 109837-0-01 | |
| D-41 | Set Screw for D-40 | 1 " | 107168-0-00 | | D-82 | Cutter 3/4" | 1 " | 107207-0-01 | |
| D-42 | Cutter Clutch Spring | 1 " | 107169-0-01 | | D-82 | Cutter 1/2" | 1 " | 109838-0-01 | |
| D-43 | Cutter Clutch Holder Plate | 1 " | 107165-0-01 | | D-82 | Cutter 1" | 1 " | 107210-0-01 | |
| D-44 | Set Screw for D-43 | 2 pcs. | 100264-0-01 | | | | | 107197001-705334001 | |
| D-45 | Set Screw for D-46 | 1 pce. | 107171-0-01 | | | | | 108224001-714057001 | |

4378001 409-116

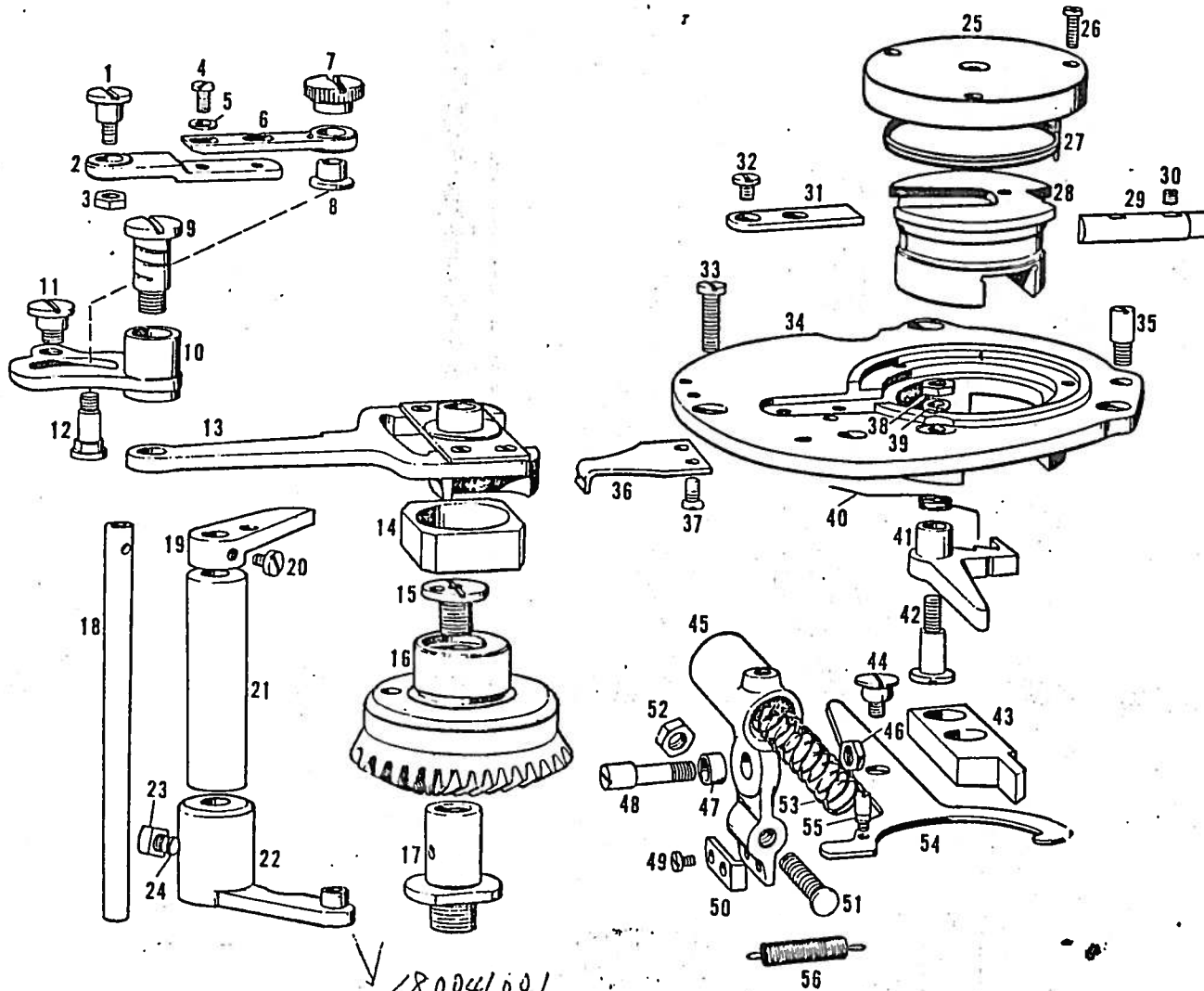

18004/00/
各品調製 組立 - 30分 (37)

| Ref. No. | Name of Parts | Q'ty | Parts No. | Assembly No. | Ref. No. | Name of Parts | Q'ty | Parts No. | Asse. No. |
|----------|--|--------|-------------|--------------|----------|----------------------------------|--------|-------------|-----------|
| E-1 | Stud Screw for Needle Bar Support | 1 pce. | 107256-0-01 | | E-45 | Zigzag Transverse | 1 pce. | 107279-0-01 | |
| E-2 | Zigzag Oscillating Connecting Bar (B) | 1 " | 107253-0-01 | | E-46 | Nut for E-48 | 1 " | 107282-0-01 | |
| E-3 | Nut for E-1 | 1 " | 105234-0-01 | | E-47 | Bush for E-48 | 1 " | 107281-0-01 | |
| E-4 | Set Screw for E-2 & E-6 | 2 pcs. | 101629-0-02 | | E-48 | Zigzag Transverse Shaft | 1 " | 107280-0-01 | |
| E-5 | Washer for E-4 | 2 " | 103847-0-03 | | E-49 | Set Screw for E-50 | 2 pcs. | 105219-0-03 | |
| E-6 | Zigzag Oscillating Connecting Bar (A) | 1 pce. | 107252-0-01 | | E-50 | Zigzag Transverse Cam Finger | 1 pce. | 107283-0-01 | |
| E-7 | Thumb Nut for E-12 | 1 " | 107251-0-01 | | E-51 | Stopper for E-45 | 1 " | 108286-0-01 | 107286 |
| E-8 | Bush for E-12 | 1 " | 107249-0-01 | | E-52 | Nut for E-51 | 1 " | 100090-0-03 | |
| E-9 | Zigzag Oscillating Crank Connecting Stud | 1 " | 107248-0-01 | | E-53 | Zigzag Transverse Stopper Spring | 1 " | 107289-0-01 | |
| E-10 | Zigzag Oscillating Crank | 1 " | 107246-0-01 | | E-54 | Zigzag Regulator Trigger | 1 " | 107268-0-01 | |
| E-11 | Stud Screw for E-13 | 1 " | 107247-0-01 | | E-55 | Spring Sustainer (A) for E-54 | 1 " | 107269-0-01 | |
| E-12 | Zigzag Oscillating Crank Shaft | 1 " | 107250-0-01 | | E-56 | Spring for E-54 | 1 " | 107270-0-01 | |
| E-13 | Zigzag Fork Assembly | 1 " | 107081-0-01 | 180037-0-01 | | | | | |
| E-14 | Zigzag Sleeve | 1 set. | 107239-0-00 | | | | | | |
| E-15 | Cap Screw for E-17 | 1 pce. | 107238-0-01 | | | | | | |
| E-16 | Zigzag Bevel Gear (A) | 1 " | 107236-0-01 | 107083-0-01 | | | | | |
| E-17 | Zigzag Bevel Gear Shaft | 1 " | 107237-0-01 | | | | | | |
| E-18 | Zigzag Regulator Cam Lever Shaft | 1 " | 107292-0-01 | | | | | | |
| E-19 | Zigzag Regulator Trigger Holder | 1 " | 107290-0-01 | | | | | | |
| E-20 | Set Screw for E-19 | 1 " | 107291-0-01 | | | | | | |
| E-21 | Bush for E-18 | 2 pcs. | 107297-0-01 | | | | | | |
| E-22 | Zigzag Regulator Cam Lever | 1 pce. | 107293-0-01 | | | | | | |
| E-23 | Set Screw for E-22 | 1 " | 107296-0-01 | | | | | | |
| E-24 | Pusher for E-23 | 2 pcs. | 101028-0-00 | | | | | | |
| E-25 | Zigzag Regulator Body Cover | 1 " | 107277-0-01 | | | | | | |
| E-26 | Set Screw for E-25 | 3 pcs. | 107278-0-02 | | | | | | |
| E-27 | Spring for E-28 | 1 pce. | 107276-0-01 | | | | | | |
| E-28 | Zigzag Regulator | 1 " | 107259-0-01 | | | | | | |
| E-29 | Zigzag Transverse Rod | 1 " | 107260-0-01 | | | | | | |
| E-30 | Set Screw for E-29 | 1 " | 107053-0-01 | | | | | | |
| E-31 | Zigzag Regulator Control Plate | 1 " | 107262-0-01 | | | | | | |
| E-32 | Set Screw for E-31 | 1 " | 107263-0-01 | | | | | | |
| E-33 | Set Screw for E-34 | 3 pcs. | 107274-0-01 | | | | | | |
| E-34 | Zigzag Regulator Body | 1 pce. | 107273-0-01 | | | | | | |
| E-35 | Position Screw for E-34 | 1 " | 107275-0-01 | | | | | | |
| E-36 | Spring Sustainer (B) for E-56 | 1 " | 107271-0-01 | | | | | | |
| E-37 | Set Screw for E-36 | 2 pcs. | 107272-0-01 | | | | | | |
| E-38 | Nut for E-42 | 1 pce. | 107266-0-01 | | | | | | |
| E-39 | Spring Washer E-38 | 1 " | 101046-0-03 | 10196609 | 114290 | | | | |
| E-40 | Spring for E-41 | 1 " | 107267-0-01 | | | | | | |
| E-41 | Zigzag Regulator Control Claw | 1 " | 107264-0-01 | | | | | | |
| E-42 | Stud Screw for E-41 | 1 " | 107265-0-01 | | | | | | |
| E-43 | Zigzag Slide Brace | 1 " | 107258-0-01 | | | | | | |
| E-44 | Ball Stud Screw for E-45 | 2 pcs. | 107285-0-01 | | | | | | |

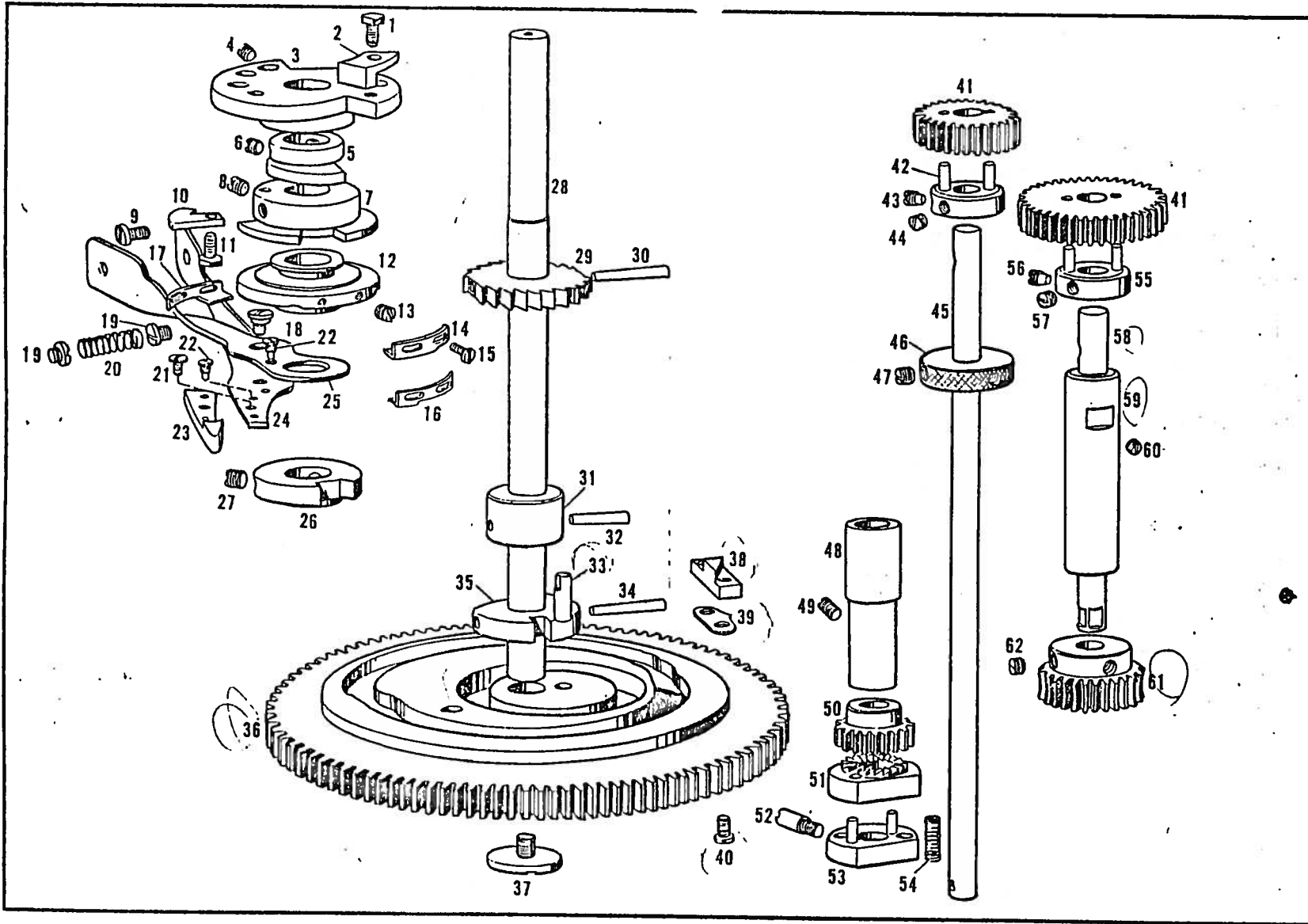

| Ref. No. | Name of Parts | Q'ty | Parts No. | Assembly No. | Ref. No. | Name of Parts | Q'ty | Parts No. | Assembly No. |
|----------|--|--------|-------------|--------------|----------|-----------------------------------|--------|-------------|--------------|
| F-1 | Bolt for F-2 | 1 pce. | 107357-0-01 | | F-41 | Transverse Gear 24 | 1 pce. | 108821-0-01 | |
| F-2 | Zigzag Transverse Cam Segment | 1 / | 107356-0-01 | | F-41 | Transverse Gear 46 | 1 / | 108822-0-01 | |
| F-3 | Zigzag Transverse Cam | 1 / | 107354-0-01 | 107179-0-01 | F-41 | Transverse Gear 30 | 1 / | 107340-0-00 | |
| F-4 | Set Screw for F-3 | 2 pcs. | 107045-0-01 | | F-41 | Transverse Gear 40 | 1 / | 107341-0-00 | |
| F-5 | Cutter Cam | 1 pce. | 107358-0-01 | | F-41 | Transverse Gear 28 | 1 / | 108823-0-01 | |
| F-6 | Set Screw for F-5 | 2 pcs. | 100289-0-01 | | F-41 | Transverse Gear 32 | 1 / | 108824-0-00 | |
| F-7 | Zigzag Regulator Cam | 1 pce. | 107360-0-01 | | F-41 | Transverse Gear 34 | 1 / | 108825-0-00 | |
| F-8 | Set Screw for F-7 | 1 / | 100013-0-03 | | F-41 | Transverse Gear 36 | 1 / | 108826-0-00 | |
| F-9 | Set Screw for F-7 | 1 / | 107362-0-02 | | F-41 | Transverse Gear 38 | 1 / | 108827-0-00 | |
| F-10 | Zigzag Regulator Cam Segment | 1 / | 107363-0-01 | | F-41 | Transverse Gear 42 | 1 / | 108828-0-00 | |
| F-11 | Bolt for F-10 | 1 / | 107357-0-01 | | F-41 | Transverse Gear 44 | 1 / | 108829-0-00 | |
| F-12 | Thread Tension Release Cam | 1 / | 107365-0-01 | | F-41 | Transverse Gear 46 | 1 / | 108830-0-00 | |
| F-13 | Set Screw for F-12 | 2 pcs. | 100289-0-01 | | F-42 | Worm Wheel Shaft Collor Assembly | 1 / | 107136-0-01 | |
| F-14 | Thread Tension Release Cam Segment (A) | 1 pce. | 109736-0-01 | | F-43 | Set Screw for F-42 | 1 / | 107305-0-01 | |
| F-15 | Set Screw for F-14 & F-17 or F-16 | 4 pcs. | 100080-0-03 | | F-44 | Set Screw for F-42 | 1 / | 107306-0-01 | |
| F-16 | Thread Tension Release Cam Segment (C) | 1 pce. | 109738-0-03 | | F-45 | Gear Transverse Shaft | 1 / | 107323-0-01 | |
| F-17 | Thread Tension Release Cam Segment (B) | 1 / | 109737-0-01 | | F-46 | Knurled Ring for F-45 | 1 / | 107328-0-01 | |
| F-18 | Stud Screw for F-24 & F-25 | 1 / | 107373-0-01 | | F-47 | Set Screw for F-46 | 2 pcs. | 100013-0-01 | 181989-0-01 |
| F-19 | Guide Screw for F-20 | 2 pcs. | 107377-0-01 | | F-48 | Gear Transverse Bush | 1 pce. | 107342-0-01 | |
| F-20 | Spring for F-24 & 25 | 1 pce. | 107376-0-01 | | F-49 | Set Screw for F-48 | 1 / | 107343-0-01 | |
| F-21 | Set Screw for F-23 | 1 / | 100257-0-07 | 107224-0-01 | F-50 | Gear Transverse Shaft Pinion Gear | 1 / | 107335-0-01 | |
| F-22 | Stopper for F-24 & F-25 | 3 pcs. | 107370-0-01 | | F-51 | Gear Transverse Shaft Ratchet | 1 / | 107333-0-01 | |
| F-23 | Claw for F-24 | 1 pce. | 107374-0-01 | | F-52 | Set Screw for F-50 | 1 / | 107332-0-01 | |
| F-24 | Hand Ratchet Lever | 1 / | 107371-0-01 | | F-53 | Collar With Guide Pin for F-5 | 1 / | 107330-0-00 | |
| F-25 | Hand Lever | 1 / | 107369-0-01 | | F-54 | Spring for F-53 | 2 pcs. | 107334-0-01 | |
| F-26 | Upper Thread Scissor Cam | 1 / | 107380-0-01 | | F-55 | Worm Wheel Shaft Collar Assembly | 1 pce. | 107136-0-01 | |
| F-27 | Set Screw for F-26 | 2 pcs. | 100013-0-03 | | F-56 | Set Screw for F-55 | 1 / | 107305-0-01 | |
| F-28 | Cam Shaft | 1 pce. | 107352-0-01 | | F-57 | Set Screw for F-55 | 1 / | 107306-0-01 | |
| F-29 | Hand Ratchet | 1 / | 107378-0-01 | | F-58 | Worm wheel Shaft | 1 / | 107302-0-01 | |
| F-30 | Taper Pin for F-29 | 1 / | 107379-0-01 | | F-59 | Worm Wheel Shaft Bush | 1 / | 107307-0-01 | 181968-0-01 |
| F-31 | Cam Shaft Collar | 1 / | 107382-0-01 | | F-61 | Worm Wheel | 1 / | 107490-0-01 | |
| F-32 | Taper Pin for F-31 | 1 / | 107383-0-01 | | F-60 | Set Screw for F-57 | 1 / | 107308-0-01 | |
| F-33 | Knock Pin for E-36 | 1 / | 107345-0-01 | | F-62 | Set Screw for F-61 | 2 pcs. | 100251-0-01 | |
| F-34 | Taper Pin for F-35 | 1 / | 107351-0-01 | | | | | | |
| F-35 | Cam Shaft Gear Collar | 1 / | 107350-0-01 | | | | | | |
| F-36 | Cam Shaft Gear | 1 / | 108831-0-01 | | | | | | |
| F-37 | Set Screw for F-36 | 1 / | 107349-0-01 | | | | | | |
| F-38 | Stop Cam | 1 / | 107346-0-01 | | | | | | |
| F-39 | Washer for F-40 | 2 pcs. | 107778-0-01 | | | | | | |
| F-40 | Set Screw for F-38 | 2 / | 105173-0-02 | | | | | | |
| F-41 | Transverse Gear 22 | 1 pce. | 107336-0-00 | | | | | | |
| F-41 | Transverse Gear 48 | 1 / | 107337-0-00 | | | | | | |

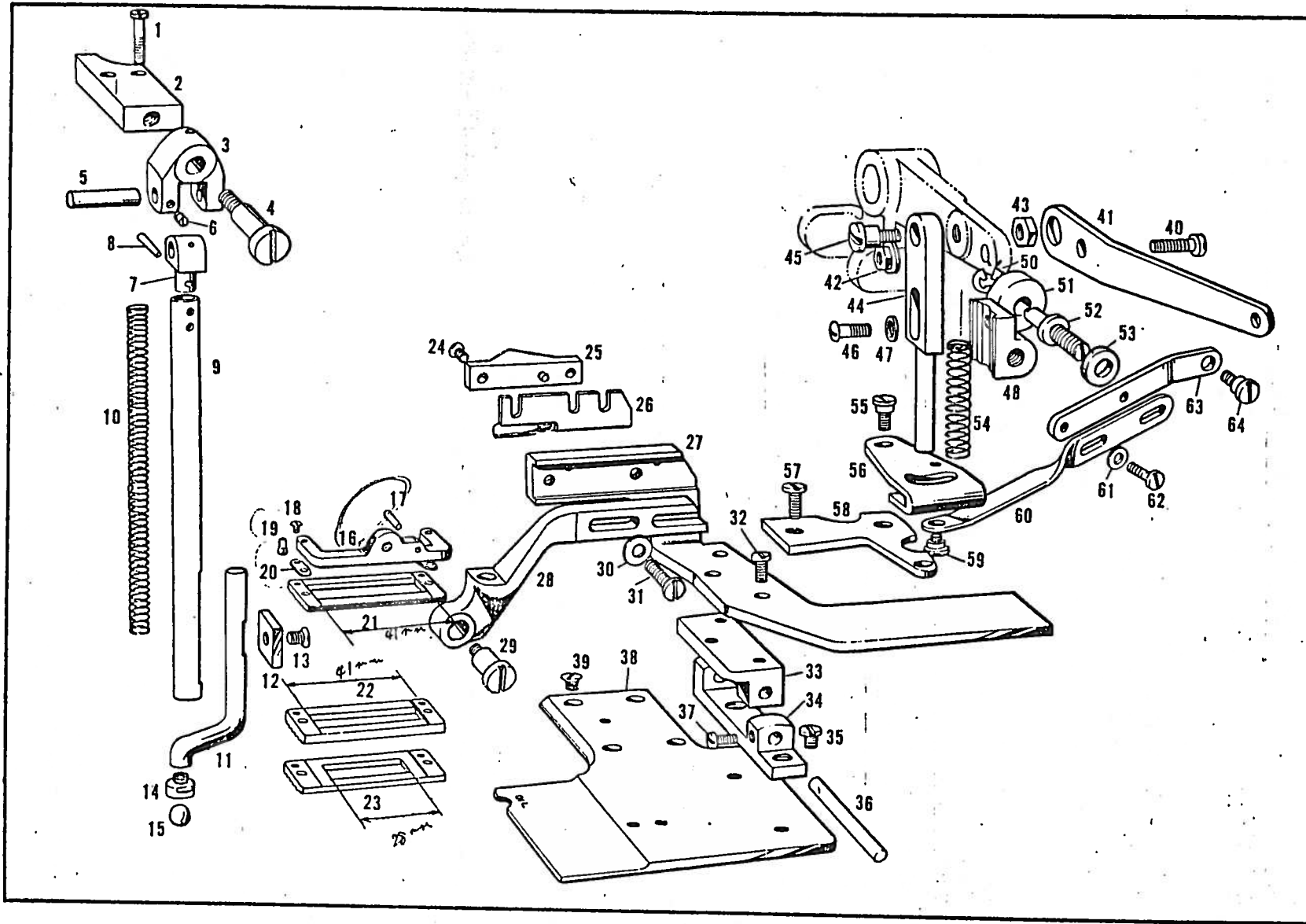

| Ref. No. | Name of Parts | Q'ty | Parts No. | Assembly No. | Ref. No. | Name of Parts | Q'ty | Parts No. | Assembly No. |
|----------|------------------------------------|--------|-------------|--------------|----------|-----------------------------|--------|-------------|--------------|
| G-1 | Set Screw for G-2 | 2 pcs. | 107385-0-01 | | G-46 | Set Screw for G-48 | 1 pce. | 107196-0-01 | |
| G-2 | Presser Bar Sleeve Hanger Bracket | 1 pce. | 107384-0-01 | | G-47 | Washer for G-46 | 1 // | 107348-0-01 | 107243-0-01 |
| G-3 | Presser Bar Sleeve Hanger | 1 // | 107386-0-01 | | G-48 | Supporter for G-52 | 1 // | 107430-0-01 | |
| G-4 | Stud Screw for G-3 | 1 // | 107387-0-01 | | G-50 | Stop ling | 1 // | 111825-0-01 | |
| G-5 | Presser Bar Sleeve Hinge Pin | 1 // | 107388-0-01 | | G-51 | Clamp Lift Roller | 1 // | 107425-0-01 | 180043-0-01 |
| G-6 | Set Screw for G-5 | 1 // | 104649-0-01 | 107233-0-01 | G-52 | Clamp Lift Roller Stud | 1 // | 107426-0-01 | |
| G-7 | Presser Bar Sleeve Hinge | 1 // | 107390-0-01 | | G-53 | Washer for G-52 | 1 // | 107427-0-01 | 107243-0-01 |
| G-8 | Tapar Pin for G-7 | 1 // | 115739-0-01 | | G-54 | Spring for G44 | 1 // | 107436-0-01 | |
| G-9 | Presser Bar Sleeve | 1 // | 107392-0-01 | | G-55 | Stud Screw for G-56 | 1 // | 107438-0-01 | |
| G-10 | Presser Spring | 1 // | 107393-0-01 | | G-56 | Clamp Lift Control Plate | 1 // | 107437-0-01 | |
| G-11 | Pressr Bar | 1 // | 107394-0-01 | | G-57 | Set Screw for G-58 | 1 // | 107440-0-01 | |
| G-12 | Presser Bar Yoke Plate | 1 // | 107396-0-01 | | G-58 | Supporter for G-54 | 1 // | 107439-0-01 | |
| G-13 | Set Screw for G-12 | 1 // | 107397-0-01 | | G-59 | Stud Screw for G-60 | 1 // | 107442-0-01 | |
| G-14 | Pressr Bar Ball Receiver | 1 // | 107395-0-01 | | G-60 | Clamp Control Crank Bar (A) | 1 // | 107441-0-01 | |
| G-15 | Presser Bar Ball | 1 // | 107398-0-01 | | G-61 | Washer for G-62 | 2 pcs. | 107348-0-01 | |
| G-16 | Supporter for G-21 | 1 // | 107400-0-01 | | G-62 | Set Screw for G-60 & G-63 | 2 // | 107407-0-02 | |
| G-17 | Stopper Pin for G-16 | 1 // | 107402-0-01 | | G-63 | Clamp Control Crank Bar (B) | 1 pce. | 107445-0-01 | |
| G-18 | Set Screw for G-20 | 2 pcs. | 107401-0-01 | 109660-0-01 | G-64 | Stud Screw for G-63 | 1 // | 107438-0-01 | |
| G-19 | Set Pin for G-16 | 2 // | 107403-0-01 | | | | | | |
| G-20 | Plate Spring for G-16 | 2 // | 107401-0-01 | | | | | | |
| G-21 | Upper Clamping Foot (A) | 1 pce. | 107399-0-01 | | | | | | |
| G-22 | Upper Clamping Foot (B) | 1 // | 107446-0-01 | | | | | | |
| G-23 | Upper Clamping Foot (C) | 1 // | 108833-0-01 | | | | | | |
| G-24 | Set Screw for G-25 | 1 // | 107413-0-01 | | | | | | |
| G-25 | Upper Thread Scissor Releasing Cam | 1 // | 107411-0-01 | | | | | | |
| G-26 | Upper Thread Scissor Lifter Plate | 1 // | 107410-0-01 | | | | | | |
| G-27 | Clamp Lifter | 1 // | 107409-0-01 | | | | | | |
| G-28 | Clamp Lever | 1 // | 107406-0-01 | | | | | | |
| G-29 | Stud Screw for G-16 | 1 // | 107405-0-01 | | | | | | |
| G-30 | Washer for G-31 | 2 pcs. | 107348-0-01 | | | | | | |
| G-31 | Set Screw for G-28 | 2 // | 107407-0-02 | | | | | | |
| G-32 | Set Screw for G-27 | 3 pcs. | 101629-0-02 | | | | | | |
| G-33 | Bracket for G-27 | 1 pce. | 107414-0-01 | | | | | | |
| G-34 | Clamp Lift Lever Yoke | 1 // | 107418-0-01 | 180042-0-01 | | | | | |
| G-35 | Set Screw for G-34 | 2 pce. | 107419-0-01 | | | | | | |
| G-36 | Shaft for G-33 | 1 pce. | 107416-0-01 | | | | | | |
| G-37 | Set Screw for G-36 | 1 // | 107135-0-01 | | | | | | |
| G-38 | Clamping Base Plate | 1 // | 107420-0-01 | | | | | | |
| G-39 | Set Screw for G-38 | 4 pcs. | 107421-0-01 | | | | | | |
| G-40 | Set Screw for G-41 | 1 pce. | 107428-0-02 | | | | | | |
| G-41 | Clamp Lift Lever | 1 // | 107422-0-01 | | | | | | |
| G-42 | Nut for G-40 | 1 // | 107424-0-01 | | | | | | |
| G-43 | Nut for G-45 | 1 // | 107114-0-01 | | | | | | |
| G-44 | Clamp Control Bar | 1 // | 107433-0-01 | 107243-0-01 | | | | | |
| G-45 | Stud Screw for G-44 | 1 // | 107434-0-01 | | | | | | |

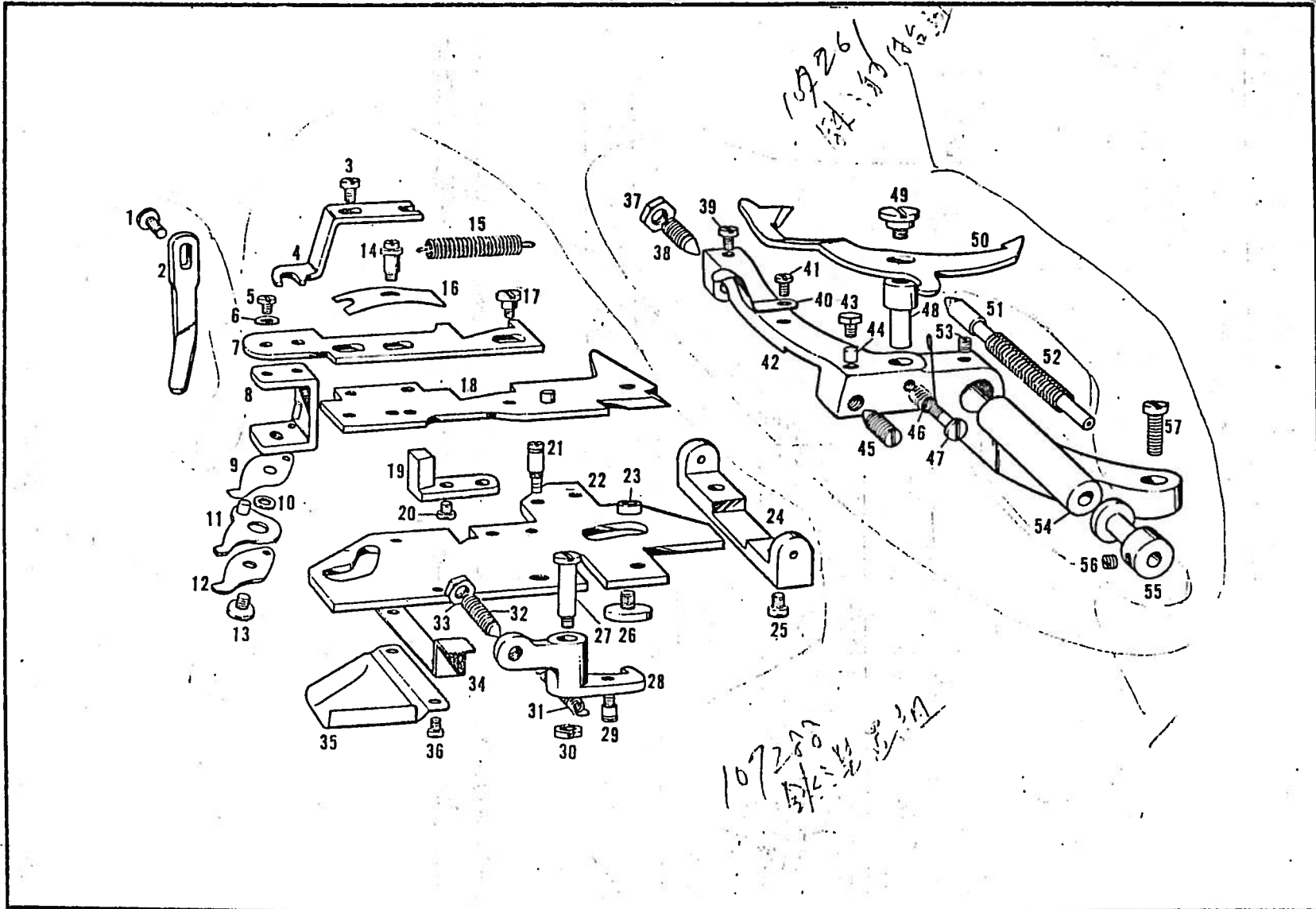

| Ref. No. | Name of Parts | Q'ty | Parts No. | Assembly No. | Ref. No. | Name of Parts | Q'ty | Parts No. | Assembly No. |
|----------|---|--------|-------------|--------------|--------------------|-----------------------------------|-------------|-------------|--------------|
| H-1 | Set Screw for H-2 | 1 pce. | 107407-0-02 | 107288-0-01 | H-45 | Centre Screw for H-42 (right) | 1 pce. | 107486-0-01 | 107261-0-01 |
| H-2 | Thread Scissor Device Guider | 1 " | 107527-0-01 | | H-46 | Spring for H-50 | 1 " | 107475-0-01 | |
| H-3 | Set Screw for H-4 | 2 pcs. | 107526-0-01 | | H-47 | Set Screw for H-48 | 1 " | 107474-0-01 | |
| H-4 | Thread Scissor Motion Shank | 1 pce. | 107525-0-01 | | H-48 | Fulcrum Stud for H-50 | 1 " | 107472-0-01 | |
| H-5 | Set Screw for H-8 | 2 pcs. | 105123-0-01 | | H-49 | Stud Screw for H-50 | 1 " | 107473-0-01 | |
| H-6 | Washer for H-5 | 2 " | 103847-0-03 | | H-50 | Thread Scissor Device Check Lever | 1 " | 107471-0-01 | |
| H-7 | Thread Scissor Slide Upper Plate | 1 pce. | 107509-0-01 | | H-51 | Thread Scissor Device Centre Rod | 1 " | 107477-0-01 | |
| H-8 | Thread Scissor Yoke | 1 " | 182215-0-01 | | H-52 | Spring for H-51 | 1 " | 107480-0-01 | |
| H-9 | Thread Scissor Upper Plate | 2 pcs. | 107522-0-01 | | H-53 | Set Screw for H-54 | 1 " | 104649-0-01 | |
| H-10 | Collar for H-11 | 1 pce. | 107523-0-01 | | H-54 | Thread Scissor Device Centre Bush | 1 " | 107481-0-01 | |
| H-11 | Thread Scissor Middle Blade | 1 " | 107519-0-01 | H-55 | Collar for H-51 | 1 " | 107478-0-01 | | |
| H-12 | Thread Scissor Lower Blade | 2 pcs. | 107518-0-01 | H-56 | Set Screw for H-55 | 1 " | 104649-0-01 | | |
| H-13 | Set Screw for H-9 H-11 & H-12 | 1 pce. | 107524-0-01 | H-57 | Set Screw for H-42 | 2 pcs. | 107470-0-01 | | |
| H-14 | Sustainer Screw for H-16 or H-18 | 1 " | 107512-0-01 | | | | | | |
| H-15 | Spring for H-7 & H-18 | 1 " | 107513-0-01 | | | | | | |
| H-16 | Plate Spring for H-7 | 1 " | 107511-0-01 | | | | | | |
| H-17 | Stud Screw for H-18 | 2 pcs. | 107510-0-01 | | | | | | |
| H-18 | Thread Scissor Slide Lower Plate | 1 pce. | 107507-0-01 | | | | | | |
| H-19 | Stopper for H-22 | 1 " | 107493-0-01 | | | | | | |
| H-20 | Set Screw for H-19 | 2 pcs. | 107494-0-01 | | | | | | |
| H-21 | Sustainer for H-31 or H-22 | 1 pce. | 107501-0-01 | | | | | | |
| H-22 | Thread Scissor Slide Base Plate | 1 " | 107492-0-01 | 107288-0-01 | | | | | |
| H-23 | Roller for H-22 | 2 pcs. | 107503-0-01 | | | | | | |
| H-24 | Thread Scissor Reciprocating Block | 1 pce. | 107485-0-01 | | | | | | |
| H-25 | Set Screw for H-24 | 2 pcs. | 107491-0-02 | | | | | | |
| H-26 | Set Screw for H-23 | 2 " | 107502-0-01 | | | | | | |
| H-27 | Stud Screw for H-28 | 1 pce. | 107496-0-01 | | | | | | |
| H-28 | Thread Scissor Slide Plate Backlash Stopper | 1 " | 107495-0-01 | | | | | | |
| H-30 | Nut for H-27 | 1 " | 107444-0-02 | | | | | | |
| H-29 | Sustainer for H-31 or H-28 | 1 " | 107500-0-01 | | | | | | |
| H-31 | Spring for H-28 | 1 " | 107499-0-01 | | | | | | |
| H-32 | Adjusting Screw for H-28 | 1 " | 107497-0-01 | | | | | | |
| H-33 | Nut for H-32 | 1 " | 107498-0-01 | | | | | | |
| H-34 | Thread Scissor Device Lift Latch | 1 " | 107504-0-01 | | | | | | |
| H-35 | Thread Scissor Device Lower Cover | 1 " | 107506-0-01 | | | | | | |
| H-36 | Set Screw for H-34 & H-35 | 2 pcs. | 107494-0-01 | | | | | | |
| H-37 | Nut for H-38 | 1 " | 100090-0-01 | | | | | | |
| H-38 | Centre Screw for H-42 (left) | 1 " | 100333-0-01 | | | | | | |
| H-39 | Stop Screw for H-50 | 1 " | 107476-0-01 | | | | | | |
| H-40 | Thread Scissor Device Plate Spring | 1 " | 107483-0-01 | | | | | | |
| H-41 | Set Screw for H-40 | 1 " | 100257-0-01 | 107261-0-01 | | | | | |
| H-42 | Thread Scissor Device Yoke | 1 " | 107469-0-01 | | | | | | |
| H-43 | Bolt for H-45 | 1 " | 107488-0-02 | | | | | | |
| H-44 | Pusher for H-43 | 1 " | 107487-0-00 | | | | | | |

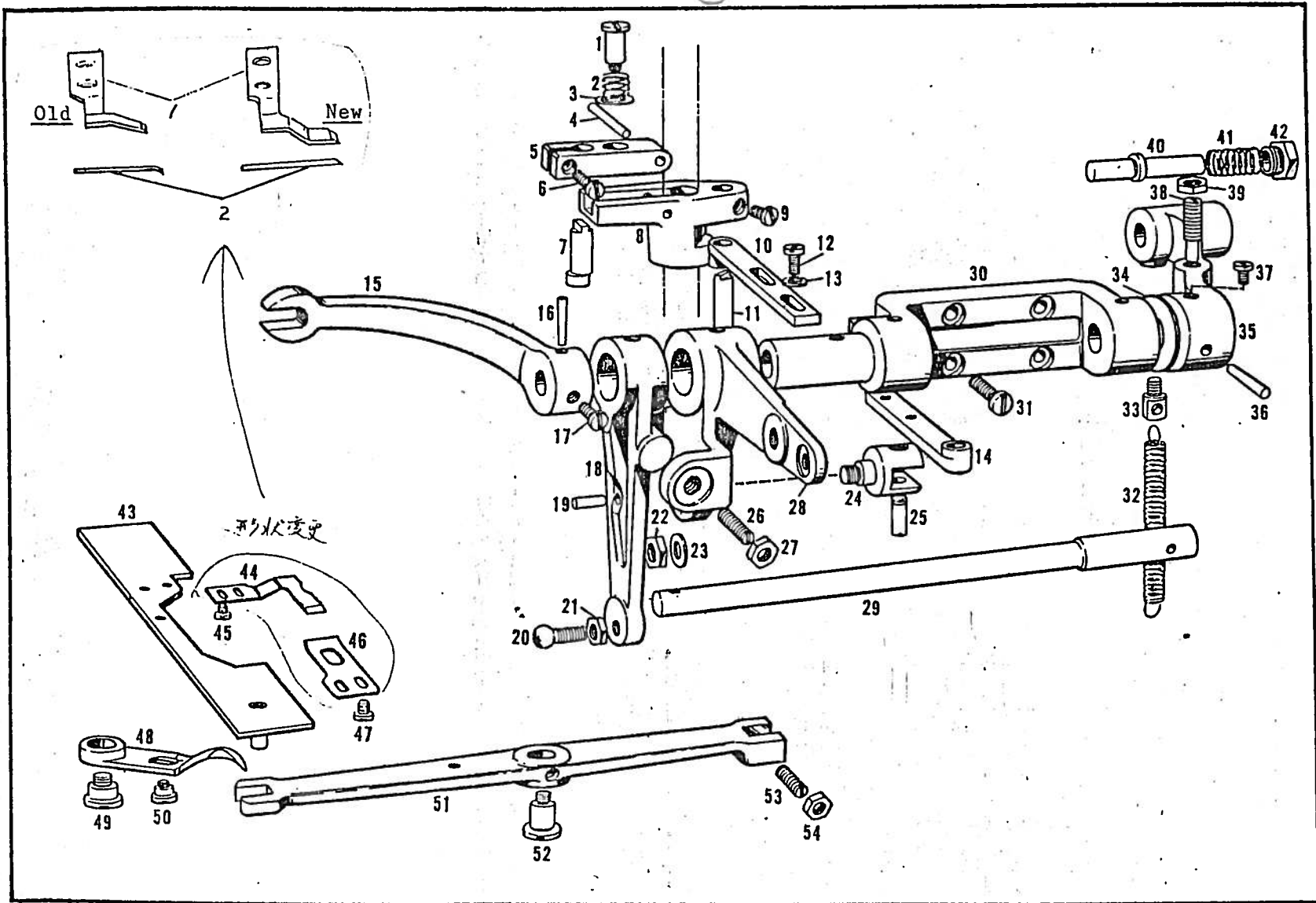

| Ref. No. | Name of Parts | Q'ty | Parts No. | Asset No. | Ref. No. | Name of Parts | Q'ty | Parts No. | As'y |
|----------|--|--------|-------------|-----------|----------|-----------------------------------|--------|-------------|------|
| I-1 | Stud Screw for I-2 ねじ | 1 pce. | 107467-0-01 | | I-43 | Lower Thread Cutter Slide Plate | 1 pce. | 107539-0-01 | |
| I-2 | Spring for I-5 ばね | 1 " | 107466-0-01 | | I-44 | Lower Thread Cutter Movable Blade | 2 pcs. | 107541-0-01 | |
| I-3 | Washer for I-2 ばね | 1 " | 107408-0-01 | | I-45 | Set Screw for I-44 | 2 " | 105288-0-03 | |
| I-4 | Pin for I-5 ねじ | 1 " | 107462-0-00 | 107257001 | I-46 | Lower Thread Cutter Fixed Blade | 1 pce. | 107546-0-01 | |
| I-5 | Thread Scissor Pushing Lever ばね | 1 " | 107461-0-01 | | I-47 | Set Screw for I-46 | 2 pcs. | 103961-0-00 | |
| I-6 | Clamp Screw for I-7 ねじ | 1 " | 107465-0-01 | ばね | I-48 | Lower Thriad Release I-48 ねじ | 1 pce. | 107543-0-01 | |
| I-7 | Roller Pin for I-5 ねじ | 1 " | 107463-0-01 | ねじ | I-49 | Stud Screw for I-48 | 1 " | 107544-0-01 | |
| I-8 | Thread Scissor Pushing Lever Body | 1 " | 107460-0-01 | ねじ | I-50 | Stud Screw for I-48 | 1 " | 107545-0-01 | |
| I-9 | Set Screw for I-11 ねじ | 1 " | 107459-0-01 | ねじ | I-51 | Lower Thread Cutter Lever | 1 " | 107535-0-01 | |
| I-10 | Upper Thread Cutter ねじ | 1 " | 107455-0-01 | | I-52 | Stud Screw for I-51 | 1 " | 107536-0-01 | |
| I-11 | Connecting Bar (B) | | | | I-53 | Stop Screw for I-51 | 1 " | 100016-0-03 | |
| I-11 | Hinge Pin for I-8 | 1 " | 107458-0-01 | | I-54 | Nut for I-53 | 1 " | 107114-0-01 | |
| I-12 | Set Screw for I-10 & I-14 ねじ | 2 pcs. | 101629-0-02 | | | | | | |
| I-13 | Washer for I-12 ねじ | 2 " | 103847-0-04 | | | | | | |
| I-14 | Upper Thread Cutter ねじ | 1 pce. | 107454-0-01 | | | | | | |
| I-14 | Connecting Bar (A) | | | | | | | | |
| I-15 | Upper Thread Tension Release Arm | 1 " | 107641-0-01 | | | | | | |
| I-16 | Taper Pin I-15 | 1 " | 107643-0-00 | | | | | | |
| I-17 | Set Screw for I-15 | 1 " | 107631-0-01 | | | | | | |
| I-18 | Lower Thread Cutter Motion Lever | 1 " | 107529-0-01 | | | | | | |
| I-19 | Pin for I-18 | 1 " | 107530-0-00 | | | | | | |
| I-20 | Ball Stud Screw for I-18 | 1 " | 107533-0-01 | | | | | | |
| I-21 | Nut for I-20 | 1 " | 107114-0-01 | | | | | | |
| I-22 | Nut for I-24 | 1 " | 107282-0-01 | | | | | | |
| I-23 | Washer for I-24 | 1 " | 107453-0-01 | | | | | | |
| I-24 | Upper Thread Cutter Crank Joint | 1 " | 107450-0-01 | ねじ | | | | | |
| I-25 | Pin for I-24 | 1 " | 107451-0-01 | | | | | | |
| I-26 | Adjusting Screw for I-28 | 2 pcs. | 107976-0-01 | | | | | | |
| I-27 | Nut for I-26 | 2 " | 107282-0-01 | | | | | | |
| I-28 | Upper Thread Cutter Lever | 1 pce. | 107449-0-01 | | | | | | |
| I-29 | Upper Thread Tension Release Lever Shaft | 1 " | 107628-0-01 | | | | | | |
| I-30 | Upper Thread Cutter Lever Bracket | 1 " | 107447-0-01 | | | | | | |
| I-31 | Set Screw for I-30 | 4 pcs. | 107423-0-01 | | | | | | |
| I-32 | Spring for I-35 | 1 pce. | 107638-0-01 | | | | | | |
| I-33 | Suspender on I-15 | 1 " | 107639-0-01 | | | | | | |
| I-34 | Washer for I-30 | 1 " | 107629-0-01 | | | | | | |
| I-35 | Upper Thread Tension Release Lever | 1 " | 107630-0-01 | | | | | | |
| I-36 | Taper Pin I-35 | 1 " | 107383-0-01 | | | | | | |
| I-37 | Set Screw for I-35 | 1 " | 107631-0-01 | | | | | | |
| I-38 | Adjusting Stopper for I-35 | 1 " | 107636-0-01 | | | | | | |
| I-39 | Nut for I-38 | 1 " | 107114-0-01 | | | | | | |
| I-40 | Pin for I-35 | 1 " | 107633-0-01 | | | | | | |
| I-41 | Spring for I-40 | 1 " | 107634-0-01 | | | | | | |
| I-42 | Cap Screw for I-41 | 1 " | 107635-0-01 | | | | | | |

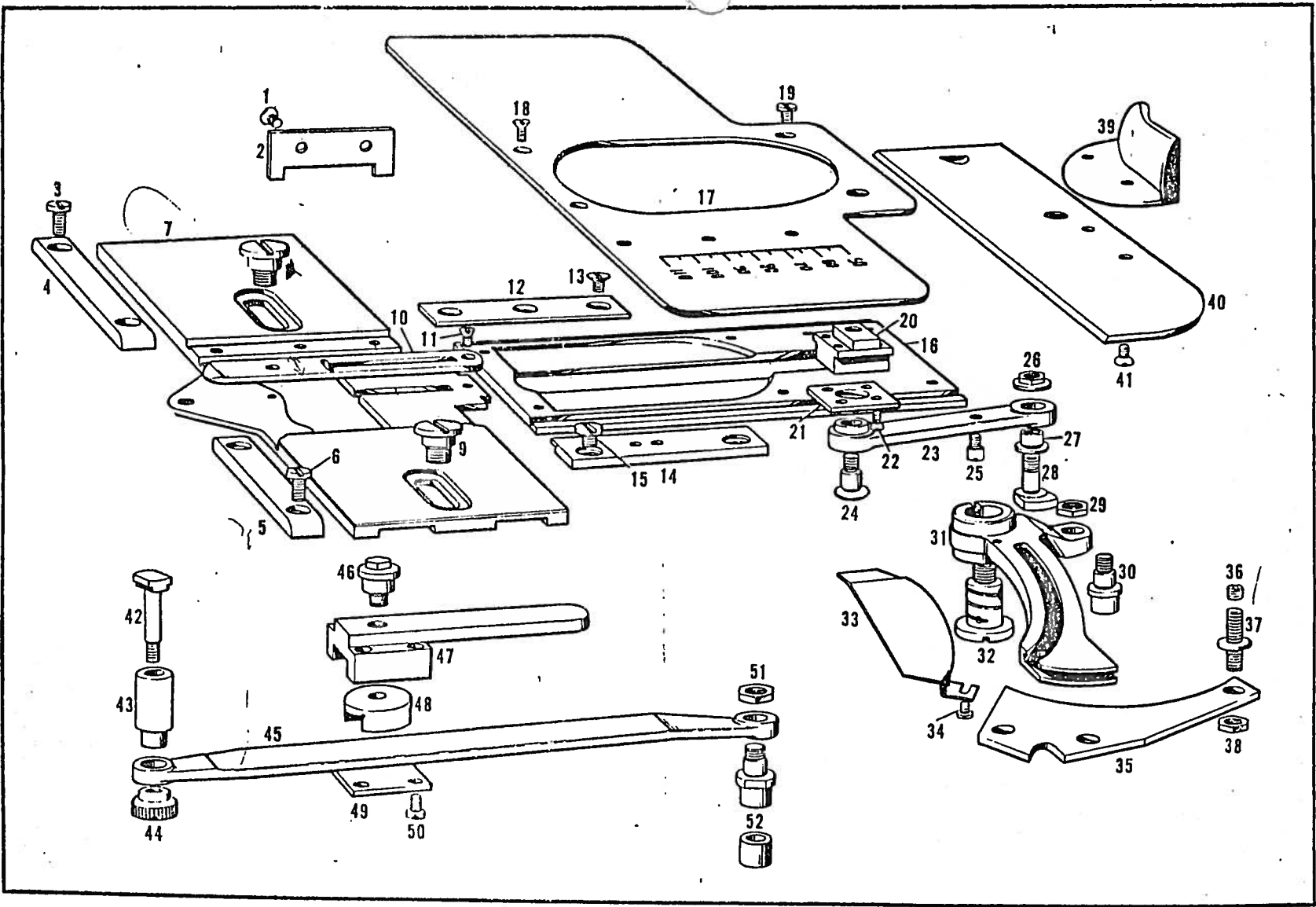

| Ref. No. | Name of Parts | Q'ty | Parts No. | Assembly No. | Ref. No. | Name of Parts | Q'ty | Parts No. | Assembly No. |
|----------|-----------------------------------|--------|-------------|--------------|----------|----------------------------------|--------|-------------|--------------|
| J-1 | Set Screw for J-2 | 2 pcs. | 107397-0-01 | | J-46 | Adjusting Screw for J-47 | 1 " | 107576-0-01 | |
| J-2 | Plate for K-33 | 1 pce. | 107600-0-01 | | J-47 | Width Feed Regulator | 1 pce. | 107573-0-01 | |
| J-3 | Set Screw for J-4 | 2 pcs. | 107407-0-02 | | J-48 | Width Feed Regulator Sleeve Slot | 1 " | 107572-0-01 | 180046-0-01 |
| J-4 | Feed Base Plate Guider (left) | 1 pce. | 107592-0-01 | | J-49 | Width Feed Regulator Cover | 1 " | 107574-0-01 | |
| J-5 | Feed Base Plate Guider (right) | 1 " | 107590-0-01 | | J-50 | Set Screw for J-49 | 4 pcs. | 107575-0-01 | |
| J-6 | Set Screw for J-5 | 2 pcs. | 107407-0-02 | | J-51 | Nut for J-52 | 1 pce. | 107114-0-01 | |
| J-7 | Feed Base Plate | 1 pce. | 107581-0-01 | | J-52 | Width Feed Roller With Stud | 1 " | 106003-0-01 | 180044-0-01 |
| J-9 | Stud Screw for J-7 | 2 pcs. | 107588-0-01 | | J-52 | Width Feed Roller Stud | 1 " | 107570-0-01 | |
| J-10 | Needle Plate (A) | 1 pce. | 107582-0-01 | | | | | | |
| J-10 | Needle Plate (B) | 1 pce. | 107583-0-01 | | | | | | |
| J-11 | Set Screw for Needle Plate | 2 pcs. | 107565-0-01 | | | | | | |
| J-12 | Length Feed Guide (left) | 1 pce. | 107586-0-01 | | | | | | |
| J-13 | Set Screw for J-12 | 3 pcs. | 107587-0-01 | | | | | | |
| J-14 | Length Feed Guide (right) | 1 pce. | 107584-0-01 | | | | | | |
| J-15 | Set Screw for J-14 | 2 pcs. | 107419-0-01 | | | | | | |
| J-16 | Length Feed Plate | 1 pce. | 107580-0-01 | | | | | | |
| J-17 | Feed Base Plate Cover | 1 " | 107591-0-01 | | | | | | |
| J-18 | Set Screw for J-17 | 2 pcs. | 107596-0-01 | | | | | | |
| J-19 | Set Screw for J-17 | 2 " | 108135-0-01 | | | | | | |
| J-20 | Length Feed Slide Block | 1 pce. | 107563-0-01 | | | | | | |
| J-21 | Cover for J-20 | 1 " | 107564-0-01 | | | | | | |
| J-22 | Set Screw for J-21 | 4 pcs. | 107596-0-01 | | | | | | |
| J-23 | Length Feed Link <i>to 9 3/4"</i> | 1 pce. | 107560-0-01 | | | | | | |
| J-24 | Stud Screw for J-23 | 1 " | 107562-0-01 | | | | | | |
| J-25 | Position Screw for K-33 or J-23 | 1 " | 107561-0-01 | | | | | | |
| J-26 | Nut for J-28 | 1 " | 107421-0-01 | | | | | | |
| J-27 | Bush for J-28 | 1 " | 107558-0-01 | | | | | | |
| J-28 | Length Feed Adjusting Stud | 1 " | 107557-0-01 | | | | | | |
| J-29 | Nut for J-30 | 1 " | 107114-0-01 | | | | | | |
| J-30 | Roller with Stud for J-31 | 1 " | 182803-0-01 | 10755000 | | | | | |
| J-31 | Length Feed Regulator | 1 " | 107518-0-01 | | | | | | |
| J-32 | Stud Screw for J-31 | 1 " | 107549-0-01 | 182217-0-01 | J-32 | | | | |
| J-33 | Cover for J-31 | 1 " | 107566-0-01 | | | | | | |
| J-34 | Set Screw for J-33 | 2 pcs. | 105288-0-03 | | | | | | |
| J-35 | Position Plate for J-31 | 1 pce. | 107553-0-01 | | | | | | |
| J-36 | Set Screw for J-37 | 3 pcs. | 107555-0-01 | | | | | | |
| J-37 | Stud Screw for J-35 | 3 " | 107554-0-01 | | | | | | |
| J-38 | Nut for J-37 | 3 " | 107556-0-02 | | | | | | |
| J-39 | Cam Shaft Cover | 1 pce. | 107598-0-01 | | | | | | |
| J-40 | Length Regulator Slide Plate | 1 " | 107597-0-01 | | | | | | |
| J-41 | Set Screw for J-39 | 2 pcs. | 107397-0-01 | | | | | | |
| J-42 | Width Feed Lever Stud Bush | 1 pce. | 107578-0-01 | | | | | | |
| J-43 | Width Feed Lever Stud | 1 " | 107577-0-01 | | | | | | |
| J-44 | Thumb Screw for J-42 | 1 " | 107251-0-01 | | | | | | |
| J-45 | Width Feed Lever | 1 " | 107568-0-01 | | | | | | |

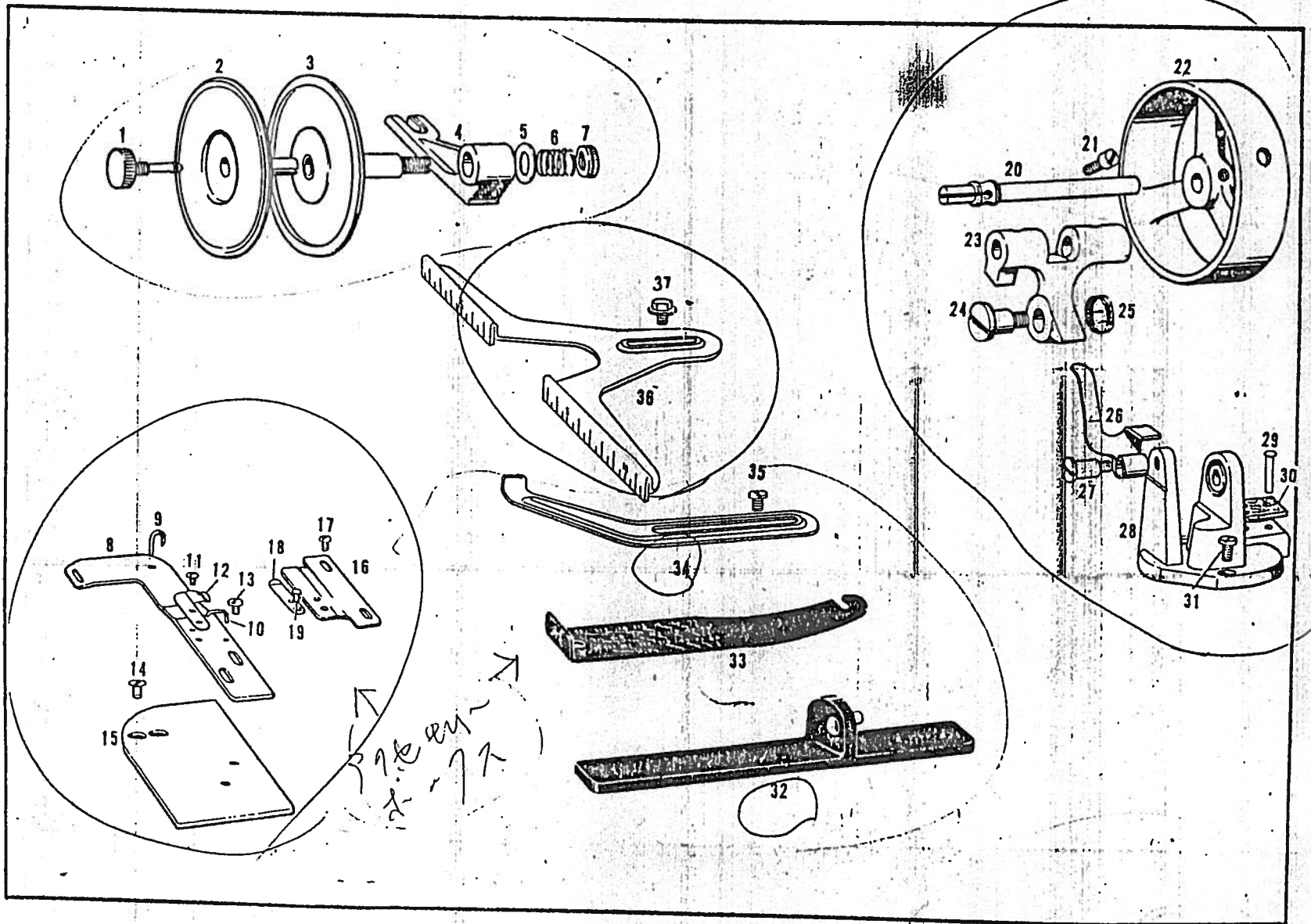

| Ref. No. | Name of Parts | Q'ty | Parts No. | Assembly No. | Ref. No. | Name of Parts | Q'ty | Parts No. | Assembly No. |
|----------|---|--------|-------------|--------------|----------|---------------|------|-----------|--------------|
| K-1 | Tape Winder Thumb Screw | 1 pce. | 108492-0-01 | | | | | | |
| K-2 | Tape Winder Flange Stud (B) | 1 / | 108487-0-01 | | | | | | |
| K-3 | Tape Winder Flange Stud (A) | 1 / | 108486-0-01 | | | | | | |
| K-4 | Tape Winder Holding Bracket | 1 / | 108493-0-01 | 108485-0-01 | | | | | |
| K-5 | Washer for K-3 | 1 / | 108494-0-01 | | | | | | |
| K-6 | Tape Winder Tension Spring | 1 / | 108495-0-01 | | | | | | |
| K-7 | Nut for K-3 | 1 / | 100136-0-01 | | | | | | |
| K-8 | Tape Guide Plate | 1 / | 107698-0-01 | | | | | | |
| K-9 | Tape Guide Side Wire (B) | 1 / | 107700-0-01 | | | | | | |
| K-10 | Tape Guide Side Wire (A) | 1 / | 107699-0-01 | | | | | | |
| K-11 | Set Screw for K-12 | 2 pcs. | 107703-0-02 | | | | | | |
| K-12 | Tape Guide Plate Spring for K-8 | 1 pce. | 107702-0-01 | 107361-0-01 | | | | | |
| K-13 | Set Screw for K-8 | 2 pcs. | 107491-0-02 | | | | | | |
| K-15 | Tape Guide Base Plate | 1 pce. | 107696-0-01 | | | | | | |
| K-14 | Set Screw for K-15 | 2 pcs. | 107697-0-01 | | | | | | |
| K-16 | Tape Needle Plate Guide | 1 / | 107704-0-01 | | | | | | |
| K-18 | Tape Guide Plate Spring for K-16 | 1 / | 107706-0-01 | 107364-0-01 | | | | | |
| K-19 | Pin for K-16 | 1 / | 107320-0-01 | | | | | | |
| K-17 | Set Screw for K-18 | 2 pcs. | 107703-0-02 | 系差轴 | | | | | |
| K-20 | Bobbin Winder Shaft | 1 pce. | 107670-0-01 | | | | | | |
| K-21 | Set Screw for K-22 | 1 / | 100025-0-01 | | | | | | |
| K-22 | Bobbin Winder Wheel | 1 / | 106014-0-01 | | | | | | |
| K-23 | Bobbin Winder Shaft Holding Bracket | 1 / | 107667-0-01 | | | | | | |
| K-24 | Stud Screw for K-23 | 1 / | 107668-0-01 | | | | | | |
| K-25 | Spring for K-23 | 1 / | 107669-0-01 | | | | | | |
| K-26 | Bobbin Holder 系差轴 | 1 / | 107673-0-01 | 107355-0-01 | | | | | |
| K-27 | Stud Screw for K-26 | 1 / | 106022-0-01 | | | | | | |
| K-28 | Bobbin Winder Body | 1 / | 107664-0-01 | | | | | | |
| K-29 | Pin for K-30 | 2 pcs. | 106027-0-00 | | | | | | |
| K-30 | Bobbin Winder Brake Leather | 1 pce. | 106025-0-01 | | | | | | |
| K-31 | Set Screw for K-28 | 2 pcs. | 105173-0-02 | | | | | | |
| K-32 | Position Plate for Plunge Spring Assembly | 1 set. | 107757-0-01 | | | | | | |
| K-33 | Length Feed Gauge | 1 pce. | 107776-0-01 | | | | | | |
| K-34 | Cloth Guide (A) | 1 / | 108530-0-01 | | | | | | |
| K-35 | Set Screw for K-34 | 2 pcs. | 108435-0-01 | | | | | | |
| K-36 | Cloth Guide (B) | 1 pce. | 107443-0-01 | | | | | | |
| K-37 | Set Screw for K-36 | 1 / | 107456-0-01 | | | | | | |

B812-24

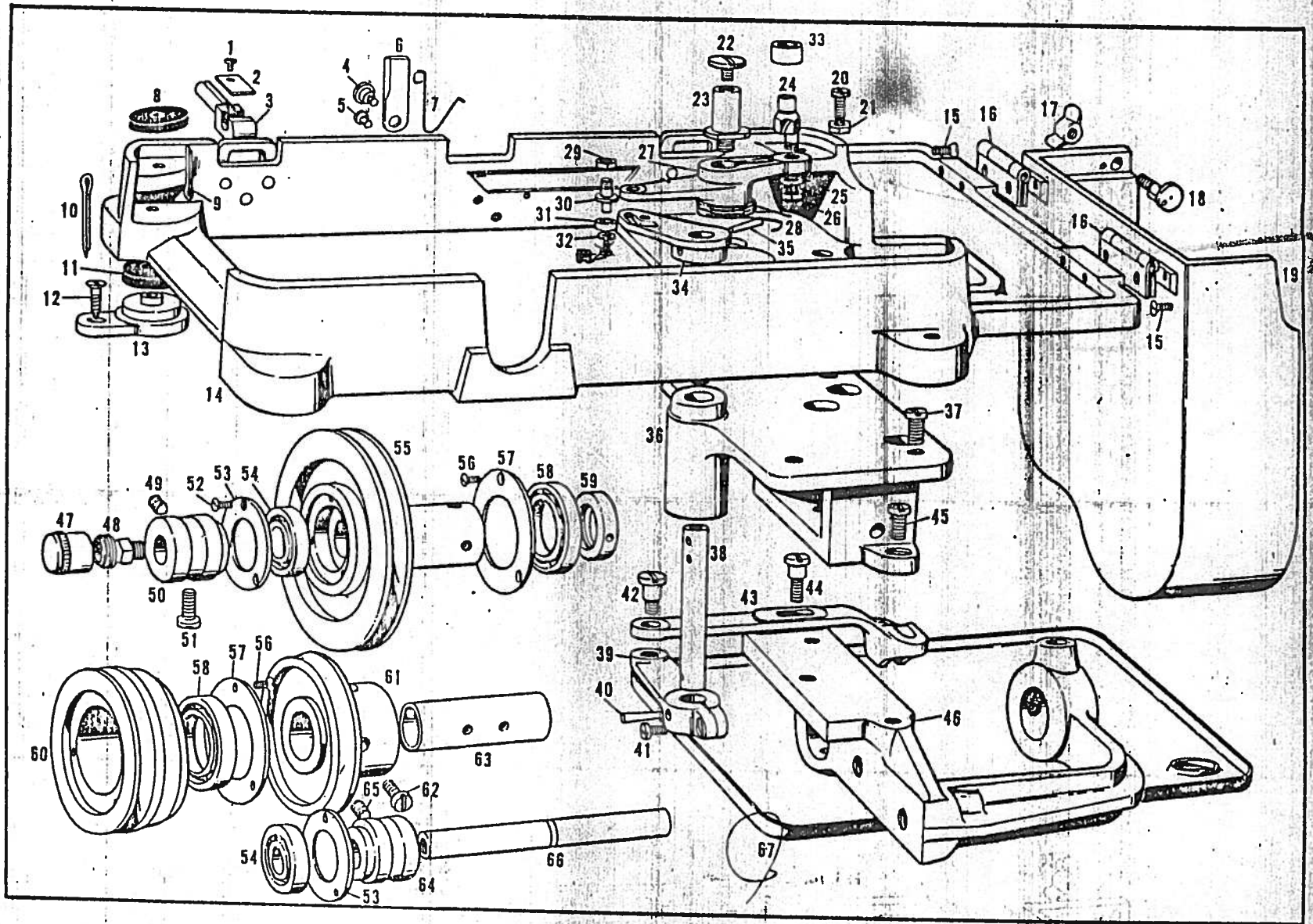

| Ref. No. | Name of Parts | Q'ty | Parts No. | Assembly No. | Ref. No. | Name of Parts | Q'ty | Parts No. | Assembly No. |
|----------|---------------------------------|--------|-------------|--------------|----------|--|--------|-------------|--------------|
| L-1 | Set Screw for L-2 | 2 pcs. | 105219-0-03 | | L-46 | Transmitter Shaft Frame (トランスミッターシャフト) | 1 pcc. | 107758-0-01 | |
| L-2 | Head Hook Plate | 2 " | 107718-0-01 | 180045-0-01 | L-47 | Cover for L-48 | 1 " | 107767-0-00 | |
| L-3 | Head Hook | 2 " | 107717-0-01 | | L-48 | Transmitter Shaft Grease Cup | 1 " | 107766-0-00 | |
| L-4 | Stud Screw for L-6 | 1 pcc. | 107721-0-01 | | L-49 | Set Screw for L-50 | 1 " | 100013-0-01 | |
| L-5 | Stop Screw for L-6 | 1 " | 100665-0-01 | | L-50 | Transmitter Bush (A) | 1 " | 107760-0-00 | 107389-0-01 |
| L-6 | Length Feed Gauge Presser Plate | 1 " | 107720-0-01 | | L-51 | Set Screw for L-66 | 1 " | 105351-0-02 | |
| L-7 | Notch Spring for L-6 | 1 " | 107723-0-01 | | L-52 | Set Screw for L-53 | 3 pcs. | 102843-0-01 | トランスミッター |
| L-8 | Lead Cushion | 4 pcs. | 107715-0-01 | | L-53 | Cover for L-55 | 2 pcs. | 107770-0-00 | |
| L-9 | Split Pin for L-8 | 4 " | 107716-0-00 | | L-54 | Ball Bearing for L-65 | 2 " | 107769-0-00 | |
| L-10 | Split Pin for L-11 | 4 " | 107714-0-00 | | L-55 | V Pulley Large for L-55 | 1 pcc. | 107768-0-00 | |
| L-11 | Base Cushion | 4 " | 107713-0-00 | | L-56 | Set Screw for L-57 | 3 pcs. | 102843-0-01 | |
| L-12 | Wood Screw for L-13 | 4 " | 100469-0-02 | | L-57 | Cover for L-60 | 2 pcs. | 107775-0-00 | |
| L-13 | Base Cover Shoe Base | 4 " | 107711-0-01 | | L-58 | Ball Bearing for L-60 | 2 " | 107759-0-00 | |
| L-14 | Cover Assembly | 1 set. | 107366-0-01 | | L-59 | Collar for L-58 | 1 pcc. | 107774-0-00 | |
| L-15 | Set Screw for L-16 | 8 pcs. | 107231-0-01 | | L-60 | Belt Pulley Small (A) (トランスミッター) | 1 " | 107772-0-00 | |
| L-16 | Belt Cover Hinges | 2 sets | 107372-0-01 | | L-61 | Belt Pulley Small (B) (トランスミッター) | 1 " | 107777-0-00 | |
| L-17 | Wing Nut for L-18 | 1 pcc. | 107727-0-01 | | L-62 | Set Screw for L-61 | 2 pcs. | 105173-0-01 | |
| L-18 | Belt Cover Stud Screw Assembly | 1 set. | 107368-0-01 | | L-63 | Transmitter Shaft Collar | 1 pcc. | 107781-0-00 | |
| L-19 | Belt Cover | 1 " | 107724-0-01 | | L-64 | Transmitter Bush (B) | 1 " | 107762-0-00 | |
| L-20 | Stop Screw for L-19 | 1 " | 107732-0-02 | | L-65 | Set Screw for L-64 | 1 " | 100013-0-01 | |
| L-21 | Nut for L-20 | 2 pcs. | 107733-0-01 | | L-66 | Transmitter Shaft | 1 " | 107764-0-01 | |
| L-22 | Cap Screw for L-23 | 1 " | 105155-0-01 | | L-67 | Oil Pan | 1 " | 107457-0-01 | |
| L-23 | Belt Shift Lever Stud | 1 pcc. | 107736-0-00 | | | | | | |
| L-24 | Roller Stud for L-27 (large) | 1 " | 107739-0-00 | | | | | | |
| L-25 | Washer for L-24 | 1 " | 101109-0-02 | | | | | | |
| L-26 | Nut for L-24 | 1 " | 100090-0-03 | 107375-0-01 | | | | | |
| L-27 | Belt Shift Lever | 1 " | 107738-0-01 | | | | | | |
| L-29 | Nut for L-30 | 1 " | 107282-0-01 | | | | | | |
| L-30 | Roller Stud for L-27 (small) | 1 " | 107743-0-01 | | | | | | |
| L-31 | Roller for L-27 | 1 " | 107744-0-01 | 180048-0-01 | | | | | |
| L-32 | Stop Ring | 1 " | 402650-0-01 | | | | | | |
| L-33 | Roller for L-24 | 1 " | 100084-0-01 | 107375-0-01 | | | | | |
| L-28 | Spring for L-27 | 1 " | 107756-0-01 | | | | | | |
| L-34 | Belt Guide Cam Plate | 1 " | 107748-0-01 | | | | | | |
| L-35 | Taper Pin for L-34 | 1 " | 107749-0-00 | | | | | | |
| L-36 | Transmitter Base | 1 " | 107731-0-01 | | | | | | |
| L-37 | Set Screw for L-36 | 4 pcs. | 107311-0-01 | | | | | | |
| L-38 | Shaft for L-39 | 1 pcc. | 107750-0-00 | | | | | | |
| L-39 | Belt Shift Arm | 1 " | 107751-0-01 | | | | | | |
| L-40 | Taper Pin for L-39 | 1 " | 107752-0-00 | | | | | | |
| L-41 | Clamp Screw for L-39 | 1 " | 107753-0-02 | | | | | | |
| L-42 | Stop Screw for L-39 | 1 " | 107754-0-01 | | | | | | |
| L-43 | Self Shifter | 1 " | 107755-0-01 | | | | | | |
| L-44 | Stud Screw for L-43 | 1 " | 108811-0-01 | | | | | | |
| L-45 | Set Screw for L-49 | 3 pcs. | 107311-0-01 | | | | | | |