

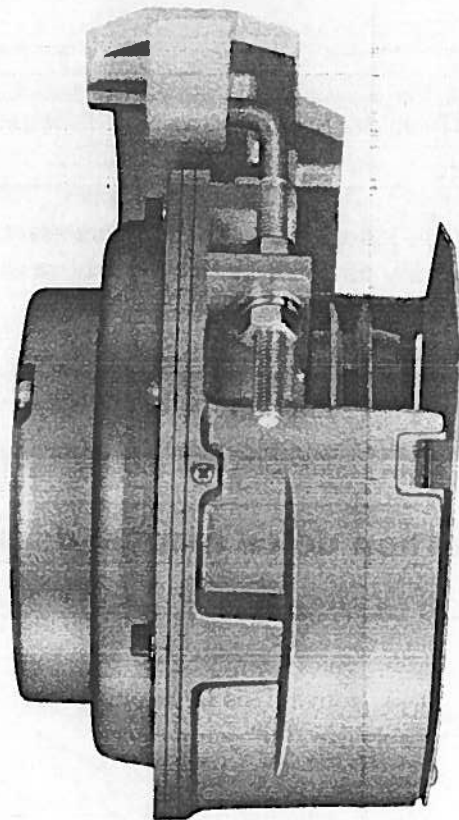

PARTS BOOK
FOR
BROTHER MD-952



Print Motor.

BROTHER INDUSTRIES, LTD.
NAGOYA, JAPAN



Notes for using this parts book

1. If the symbol  is found in the "Parts No." column or the "Assembly No." column, refer to the different parts list on page 6.
2. The symbol  in the "Parts No." column indicates that the parts is not available for supply. If, however, there is a number in the "Assembly No." column, the parts can be ordered as an assembly. Please, therefore, order by using the Assembly No.
3. This book was prepared based on information available in June 1981.
4. Parts are subject to changes in design without prior notice.

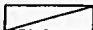
Anmerkungen zum Gebrauch dieses Stücklistebuches

1. Dieses Zeichen  in der Spalte "Parts No. (Teilnummer)" oder "Assembly No. (Gerätesatznummer)" verweist auf die Gesonderte Stückliste auf Seite 6.
2. Dieses Zeichen  in der Spalte "Teilnummer" bedeutet, daß dieser Teil nicht lieferbar ist. Wenn Jedoch in der Spalte "Gerätesatznummer" eine Nummer steht, kann dieser Teil als ein Geräteteilsatz bestellt werden. Bestellen Sie daher bitte mit dieser Gerätesatznummer.
3. Dieses Buch basiert auf den Informationen vom Juni 1981.
4. Modelländerungen sind vorbehalten.

Notes sur l'utilisation de ce manuel de pièces détachées

1. Si le symbole  se trouve dans la colonne "Parts No. (N° de pièce)" ou dans la colonne "Assembly No. (N° jeu de pcs)", veuillez vous référer à la liste de pièces annexe page 6.
2. Le symbole  dans la colonne "N° de pièce" signifie que la pièce ne peut être fournie. Si, dans la colonne "N° jeu de pcs", il y a un numéro de nomenclature, la pièce peut être commandée comme faisant partie d'un jeu de pièces. Donc, pour toute commande, veuillez spécifier le N° de jeu de pièces.
3. Ce manuel a été fait d'après les renseignements valables au mois de Juin 1981.
4. Les pièces peuvent être sujettes à des modifications sans préavis.

Notas para usar este Libro de Piezas

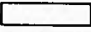
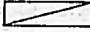
1. De haber un símbolo  junto al "Parts No. (Número de Pieza)" o en la columna del "Assembly No. (Número de Juego)" ' habrá que mirar la lista de piezas separada de la página 6.
2. El símbolo  , que se encuentra en la columna del "Número de Pieza", quiere decir que no se dispone de dicha pieza sola. Cuando, empero, hay un número en la columna del "Numero de Juego", se podrá ordenar la pieza con todo el juego. Por lo tanto, será mejor hacer el pedido recurriendo al número del juego respectivo.
3. Este libro ha sido compilado basándose en los datos de que se disponía en Junio de 1981.
4. Las piezas quedan sujetas a cambios de diseño sin aviso previo.

CONTENS

| | |
|-----------------------------------------------|---|
| A. Operation Panel | 1 |
| B. Synchronizer | 2 |
| C. Control Box 1 (Lever Parts Assembly) | 3 |
| C. Control Box 2 | 4 |
| D. Magnet Direct Current Motor | 5 |
| DIFFERENT PARTS LIST | 6 |
| INDEX | 7 |

A. Operation Panel

DB2-B715·B792 (Frontier)

DB2-B715·B792 (Frontier S)

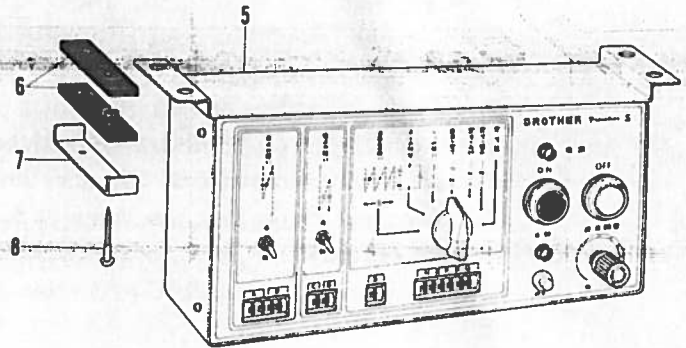
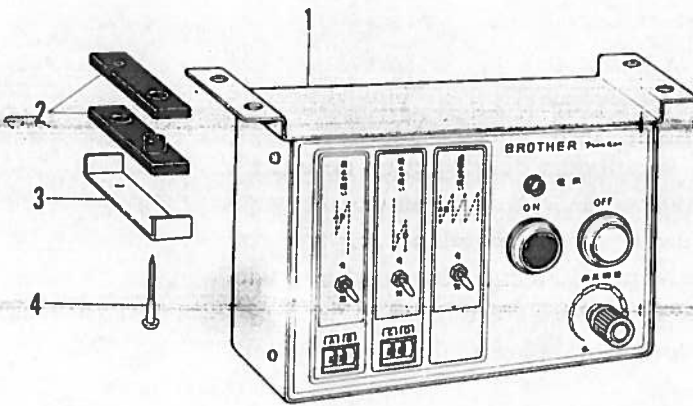

| Ref. No. | Name of Parts | Q'ty | Parts No. | Assembly No. | Ref. No. | Name of Parts | Q'ty | Parts No. | Assembly No. |
|----------|----------------------------|------|-------------|--------------|----------|----------------------------|------|-------------|--------------|
| A-1 | IMBTC BOX #9315 | 1 | 222230-0-01 | | A-5 | IMBTC BOX # 93106 | 1 | 222255-0-01 | |
| A-2 | Vibration Absorbing Rubber | 4 | | | A-6 | Vibration Absorbing Rubber | 4 | | |
| A-3 | Rubber Holder #2 | 2 | 222254-0-01 | | A-7 | Rubber Holder #2 | 2 | 222254-0-01 | |
| A-4 | Screw | 4 | 032423-8-06 | | A-8 | Screw | 4 | 032423-8-06 | |

LT2-B835-900 (Frontier C)

LT2-B833 (Frontier P Frontier PV)

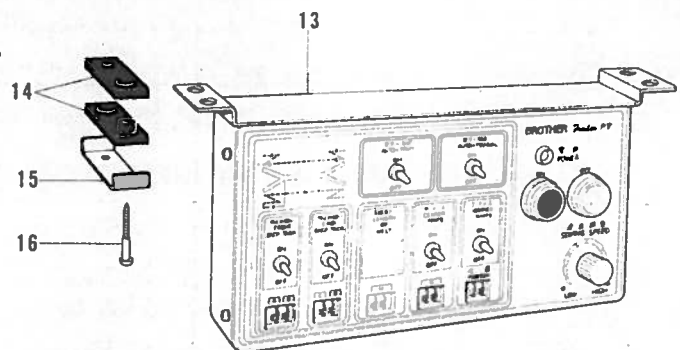
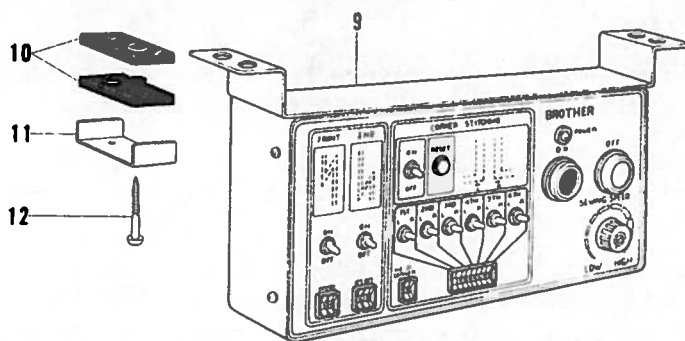

| Ref. No. | Name of Parts | Q'ty | Parts No. | Assembly No. | Ref. No. | Name of Parts | Q'ty | Parts No. | Assembly No. |
|----------|----------------------------|------|-------------|--------------|----------|----------------------------|------|-------------|--------------|
| A-9 | IMBTC BOX | 1 | 222865-0-01 | | A-13 | IMBTC BOX | 1 | | |
| A-10 | Vibration Absorbing Rubber | 4 | | | A-14 | Vibration Absorbing Rubber | 4 | | |
| A-11 | Rubber Holder | 2 | 222254-0-01 | | A-15 | Rubber Holder | 2 | 222254-0-01 | |
| A-12 | Screw | 4 | 032423-8-06 | | A-16 | Screw | 4 | 032423-8-06 | |

B. Synchronizer

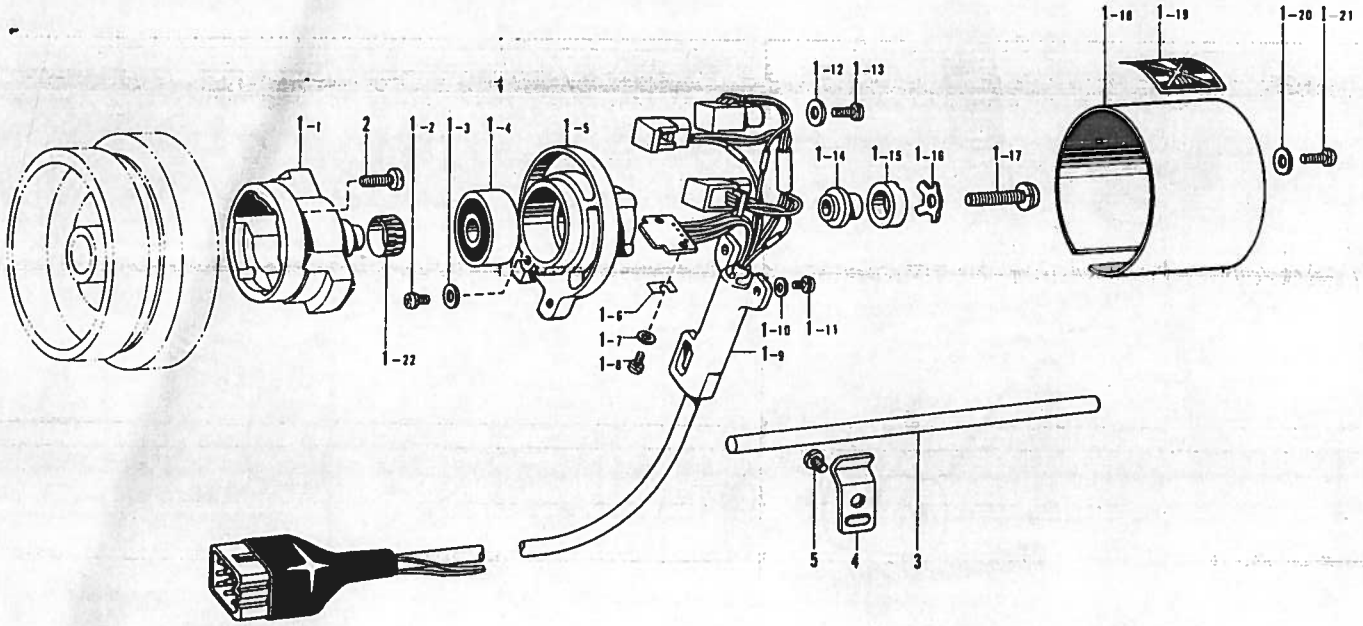

| Ref. No. | Name of Parts | Q'ty | Parts No. | Assembly No. | Ref. No. | Name of Parts | Q'ty | Parts No. | Assembly No. |
|----------|-------------------------------|------|-------------|---------------------------------------------------|----------|----------------------------|------|-------------|---------------------------------------------------|
| B-1-1 | Magnet Stud Assembly | 1 | | B-1 Synchronizer Assembly #7 222370-0-01 | B-1-14 | Magnet Stand | 1 | 219557-0-00 | B-1 Synchronizer Assembly #7 222370-0-01 |
| B-1-2 | Screw 3 x 6D | 1 | 215083-0-01 | | B-1-15 | Magnet 12 x 18.7 x 6 | 1 | 219558-0-00 | |
| B-1-3 | Washer 3 | 1 | 025030-3-35 | | B-1-16 | Presser Plate | 1 | 219559-0-00 | |
| B-1-4 | Bearing | 1 | | | B-1-17 | Screw 6 x 25D | 1 | 221421-0-01 | |
| B-1-5 | Hole IC Holder #3 | 1 | | | B-1-18 | Synchronizer Cover #3 | 1 | | |
| B-1-6 | Adjusting Plate | 3 | 219696-0-00 | | B-1-19 | Level #2 | 1 | | |
| B-1-7 | Washer 3 | 2 | 025030-1-35 | | B-1-20 | Washer 4 | 2 | 025040-3-35 | |
| B-1-8 | Screw 3 x 6D | 2 | 215083-0-01 | | B-1-21 | Screw 4 x 10D | 1 | 215080-0-01 | |
| B-1-9 | Hole IC with Cord Assembly #3 | 1 | 222371-0-01 | | B-1-22 | Level | 1 | | |
| B-1-10 | Washer 4 | 2 | 025040-1-35 | | B-2 | Screw 4.76 x 14 | 2 | 009711-4-12 | |
| B-1-11 | Screw 4 x 10D | 2 | 215080-0-01 | | B-3 | Synchronizer Holder Bar #2 | 1 | 218944-0-01 | |
| B-1-12 | Washer 4 | 3 | 025040-3-35 | | B-4 | Holder | 1 | 216332-0-01 | |
| B-1-13 | Screw 4 x 12D | 3 | 217093-0-01 | | B-5 | Screw 6.35 x 14 | 1 | 009781-4-12 | |

C. Control Box 1 (Lever Parts Assembly)

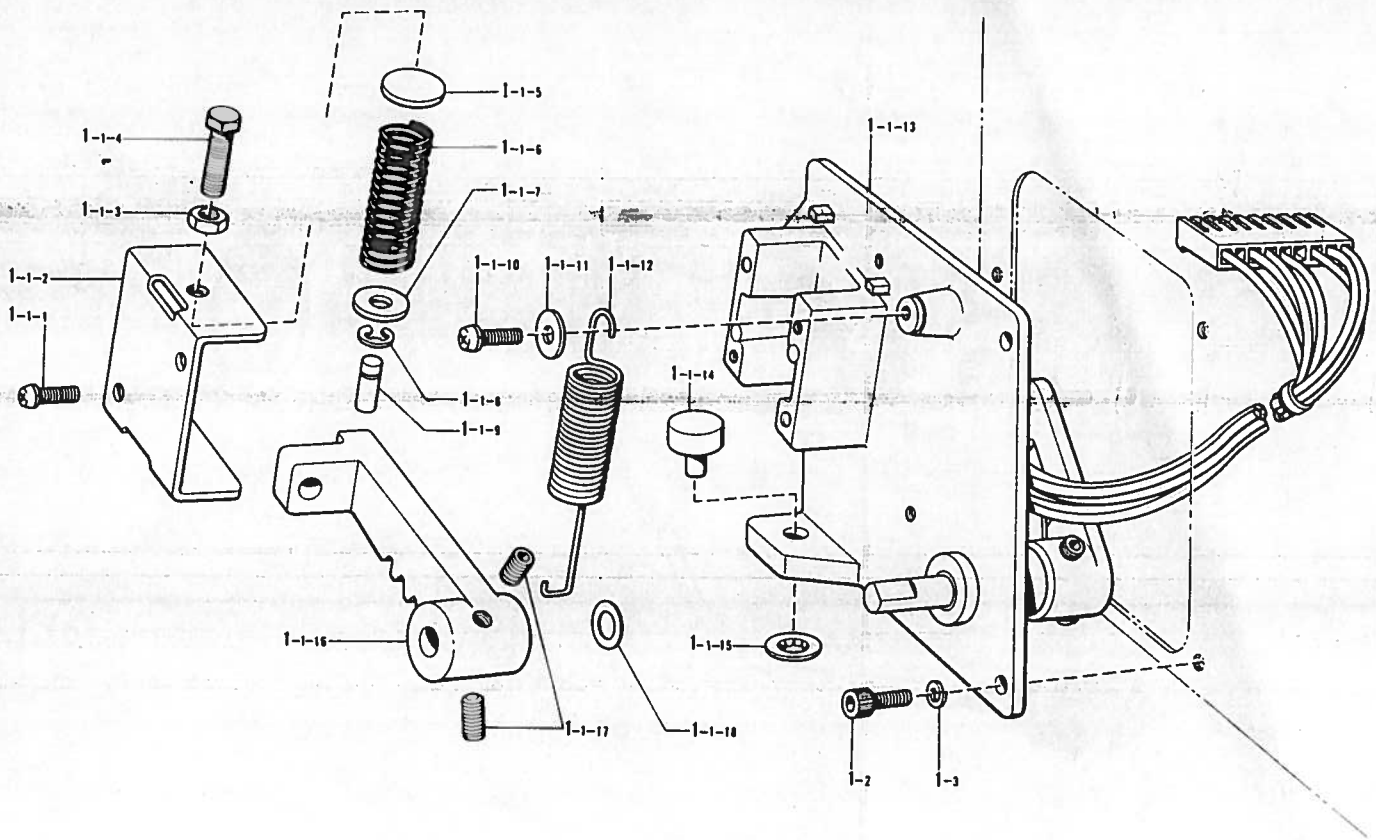

| Ref. No. | Name of Parts | Q'ty | Parts No. | Assembly No. | Ref. No. | Name of Parts | Q'ty | Parts No. | Assembly No. |
|----------|-----------------------|------|-------------|----------------------------------------------------|----------|---------------------|------|-------------|----------------------------------------------------|
| C-1-1-1 | Screw 4 x 12D | 2 | 217093-0-01 | C-1-1 Lever Parts Assembly #2 222329-0-01 | C-1-1-11 | Washer 4 | 1 | 025040-3-35 | C-1-1 Lever Parts Assembly #2 222329-0-01 |
| C-1-1-2 | Bracket | 1 | 222341-0-01 | | C-1-1-12 | Spring #2 | 1 | 222338-0-01 | |
| C-1-1-3 | Nut 6 | 1 | 021060-3-05 | | C-1-1-13 | Supporter #2 | 1 | | |
| C-1-1-4 | Bolt 6 x 16 | 1 | 213913-0-01 | | C-1-1-14 | Stopper #2 | 1 | 222339-0-01 | |
| C-1-1-5 | Washer 1.6 x 15.8 | 1 | 216235-0-00 | | C-1-1-15 | Ring 5 | 1 | 222340-0-01 | |
| C-1-1-6 | Spring 1.6 x 15 x 39 | 1 | 222343-0-01 | | C-1-1-16 | Lever | 1 | 219529-0-01 | |
| C-1-1-7 | Washer 1 x 5 x 15.5ST | 1 | 222566-0-01 | | C-1-1-17 | Screw 6 | 2 | 014061-0-22 | |
| C-1-1-8 | Stop Ring E4 | 1 | 048040-3-46 | | C-1-1-18 | Ring 0.5 x 8 x 12Ny | 1 | 219126-0-01 | |
| C-1-1-9 | Shaft Pin #2 | 1 | 222342-0-00 | | C-1-2 | Bolt 4 x 10 | 3 | 018401-0-22 | |
| C-1-1-10 | Screw 4 x 12D | 1 | 217093-0-01 | | C-1-3 | Spring Washer 2-4 | 3 | 028040-2-43 | |
| | | | | | | | | | C-1 Control Box Assembly |

C. Control Box 2

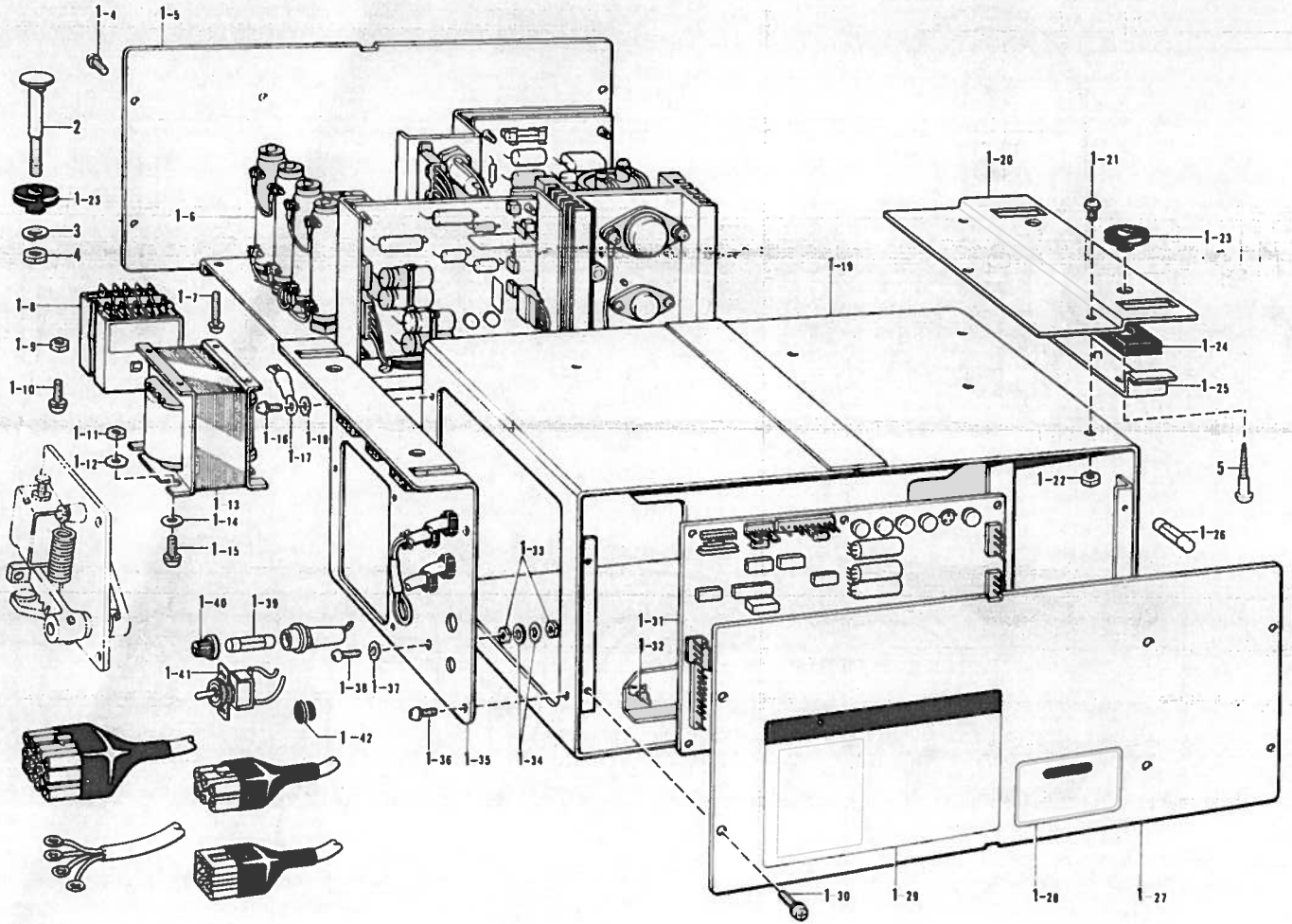

| Ref. No. | Name of Parts | Q'ty | Parts No. | Assembly No. | Ref. No. | Name of Parts | Q'ty | Parts No. | Assembly No. |
|----------|----------------------------------|------|-------------|--------------------------------|----------|----------------------------------|------|-------------|--------------------------------|
| C-1-4 | Screw 4 x 10D | 6 | 222560-0-01 | C-1 Control Box Assembly | C-1-26 | Fuse 8A | 1 | 219225-0-00 | C-1 Control Box Assembly |
| C-1-5 | Control Box Front Cover Plate #2 | 1 | 222287-0-01 | | C-1-27 | Control Box Front Cover Plate #2 | 1 | 222287-0-01 | |
| C-1-6 | Drive Unit | 1 | 221112-0-01 | | C-1-28 | Label | 1 | | |
| C-1-7 | Screw | 4 | 222567-0-01 | | C-1-29 | Label | 1 | | |
| C-1-8 | Power Source Relay | 1 | 219610-0-01 | | C-1-30 | Screw 4 x 10D | 6 | 222560-0-01 | |
| C-1-9 | Nut | 2 | 021400-0-05 | | C-1-31 | Printed Circuit Board | 1 | | |
| C-1-10 | Screw | 2 | 215087-0-01 | | C-1-32 | Holder #2 | 6 | 222321-0-01 | |
| C-1-11 | Nut 4 | 4 | 021400-2-05 | | C-1-33 | Nut 4 | 2 | 021400-2-63 | |
| C-1-12 | Washer | 4 | 025040-3-35 | | C-1-34 | Washer | 2 | 025040-1-73 | |
| C-1-13 | Transformer | 1 | | | C-1-35 | Control Box Side Cover Plate #5 | 1 | | |
| C-1-14 | Washer 4 | 1 | 203878-0-02 | | C-1-36 | Screw 4 x 10D | 4 | 222560-0-01 | |
| C-1-15 | Screw 4 x 10D | 4 | 215080-0-01 | | C-1-37 | Washer | 1 | 203878-0-02 | |
| C-1-16 | Screw 4 x 12 | 1 | 002401-2-63 | | C-1-38 | Screw 4 x 12 | 1 | 002401-2-63 | |
| C-1-17 | Earth Wire | 1 | 222322-0-01 | | C-1-39 | Fuse 8A | 1 | 219225-0-00 | |
| C-1-18 | Washer | 1 | 203878-0-02 | | C-1-40 | Fuse Holder | 1 | 215387-0-01 | |
| C-1-19 | Control Box #3 | 1 | 222279-0-01 | | C-1-41 | Switch | 1 | | |
| C-1-20 | Control Box Set Plate #2 | 1 | 222286-0-01 | | C-1-42 | Cap | 1 | | |
| C-1-21 | Screw 5 x 10D | 3 | 216596-0-01 | | C-2 | Bolt 8 x 70 | 1 | 222372-0-01 | |
| C-1-22 | Nut 5 | 3 | 021500-2-05 | | C-3 | Spring Washer, 2-8 | 1 | Q28080-2-43 | |
| C-1-23 | Vibration Absorbing Rubber #5 | 4 | 222331-0-01 | | C-4 | Nut 8 | 1 | 021080-1-06 | |
| C-1-24 | Vibration Absorbing Rubber #4 | 2 | 222327-0-01 | | C-5 | Screw | 3 | 133180-0-05 | |
| C-1-25 | Rubber Holder #3 | 2 | 222328-0-01 | | | | | | |

D. Magnet Direct Current Motor

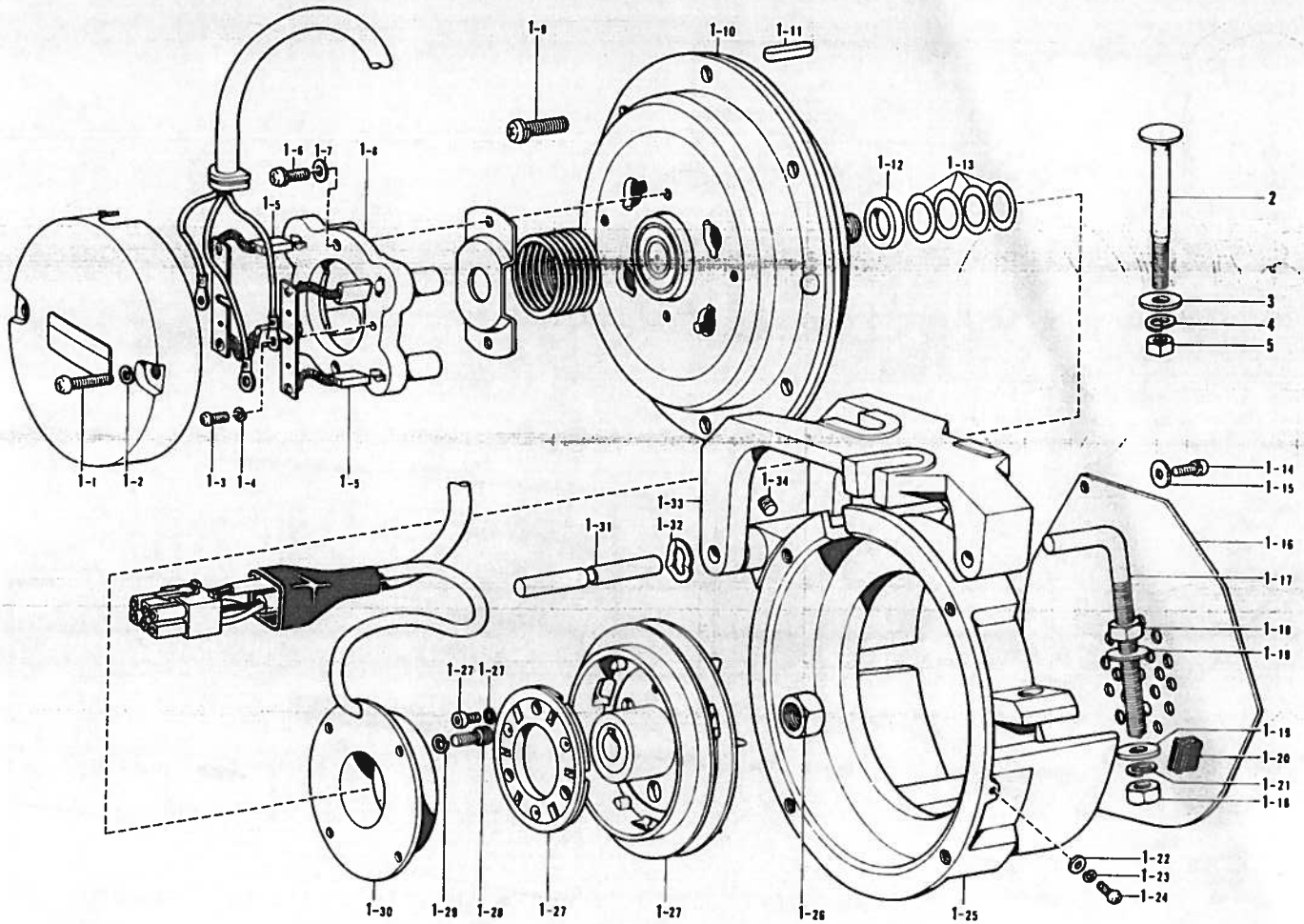

| Ref. No. | Name of Parts | Q'ty | Parts No. | Assembly No. | Ref. No. | Name of Parts | Q'ty | Parts No. | Assembly No. |
|----------|-----------------------|------|-------------|--------------------------|----------|------------------------|------|-------------|--------------------------|
| D-1- 1 | Screw 5 x 25 | 2 | 002502-5-05 | D-1 Motor Assembly | D-1-22 | Washer 4 | 1 | 025040-1-73 | D-1 Motor Assembly |
| D-1- 2 | Spring Washer M5 | 2 | 028050-2-43 | | D-1-23 | Spring Washer 2-4 | 1 | 028040-2-43 | |
| D-1- 3 | Screw 4 x 10D | 2 | 215080-0-01 | | D-1-24 | Screw 4 x 8 | 1 | 002400-8-63 | |
| D-1- 4 | Spring Washer M4 | 2 | 028040-2-43 | | D-1-25 | Bracket | 1 | 219515-0-01 | |
| D-1- 5 | Carbon Brush Assembly | 2 | 290441-0-00 | | D-1-26 | Nut | 1 | 210240-0-01 | |
| D-1- 6 | Screw 5 x 16DA | 2 | 215093-0-01 | | D-1-27 | Pulley L Assembly | 1 | | |
| D-1- 7 | Washer 5 | 2 | 025050-2-35 | | D-1-28 | Bolt 5 x 12 | 4 | 018051-2-22 | |
| D-1- 8 | T Holder | 1 | 290442-0-00 | | D-1-29 | Spring Washer 2-5 | 4 | 028050-2-43 | |
| D-1- 9 | Screw 6 x 25D | 4 | 221421-0-01 | | D-1-30 | Brake 08 Stator | 1 | 222369-0-00 | |
| D-1-10 | Motor | 1 | 222367-0-01 | | D-1-31 | Pin 10 x 79 | 1 | 215810-0-01 | |
| D-1-11 | Key 5 x 22 | 1 | 290443-0-00 | | D-1-32 | Washer 0.2 x 10.5 x 20 | 1 | 213765-0-01 | |
| D-1-12 | Collar 15 x 22 x 3ST | 1 | 219516-0-01 | | D-1-33 | Base #14 | 1 | 219525-0-01 | |
| D-1-13 | Washer 0.1 x 15 x 30 | 6 | 219517-0-01 | | D-1-34 | Screw 6 | 1 | 011060-6-13 | |
| D-1-14 | Screw 4 x 10D | 2 | 215080-0-01 | | D-2 | Bolt M8 x 85 | 2 | 210973-0-01 | |
| D-1-15 | Washer 4 | 2 | 025040-3-35 | | D-3 | Washer M8 | 2 | 025080-3-36 | |
| D-1-16 | Belt Cover #10 | 1 | 219524-0-01 | | D-4 | Spring Washer M8 | 2 | 028080-2-43 | |
| D-1-17 | L Bolt 10 | 1 | 210965-0-01 | | D-5 | Nut M8 | 2 | 021080-1-06 | |
| D-1-18 | Nut 10 | 2 | 021100-2-06 | | | | | | |
| D-1-19 | Washer | 2 | 025100-2-36 | | | | | | |
| D-1-20 | Rubber #21 | 1 | 220039-0-01 | | | | | | |
| D-1-21 | Spring Washer 2-10 | 1 | 028100-2-43 | | | | | | |

INDEX

| Parts No. | Ref. No. | Remark | Parts No. | Ref. No. | Remark | Parts No. | Ref. No. | Remark | Parts No. | Ref. No. | Remark |
|-------------|------------|--------|-------------|-------------|---------|-------------|-------------|--------|-----------|----------|--------|
| 002400-8-63 | D- 1-24 | | 218944-0-01 | B- 3 | | 222867-0-01 | D- 1 | | | | |
| 002401-2-63 | C- 1-16 | | 219126-0-01 | C- 1- 1-18 | | 223405-0-01 | C- 1-35 | | | | |
| | C- 1-38 | | | 219225-0-00 | C- 1-26 | | 223408-0-01 | A-13 | | | |
| 002502-5-05 | D- 1- 1 | | | C- 1-39 | | 223411-0-01 | C- 1-42 | | | | |
| 009711-4-12 | B- 2 | | 219515-0-01 | D- 1-25 | | 223416-0-01 | A-13 | | | | |
| 009781-4-12 | B- 5 | | 219516-0-01 | D- 1-12 | | 223419-0-01 | C- 1 | | | | |
| 011060-6-13 | D- 1-34 | | 219517-0-01 | D- 1-13 | | 290441-0-00 | D- 1- 5 | | | | |
| 014061-0-22 | C- 1- 1-17 | | 219518-0-00 | D- 1-27- 1 | | 290442-0-00 | D- 1- 8 | | | | |
| 018051-2-22 | D- 1-28 | | 219520-0-00 | D- 1-27- 2 | | 290443-0-00 | D- 1- 11 | | | | |
| 018401-0-22 | C- 1- 2 | | 219521-0-01 | D- 1-27- 3 | | | | | | | |
| 021060-3-05 | C- 1- 1- 3 | | 219522-0-01 | D- 1-27- 4 | | | | | | | |
| 021080-1-06 | C- 4 | | 219524-0-01 | D- 1-16 | | | | | | | |
| | D- 5 | | 219525-0-01 | D- 1-33 | | | | | | | |
| 021100-2-06 | D- 1-18 | | 219529-0-01 | C- 1- 1-16 | | | | | | | |
| 021400-0-05 | C- 1- 9 | | 219557-0-00 | B- 1-14 | | | | | | | |
| 021400-2-05 | C- 1-11 | | 219558-0-00 | B- 1-15 | | | | | | | |
| 021400-2-63 | C- 1-33 | | 219559-0-00 | B- 1-16 | | | | | | | |
| 021500-2-05 | C- 1-22 | | 219610-0-01 | C- 1- 8 | | | | | | | |
| 025030-1-35 | B- 1- 7 | | 219696-0-00 | B- 1- 6 | | | | | | | |
| 025030-3-35 | B- 1- 3 | | 220039-0-01 | D- 1-20 | | | | | | | |
| 025040-1-35 | B- 1-10 | | 220120-0-01 | D- 1-27 | | | | | | | |
| 025040-1-73 | C- 1-34 | | 221112-0-01 | C- 1- 6 | | | | | | | |
| | D- 1-22 | | 221421-0-01 | B- 1-17 | | | | | | | |
| 025040-3-35 | B- 1-12 | | | D- 1- 9 | | | | | | | |
| | B- 1-20 | | 222230-0-01 | A- 1 | | | | | | | |
| | C- 1- 1-11 | | 222254-0-01 | A- 3 | | | | | | | |
| | C- 1-12 | | | A- 7 | | | | | | | |
| | D- 1-15 | | | A-11 | | | | | | | |
| 025050-2-35 | D- 1- 7 | | 222255-0-01 | A- 5 | | | | | | | |
| 025080-3-36 | D- 3 | | 222279-0-01 | C- 1-19 | | | | | | | |
| 025100-2-36 | D- 1-19 | | 222286-0-01 | C- 1-20 | | | | | | | |
| 028040-2-43 | C- 1- 3 | | 222287-0-01 | C- 1- 5 | | | | | | | |
| | D- 1- 4 | | | C- 1-27 | | | | | | | |
| | D- 1-23 | | 222321-0-01 | C- 1-32 | | | | | | | |
| 028050-2-43 | D- 1- 2 | | 222322-0-01 | C- 1-17 | | | | | | | |
| | D- 1-29 | | 222327-0-01 | C- 1-24 | | | | | | | |
| 028080-2-43 | C- 3 | | 222328-0-01 | C- 1-25 | | | | | | | |
| | D- 4 | | 222329-0-01 | C- 1- 1 | | | | | | | |
| 028100-2-43 | D- 1-21 | | 222331-0-01 | C- 1-23 | | | | | | | |
| 032423-8-06 | A- 4 | | 222338-0-01 | C- 1- 1-12 | | | | | | | |
| | A- 8 | | 222339-0-01 | C- 1- 1-14 | | | | | | | |
| | A-12 | | 222340-0-01 | C- 1- 1-15 | | | | | | | |
| 048040-3-46 | C- 1-1-8 | | 222341-0-01 | C- 1- 1- 2 | | | | | | | |
| 133180-0-05 | C- 5 | | 222342-0-00 | C- 1- 1- 9 | | | | | | | |
| 203878-0-02 | C- 1-14 | | 222343-0-01 | C- 1- 1- 6 | | | | | | | |
| | C- 1-18 | | 222351-0-01 | C- 1-31 | | | | | | | |
| | C- 1-37 | | 222357-0-01 | C- 1-31 | | | | | | | |
| 210240-0-01 | D- 1-26 | | | | | | | | | | |
| 210965-0-01 | D- 1-17 | | 222366-0-01 | D- 1 | | | | | | | |
| 210973-0-01 | D- 2 | | 222367-0-01 | D- 1-10 | | | | | | | |
| 213765-0-01 | D- 1-32 | | 222369-0-00 | D- 1-30 | | | | | | | |
| 213913-0-01 | C- 1- 1- 4 | | 222370-0-01 | B- 1 | | | | | | | |
| 215080-0-01 | B- 1-11 | | 222371-0-01 | B- 1- 9 | | | | | | | |
| | B- 1-21 | | 222372-0-01 | C- 2 | | | | | | | |
| | C- 1-15 | | 222560-0-01 | C- 1- 4 | | | | | | | |
| | D- 1- 3 | | | C- 1-30 | | | | | | | |
| | D- 1-14 | | | C- 1-36 | | | | | | | |
| 215083-0-01 | B- 1- 2 | | 222566-0-01 | C- 1- 1- 7 | | | | | | | |
| | B- 1- 8 | | 222567-0-01 | C- 1- 7 | | | | | | | |
| 215087-0-01 | C- 1-10 | | 222576-0-01 | C- 1 | | | | | | | |
| 215093-0-01 | D- 1- 6 | | 222577-0-01 | C- 1 | | | | | | | |
| 215387-0-01 | C- 1-40 | | 222598-0-01 | C- 1-35 | | | | | | | |
| 215810-0-01 | D- 1-31 | | 222602-0-01 | C- 1-13 | | | | | | | |
| 216235-0-00 | C- 1- 1- 5 | | 222829-0-01 | D- 1-27 | | | | | | | |
| 216332-0-01 | B- 4 | | 222830-0-00 | D- 1-27- 1 | | | | | | | |
| 216596-0-01 | C- 1-21 | | 222840-0-01 | C- 1-35 | | | | | | | |
| 216905-0-01 | C- 1-41 | | 222841-0-01 | C- 1-31 | | | | | | | |
| 217093-0-01 | B- 1-13 | | 222859-0-01 | C- 1 | | | | | | | |
| | C- 1- 1- 1 | | 222863-0-01 | C- 1-13 | | | | | | | |
| | C- 1- 1-10 | | 222865-0-01 | A- 9 | | | | | | | |